



Service Repair Manual

Model

245 EXCAVATOR

Product: EXCAVATOR

Model: 245 EXCAVATOR 82X

Configuration: 245 EXCAVATOR 82X00001-UP (MACHINE) POWERED BY 3406 ENGINE

Disassembly and Assembly 245 EXCAVATOR VEHICLE SYSTEMS

Media Number -SEN7339-02

Publication Date -01/01/1983

Date Updated -12/10/2001

Swing And Track Motors

SMCS - 5058-16; 5058-15

Disassemble Swing And Track Motors

Tools Needed		A	B	C	D	E	F	G	H	J	K	L	M	N	O	P
5P2959	Bracket	1														
5P979	Adapter	1														
5P982	Engine Repair Stand	1														
5P2402	Protective Plate		1													
1P1858	Snap Ring Pliers			1												
5P2703	Spring Compressor				1											
1P1860	Snap Ring Pliers					1										
1P1856	Snap Ring Pliers						1									
1P459	Drive Plate							1								
9S9152	Bearing Puller Attachment							1								
5F7465	Puller							1								
5B9603	Bolt (3/8" - 16 NC x 5 in.)							2								
1P1861	Snap Ring Pliers								1							
1P510	Driver Group									1						
1P1854	Snap Ring Pliers										1					
FT1549	Fixture											1				
FT1532	Spanner Socket												1			
5P2958	Step Plate													1		1
1H3107	Puller Assembly														1	
1H3108	Leg														2	
1H3112	Bearing Cup Puller Attachment														1	
FT1531	Pin															3

start by:

- a) remove swing motor
- b) remove track motors

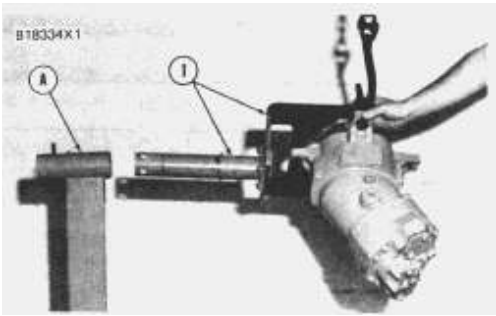

1. Fasten adapter and bracket (1), part of tooling (A), to the track motor as shown with three 3/4"-10 NC bolts 21/4 inches long. Fasten a hoist and put the track motor in position on the engine stand of tooling (A). Weight of the track motor is 210 lb. (95 kg).

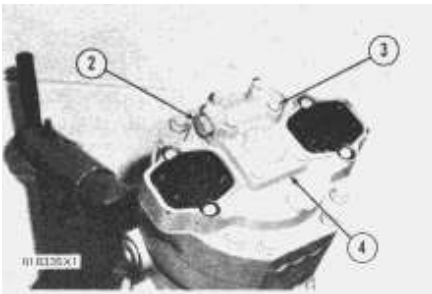

2. Loosen plugs (2) in the shuttle valve. Remove bolts (3) and shuttle valve (4) from the pump head.

NOTE: On earlier machines the shuttle valve location is on the upper body.

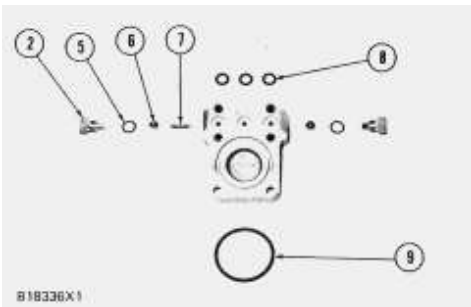

3. Remove plugs (2), O-ring seals (5), balls (6) and pin (7) from the shuttle valve. Remove O-ring seals (8) and (9) from the shuttle valve.

NOTE: On earlier machines there are stops behind plugs (2) with a ring and seal on each stop Use an 8-32 screw to pull the stops from the shuttle valve.

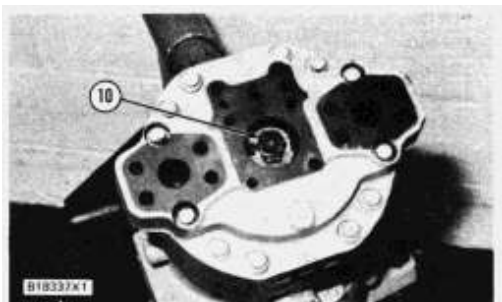

4. Bend the lock back and remove bolt (10), the lock and retainer from the shaft.

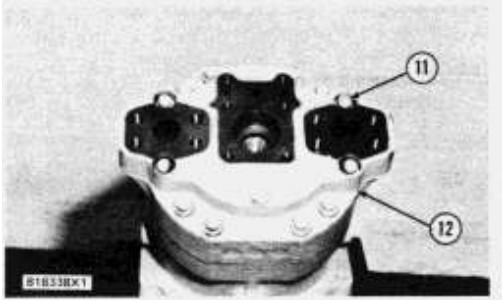

5. Put identification on the pump head as to its location on the body for correct alignment at assembly. Remove bolts (11) and pump head (12) from the body.

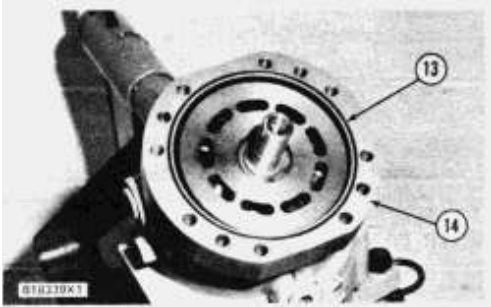

6. Remove O-ring seal (13) from body (14).

7. Put identification on body (14) as to its location on the lower body.

NOTICE

Do not let the pump barrel fall when body (14) is removed. Install protective plate (B) on the pump barrel. Keep protective plate (B) on the pump barrel at all times to prevent damage to the face of the pump barrel.

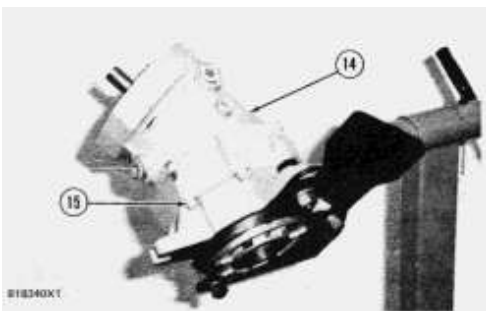

8. Remove bolts (15) and body (14) from the lower body.

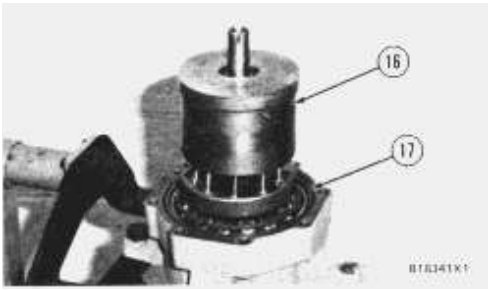

9. Remove O-ring seal (17) from the lower body.

NOTE: It is not necessary to install the barrel over the same pistons at assembly so identification on the barrel and pistons is not necessary.

10. Carefully remove barrel (16) from the pistons.

NOTE: It is necessary to remove tool (B) from the barrel to remove the snap ring and shaft (18). Install tool (B) on the barrel again as soon as shaft (18) is removed.

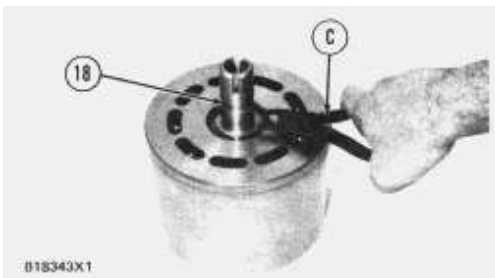

11. Use tool (C) to remove the snap ring that holds shaft (18) in place. Remove shaft (18) from the barrel.

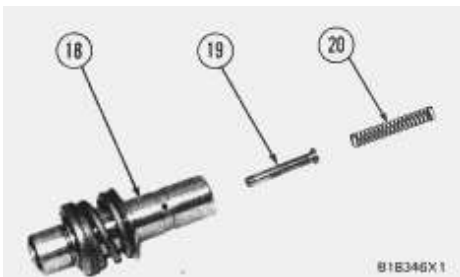

12. Remove spring (20) and tube (19) from shaft (18). Earlier motors do not have spring (20).

WARNING

The spring on shaft (18) can cause injury if all the tension in the spring is not released before tool (D) is removed. To prevent injury be sure all the tension in the spring is released before tool (D) is removed from the shaft.

Thank you so much for reading.
Please click the “Buy Now!”
button below to download the
complete manual.



After you pay.

You can download the most
perfect and complete manual in
the world immediately.

Our support email:

ebooklibonline@outlook.com