



Service Repair Manual

Models

248B SKID STEER LOADER

Product: SKID STEER LOADER

Model: 248B SKID STEER LOADER SCL

Configuration: 248B 268B SKID STEER LOADER SCL00001-UP (MACHINE) POWERED BY 3044C Engine

Disassembly and Assembly

3044C Industrial Engine and Engines for Caterpillar Built Machines

Media Number -REN7582-07

Publication Date -01/01/2010

Date Updated -26/02/2010

i02000605

Inlet and Exhaust Valve Springs - Remove and Install

SMCS - 1108-010

Removal Procedure

Table 1

Required Tools			
Tool	Part Number	Part Description	Qty
A	9U-6145	Air Connector ⁽¹⁾	1
B	-	Rod (M12 X 1.75 by 380 mm)	1
	9U-6144	Adapter As	1
	6V-8149	Nut	1
	5P-8245	Hard Washer	13
C	4C-8134	Seal Remover	1
	1U-7600	Slide Hammer Puller Gp	1
D	8S-2263	Spring Tester	1

⁽¹⁾ The 9U-6145 Air Connector is part of the 9U-6274 Compression Test Tool Gp. The 9U-6145 Air Connector can be ordered separately.

Start By:

- A. Remove the rocker shaft assembly. Refer to Disassembly and Assembly, "Rocker Shaft and Pushrod - Remove".
 - B. Remove the fuel injection nozzles. Refer to Disassembly and Assembly, "Fuel Injection Nozzles - Remove".
-

NOTICE

Keep all parts clean from contaminants.

Contaminants may cause rapid wear and shortened component life.

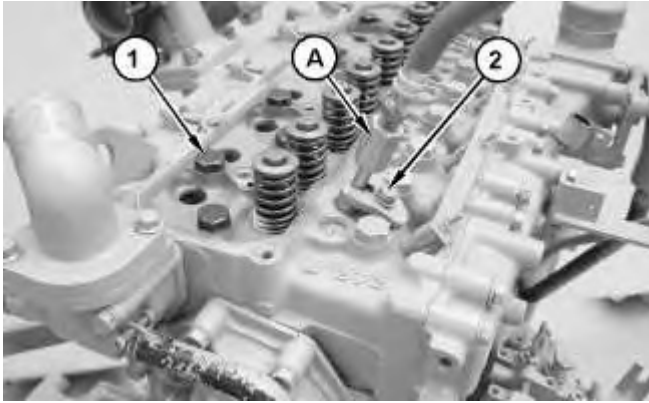

Illustration 1

g01035126

1. Install Tooling (A). Install the bolt and bracket (2). Remove bolt (1) .

Note: Maintain air pressure in the cylinder that is being serviced until both of the valve springs are removed and installed.

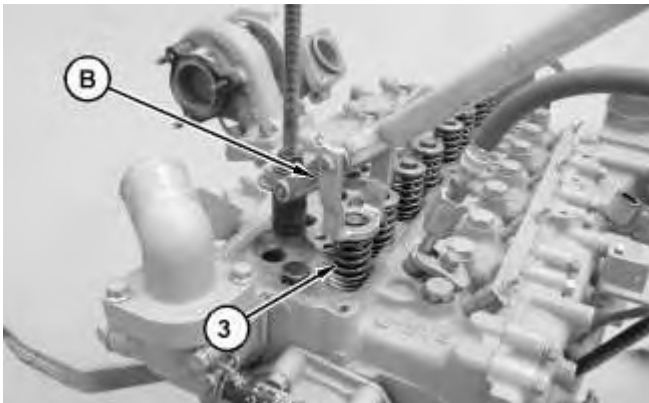

Illustration 2

g01035165

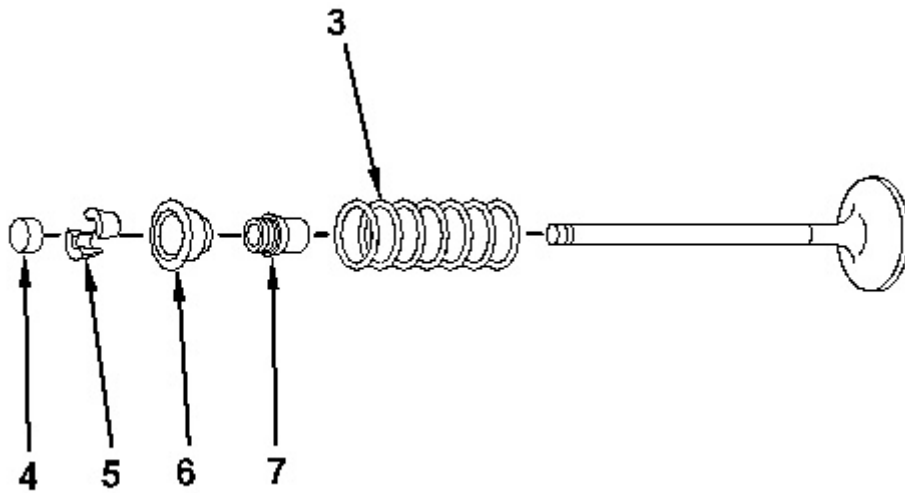

Illustration 3

g01035176

WARNING

Personal injury can result from being struck by parts propelled by a released spring force.

Make sure to wear all necessary protective equipment.

Follow the recommended procedure and use all recommended tooling to release the spring force.

NOTICE

Ensure that the valve spring is compressed squarely or damage to the valve stem may occur.

2. Install Tooling (B). Use Tooling (B) to compress valve spring (3). Remove cap (4) and retainers (5) .
3. Release the pressure from Tooling (B) and remove Tooling (B). Remove retainer (6) .
4. If necessary, use Tooling (C) to remove seal (7) .
5. Use Tooling (D) to check the valve spring force. Refer to Specifications, "Cylinder Head Valves".
6. Repeat Steps 1 through 5 for the removal of the remaining valve springs.

NOTICE

Do not turn the crankshaft while the valve springs are removed.

Installation Procedure

Table 2

Required Tools			
Tool	Part Number	Part Description	Qty
A	9U-6145	Air Connector ⁽¹⁾	1
B	-	Rod (M12 X 1.75 by 380 mm)	1
	9U-6144	Adapter As	1
	6V-8149	Nut	1
	5P-8245	Hard Washer	13
C	4C-6373	Seal Installer	1

⁽¹⁾ The **9U-6145** Air Connector is part of the **9U-6274** Compression Test Tool Gp. The **9U-6145** Air Connector can be ordered separately.

NOTICE

Keep all parts clean from contaminants.

Contaminants may cause rapid wear and shortened component life.

1. Keep Tooling (B) and an air hose attached in order to force air pressure into the cylinder. This will hold the valves in position while the inlet and exhaust valve springs are installed.

Note: Maintain air pressure in the cylinder that is being serviced until both of the valve springs are installed.

Thank you so much for reading.
Please click the “Buy Now!”
button below to download the
complete manual.



After you pay.

You can download the most
perfect and complete manual in
the world immediately.

Our support email:

ebooklibonline@outlook.com