



# Service Repair Manual

## **Models**

# 252B Skid Steer Loader

---

Product: SKID STEER LOADER

Model: 252B SKID STEER LOADER SCP

Configuration: 252B2 Skid Steer Loader SCP04600-UP (MACHINE) POWERED BY 3044C Engine

## Disassembly and Assembly

### C3.4 Engines for Caterpillar Built Machines

Media Number -KENR6941-04

Publication Date -01/03/2012

Date Updated -01/03/2012

i02719942

# Fuel Injection Pump - Remove - Fuel Injection Pumps With a Water Heated Cold Start Device

SMCS - 1251-011

## Removal Procedure

Table 1

Required Tools			
Tool	Part Number	Part Description	Qty
A	1P-2320	Combination Puller	1

### Start By:

- A. Remove the fuel injection lines. Refer to Disassembly and Assembly, "Fuel Injection Lines - Remove and Install".

---

### NOTICE

Care must be taken to ensure that fluids are contained during performance of inspection, maintenance, testing, adjusting and repair of the product. Be prepared to collect the fluid with suitable containers before opening any compartment or disassembling any component containing fluids.

Dispose of all fluids according to local regulations and mandates.

---

### NOTICE

**Keep all parts clean from contaminants.**

**Contaminants may cause rapid wear and shortened component life.**

---

1. Drain the coolant from the cooling system into a suitable container for storage or disposal. Refer to Operation and Maintenance Manual, "Cooling System Coolant - Change" for more information.

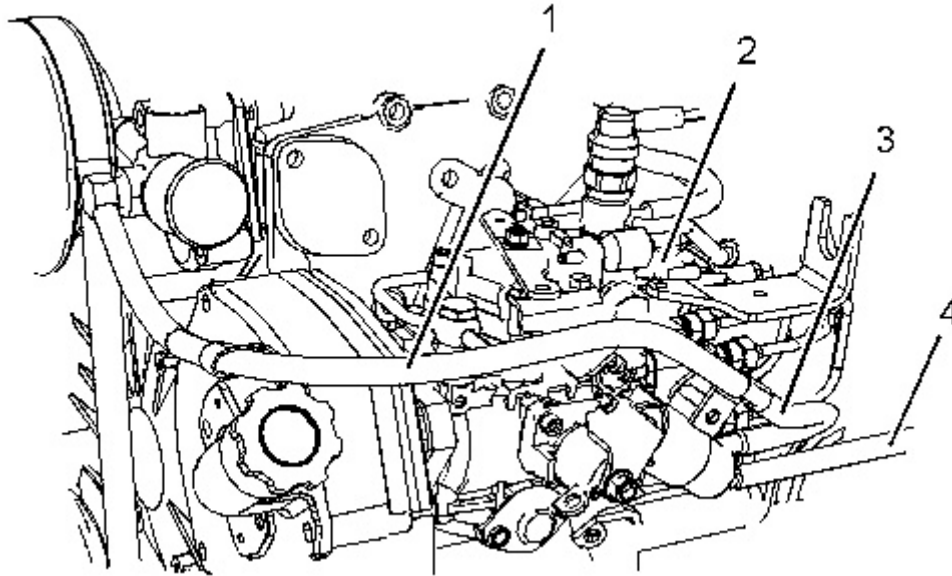
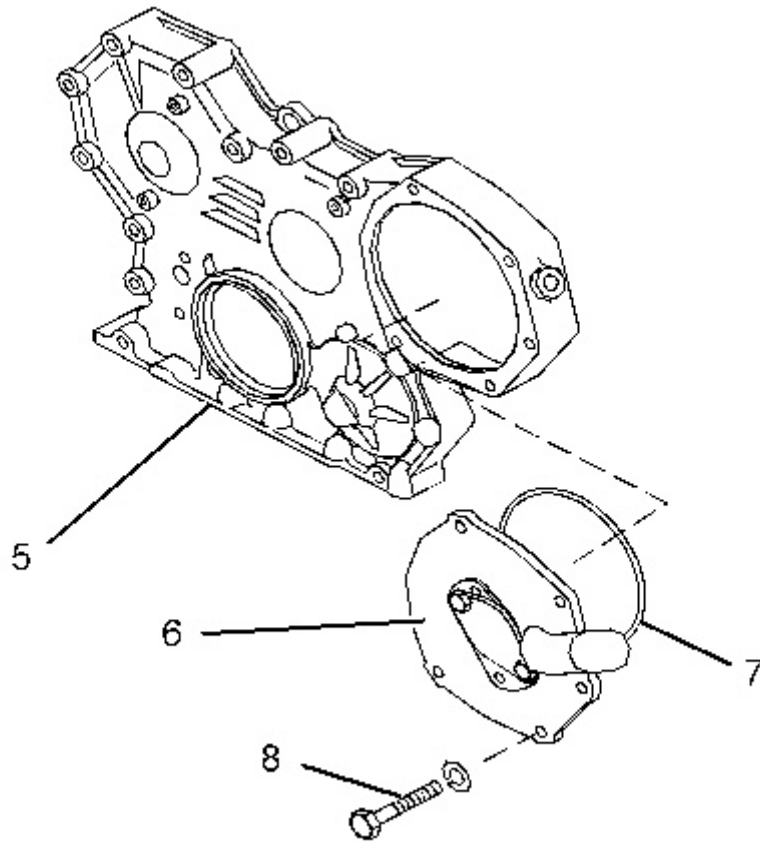

Illustration 1

g01366198

Typical example

2. Loosen the hose clamps and disconnect hoses (1) and (4) from fuel injection pump (2) .
  3. Loosen the hose clamps and remove hose (3) from fuel injection pump (2) .
  4. Ensure that number one piston is at the top center position on the compression stroke. Refer to Systems Operation, Testing and Adjusting, "Finding Top Center Position for No. 1 Piston".
-



---

Illustration 2

g01366190

Typical example

5. Remove bolts (8) .
  6. Remove plate (6) from front housing (5) .
  7. Remove O-ring seal (7) from plate (6) .
-

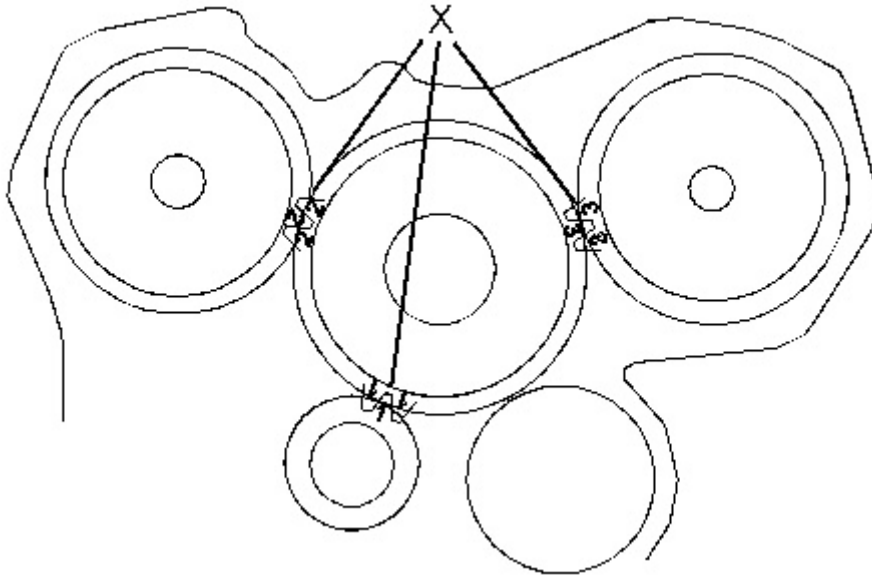
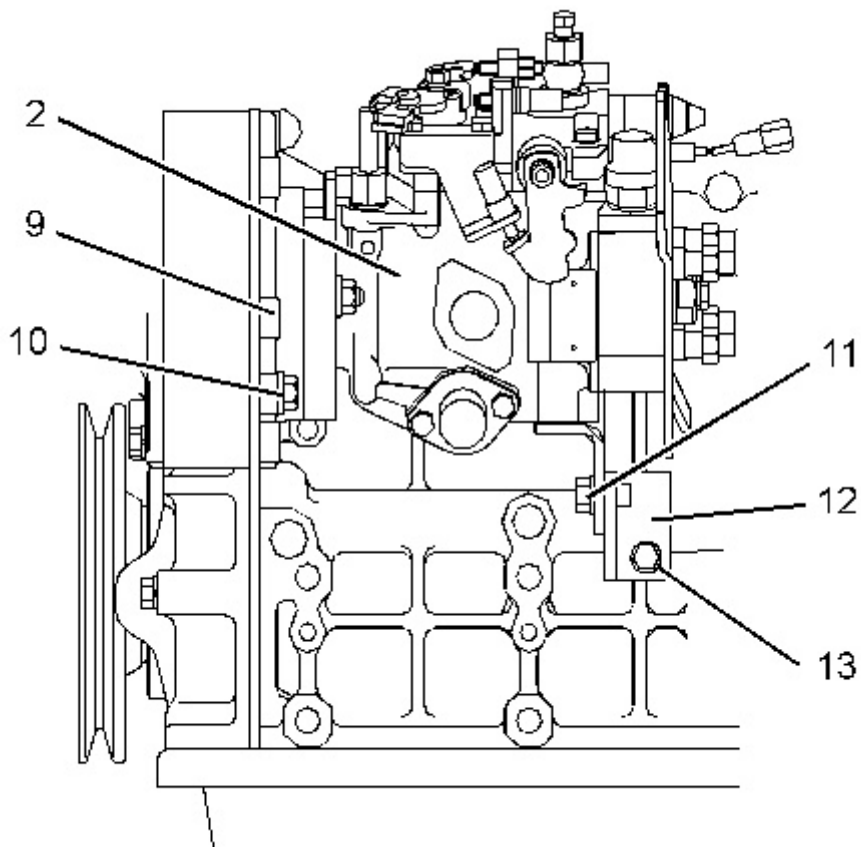

Illustration 3

g01375914

Timing marks on the gears

8. Ensure that Timing marks (X) on the teeth of the gears are aligned or make temporary marks on the gears for installation purposes.



Thank you so much for reading.  
Please click the “Buy Now!”  
button below to download the  
complete manual.



After you pay.

You can download the most  
perfect and complete manual in  
the world immediately.

Our support email:

[ebooklibonline@outlook.com](mailto:ebooklibonline@outlook.com)