



Service Repair Manual

Models

262D Skid Steer Loader

Product: SKID STEER LOADER

Model: 262D SKID STEER LOADER LST

Configuration: 262D Skid Steer Loader LST00001-UP (MACHINE) POWERED BY C3.3B Engine

Disassembly and Assembly

C2.6 and C3.3B Engines for Caterpillar Built Machines

Media Number -UENR0137-11

Publication Date -01/08/2015

Date Updated -12/07/2018

i05242445

Fuel Injection Pump and Governor - Assemble

SMCS - 1286-016

Assembly Procedure

Table 1

Required Tools			
Tool	Part Number	Part Description	Qty
A	390-1150	Injection Pump Gear Puller	1
	154-6360	Bolt	1
B	8H-0663	Bearing Puller	1

Note: Refer to Specification UENR0995 "Engine Design" for non-specified engine Torque Values.

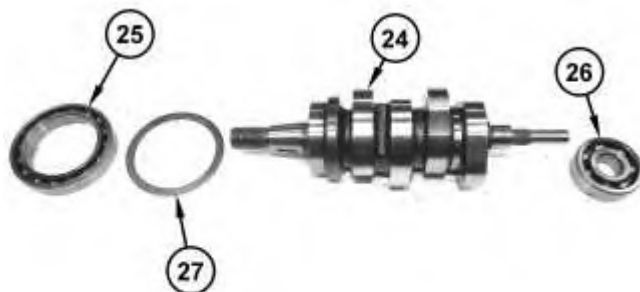

Illustration 1

g02805765

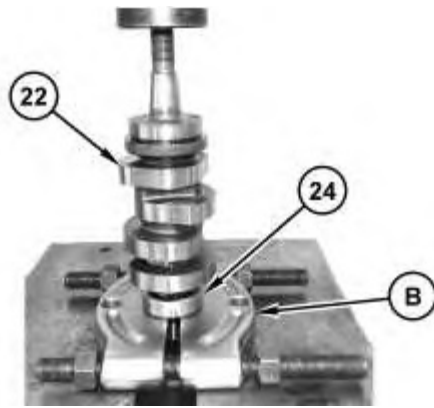

Illustration 2

g02807019

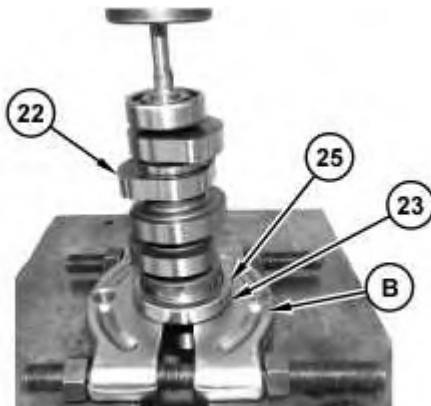

Illustration 3

g02807020

1. Use Tooling (B) and a suitable press to install bearings (26) onto fuel camshaft (24).
2. Position ring (27). Use Tooling (B) and a suitable press to install bearings (25) onto fuel camshaft (24).

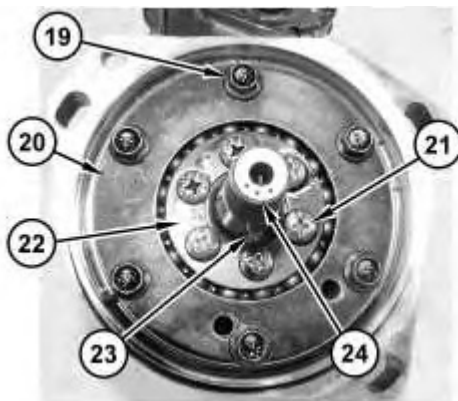

Illustration 4

g02805716

3. If necessary, replace key (23) with new. Position retaining plate (22) and install screws (21). Tighten screws (21) to a torque of 3.9 to 4.2 N·m (34.5 to 37.4 lb in).

4. Position fuel camshaft (24) in the housing assembly.
5. Position retaining plate (20) and install bolts (19). Tighten bolts (19) to a torque of 10 to 11 N·m (87 to 100 lb in).



Illustration 5

g02805660

6. Install gear (18).
7. Install nut (17) to gear (18).
8. For the C3.3B Tighten nut (17) to a torque of 138 to 156 N·m (102 to 115 lb ft).
9. For the C2.6 Tighten nut (17) to a torque of 93 to 102 N·m (69 to 75 lb ft).

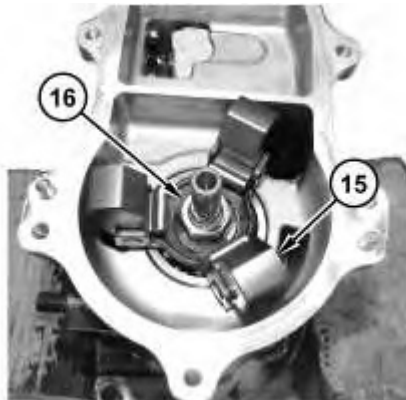

Illustration 6

g02805658

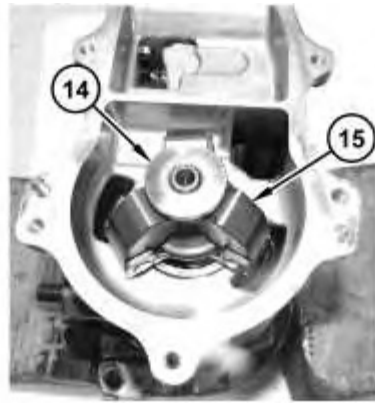

Illustration 7

g02805656

10. Position governor weights (15) and install nut (16). Tighten nut (16) to a torque of 63 to 72 N·m (47 to 53 lb ft). Install governor sleeve (14).

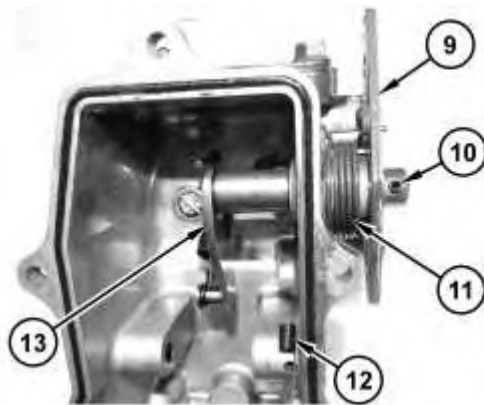
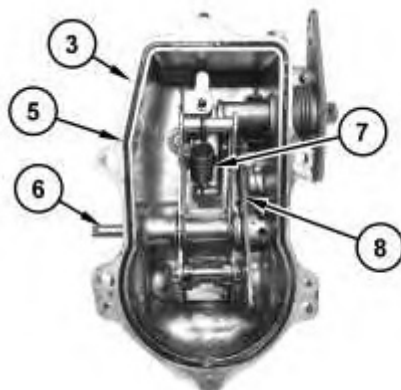

Illustration 8

g02805641

Note: Apply engine oil to all internal parts of governor.

11. Install O-ring seals on governor lever assembly (13). Position governor lever assembly (13) into the governor housing and install spring (12).
12. Install spring (11) and speed control lever (9) on governor lever assembly (13).
13. Install pin (10) into governor lever assembly (13).



Thank you so much for reading.
Please click the “Buy Now!”
button below to download the
complete manual.



After you pay.

You can download the most
perfect and complete manual in
the world immediately.

Our support email:

ebooklibonline@outlook.com