



# Service Repair Manual

## **Models**

# 287D MULTI TERRAIN LOADER

---

Product: MULTI TERRAIN LOADER

Model: 287D MULTI TERRAIN LOADER HMT

Configuration: 287D Multi Terrain Loader HMT00001-UP (MACHINE) POWERED BY C3.3B Engine

## Disassembly and Assembly

### C3.3B Tier 4 Final and EU Stage 3B Engines for Caterpillar Built Machines

Media Number -UENR3278-07

Publication Date -01/09/2014

Date Updated -11/07/2016

i06020083

## Fuel Injection Pump - Remove and Install

SMCS - 1251-010

### Removal Procedure

Table 1

Required Tools			
Tool	Part Number	Part Description	Qty
A	278-4138	Fuel System Protection Gp <sup>(1)</sup>	1

<sup>(1)</sup> This tool can only be used one time.



**Do not open the high pressure fuel system without allowing the fuel system to purge. After the engine has shut down, allow the fuel system to purge for ten minutes. This operating fuel system contains high pressure. Exposure to high pressure fuel can result in personal injury.**

**Note:** Use Caterpillar Electronic Technician (ET) to verify that the fuel system pressure is at zero before opening the fuel system.

**Note:** Use Tooling (A) after any fuel line has been disconnected.

1. Ensure that number four piston is at the top center position on the compression stroke. Refer to Systems Operation, Testing and Adjusting, "Finding Top Center Position for No. 4 Piston".



Illustration 1

g03337739

2. Mark the alignment of the pump gear and the idler gear for installation purposes.

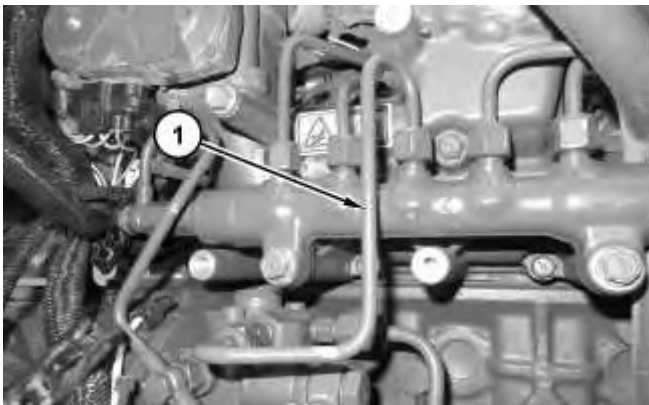

Illustration 2

g03337770

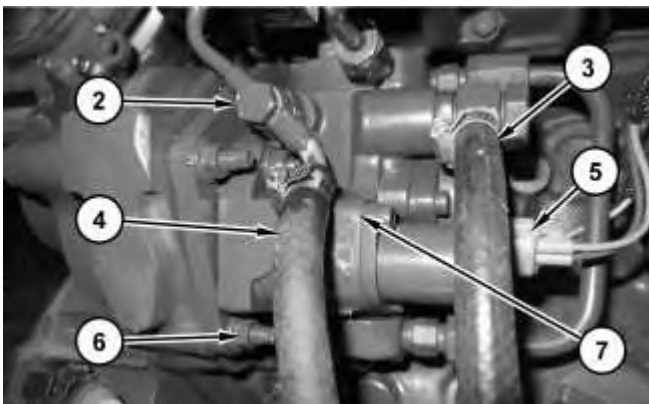

Illustration 3

g03337758

3. Remove tube assembly (1) . Remove banjo bolt (2) to disconnect hose assembly (4) . Disconnect hose assembly (3) and harness assemblies (5) . Remove nuts (6) to remove fuel injection pump (7) .

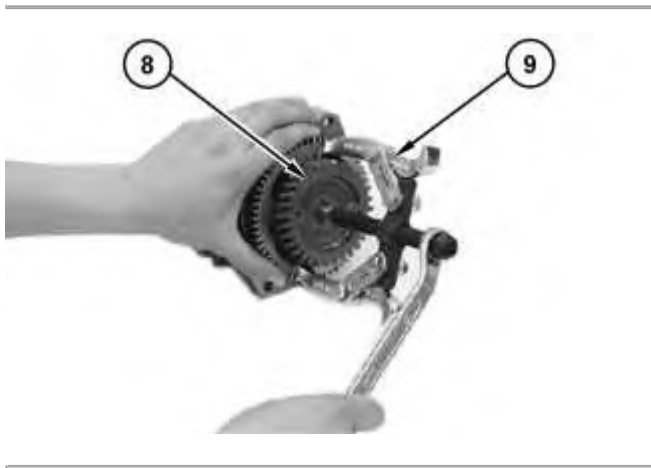

Illustration 4

g03338716

4. Remove gear mounting nut. Remove gear (8) with a suitable gear puller (9) . Remove gear (8) from fuel injection pump (7)

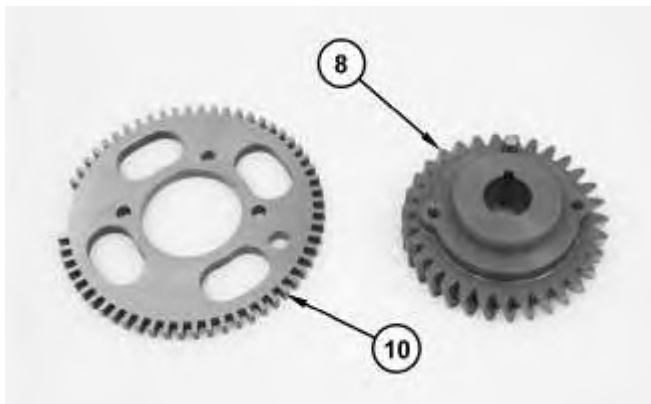

Illustration 5

g03366472

5. Remove the two bolts (not shown) to separate gear (10) from gear (8) .

## Installation Procedure

---



Illustration 6

g03366484

1. Align gear (10) to gear (8) with pin (11) and the two bolts (not shown). Tighten the two bolts (not shown) to a torque of 10 to 11 N·m (89 to 97 lb in).

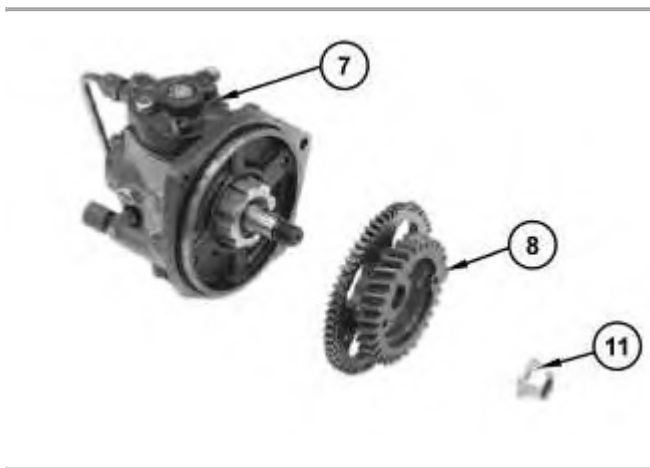

Illustration 7

g03366496

2. Install gear (8) and nut (11) on fuel injection pump (7). Tighten nut (11) to a torque of  $63.5 \pm 4.5$  N·m ( $47 \pm 3$  lb ft).

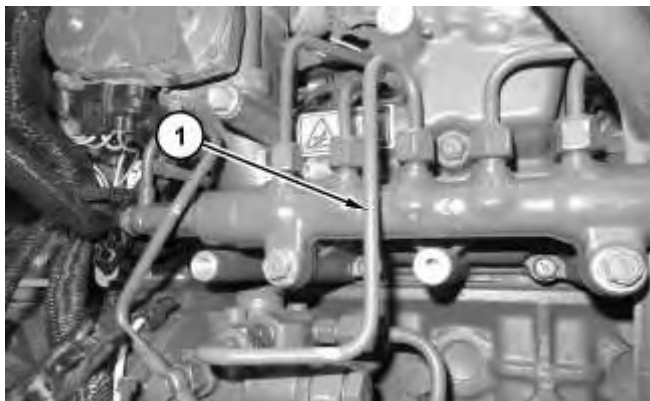

Illustration 8

g03337770

Thank you so much for reading.  
Please click the “Buy Now!”  
button below to download the  
complete manual.



After you pay.

You can download the most  
perfect and complete manual in  
the world immediately.

Our support email:

[ebooklibonline@outlook.com](mailto:ebooklibonline@outlook.com)