



Service Repair Manual

Models

289D COMPACT TRACK LOADER

Product: COMPACT TRACK LOADER

Model: 289D COMPACT TRACK LOADER WCT

Configuration: 289D Compact Track Loader WCT00001-UP (MACHINE) POWERED BY C3.3B Engine

Disassembly and Assembly

259D, 279D, 289D, 299D and 299D XHP Compact Track Loaders, 257D, 277D, 287D, 297D and 297D XHP Multi Terrain Loaders and 236D, 242D, 246D, 262D, 272D and 272D XHP Skid Steer Loaders Power Train

Media Number -UENR3730-09

Publication Date -01/05/2015

Date Updated -13/08/2018

i06660138

Piston Pump (Hydrostatic) - Assemble

SMCS - 5070-016-H7

Assembly Procedure

Table 1

Required Tools			
Tool	Part Number	Part Description	Qty
D	1P-1859	Retaining Ring Pliers	1
E	9S-3263	Thread Lock Compound	1

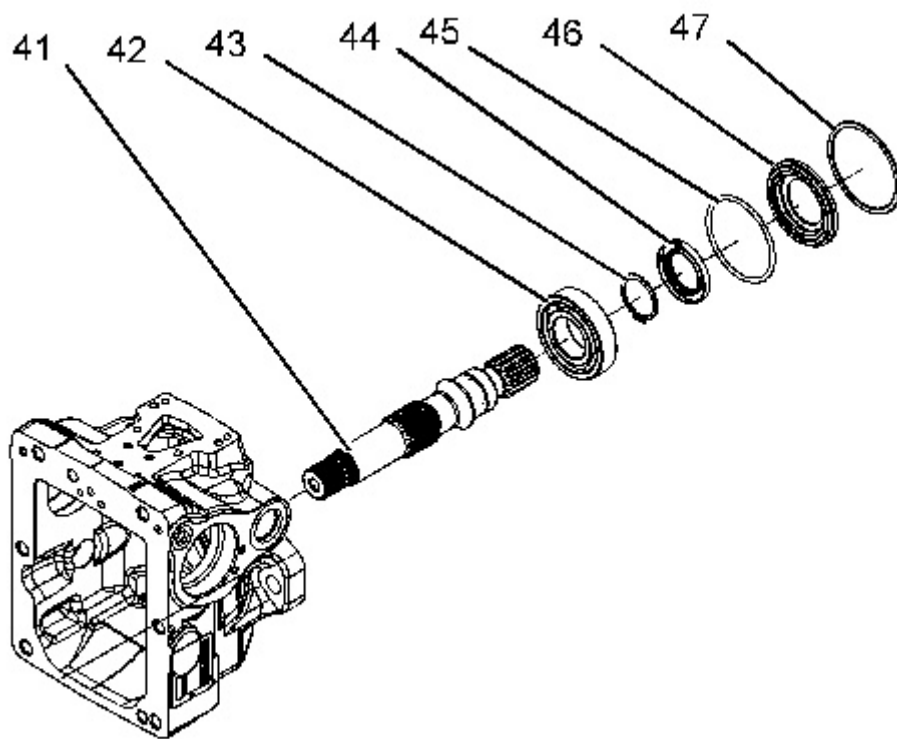
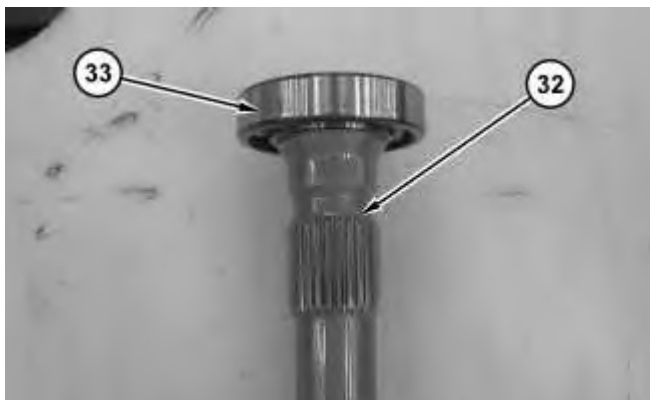

Illustration 1

g06063261

1. Raise the temperature of bearing (42).
2. Install bearing (42).
3. Use Tooling (D) to install retaining ring (43).
4. Install shaft assembly (40) and seal (44).
5. Install O-ring seal (45).
6. Install plate (46).
7. Install retaining ring (47).



8. Raise the temperature of bearing (33).
9. Install bearing (33) onto shaft (32).

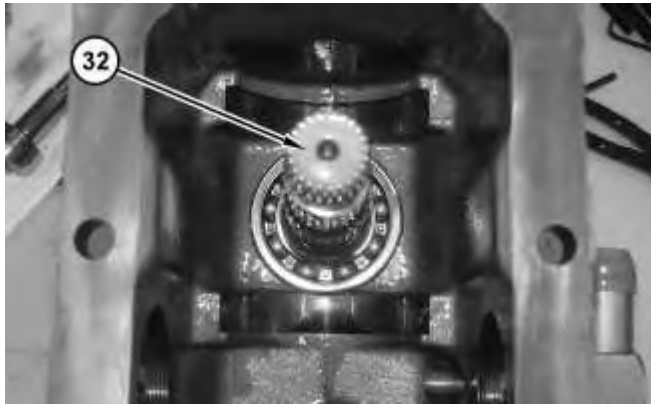

Illustration 3

10. Install shaft (32).



Illustration 4

11. Install bearings (31) onto swashplate (28).

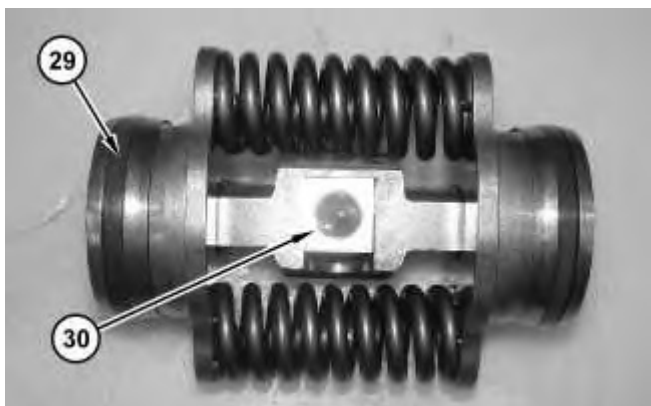

12. Install seals (29) and block (30).

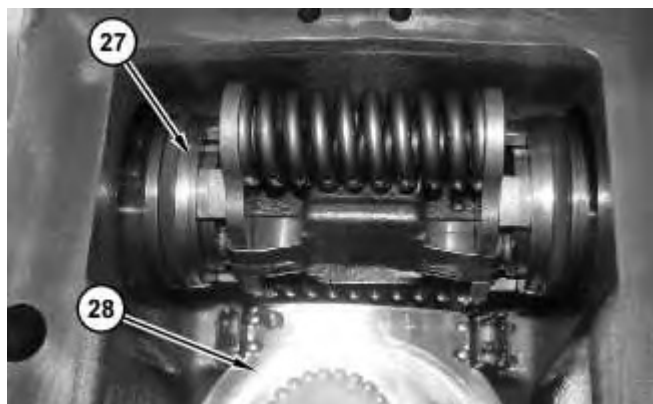

Illustration 6

13. Install piston assembly (27) and swashplate (28).



Illustration 7

14. Install O-ring seal (26).

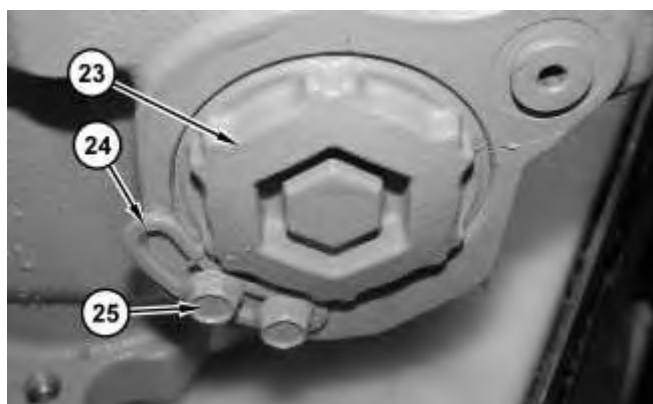

Illustration 8

Thank you so much for reading.
Please click the “Buy Now!”
button below to download the
complete manual.



After you pay.

You can download the most
perfect and complete manual in
the world immediately.

Our support email:

ebooklibonline@outlook.com