



Service Repair Manual

Models

301.6C and 301.8C

Mini Hydraulic Excavator

Product: MINI HYD EXCAVATOR

Model: 301.6C MINI HYD EXCAVATOR JBB

Configuration: 301.6C & 301.8C Mini Hydraulic Excavators JBB00001-UP (MACHINE) POWERED BY L3E Engine

Disassembly and Assembly 301.6C and 301.8C Mini Hydraulic Excavators Machine Systems

Media Number -REN9157-01

Publication Date -01/11/2005

Date Updated -06/12/2005

i02365060

Recoil Spring - Remove and Install

SMCS - 4158-010

Removal Procedure

Table 1

Required Tools			
Tool	Part Number	Part Description	Qty
A	6H-1627	Spacer	1

Start By:

- A. Remove the track adjuster. Refer to Disassembly and Assembly, "Hydraulic Track Adjuster - Remove and Install".

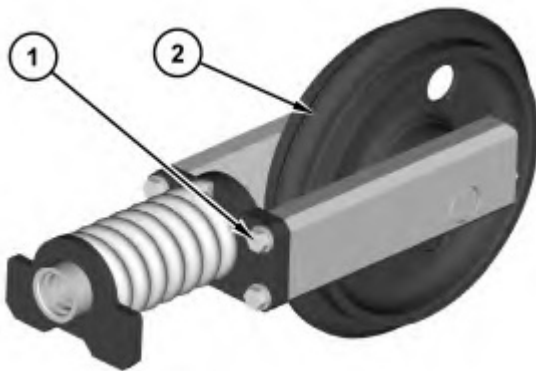

1. Remove bolts (1) and idler assembly (2) .

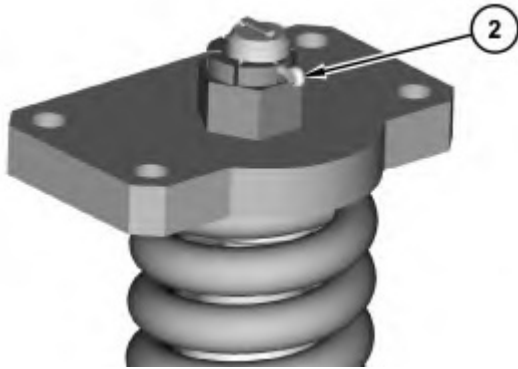

Illustration 2

g01183510

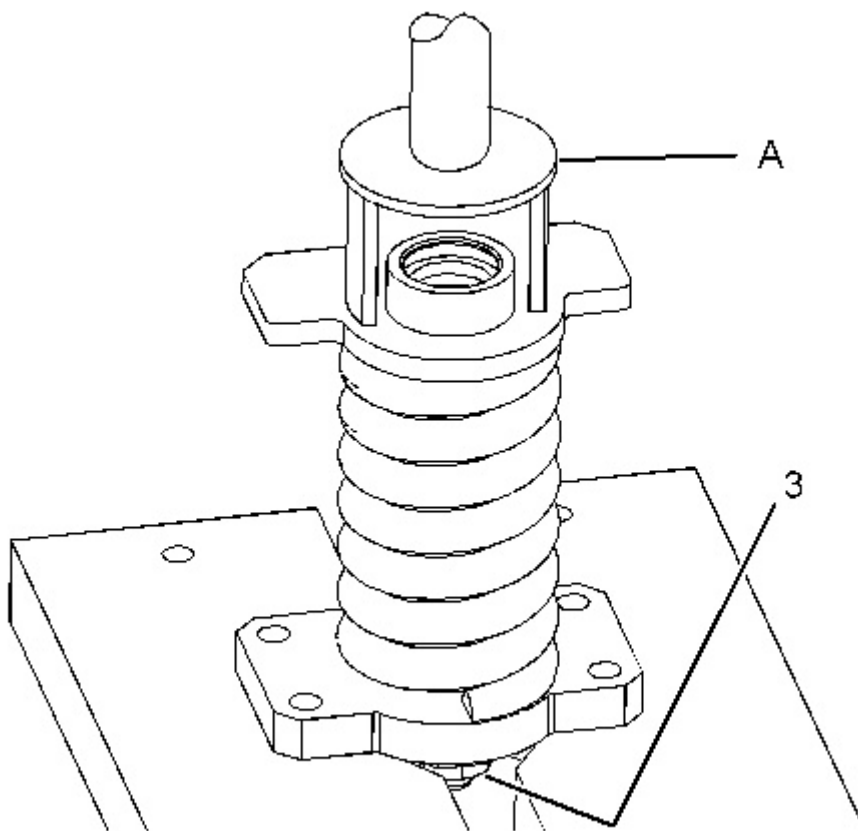

Illustration 3

g01181247

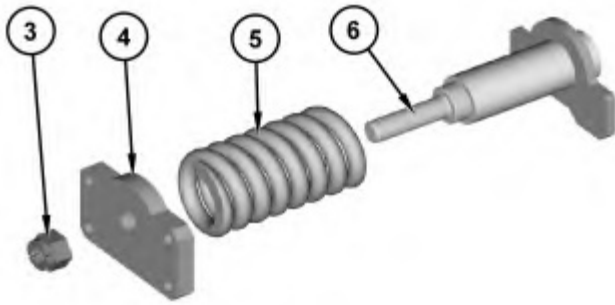

Illustration 4

g01181248

! WARNING

Personal injury can result from being struck by parts propelled by a released spring force.

Make sure to wear all necessary protective equipment.

Follow the recommended procedure and use all recommended tooling to release the spring force.

2. Remove cotter pin (2). Use Tooling (A) and a suitable press in order to compress recoil spring (5). Loosen nut (3) .
3. Slowly release the spring tension. Remove nut (3), plate (4), and recoil spring (5) from cylinder assembly (6) .

Installation Procedure

Table 2

Required Tools			
Tool	Part Number	Part Description	Qty
A	6H-1627	Spacer	1
B	9S-3263	Thread Lock Compound	1

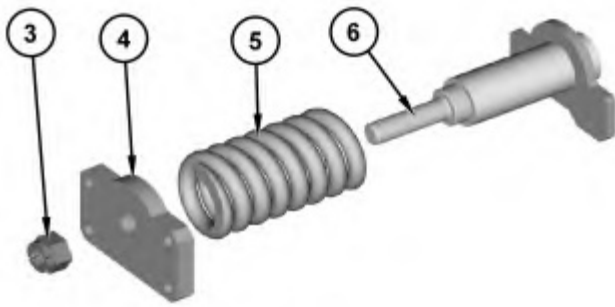

Illustration 5

g01181248

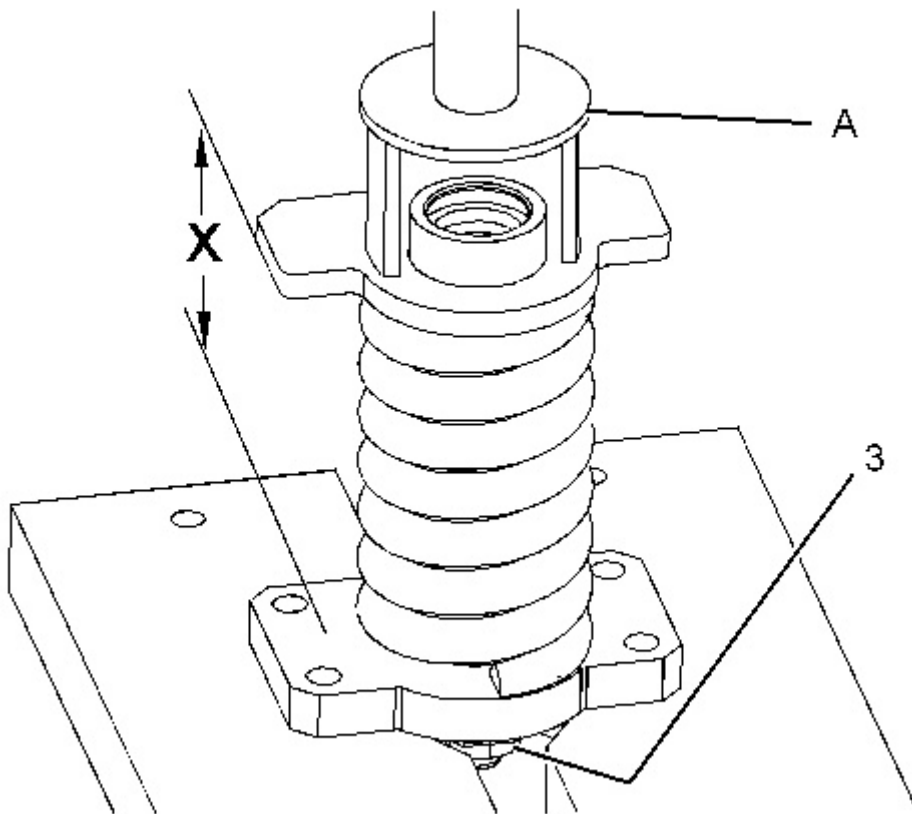

Illustration 6

g01181281

(X) 138.00 ± 1.50 mm (5.430 ± 0.060 inch)

Thank you so much for reading.
Please click the “Buy Now!”
button below to download the
complete manual.



After you pay.

You can download the most
perfect and complete manual in
the world immediately.

Our support email:

ebooklibonline@outlook.com