



Service Repair Manual

Models

303.5E CR Mini Hydraulic
Excavator

Product: MINI HYD EXCAVATOR

Model: 303.5E MINI HYD EXCAVATOR JX2

Configuration: 303.5E CR Mini Hydraulic Excavator JX200001-UP (MACHINE) POWERED BY C1.8 Engine

Disassembly and Assembly 303E CR, 303.5E, 304E, 305.5E and 305E Mini Hydraulic Excavators Machine Systems

Media Number -UENR0148-04

Publication Date -01/10/2016

Date Updated -25/10/2016

i04778181

Main Hydraulic Pump - Assemble

SMCS - 5070-016

Assembly Procedure

Table 1

Required Tools			
Tool	Part Number	Part Description	Qty
A	1P-0510	Driver Gp	1
B	1P-1858	Retaining Ring Pliers	1

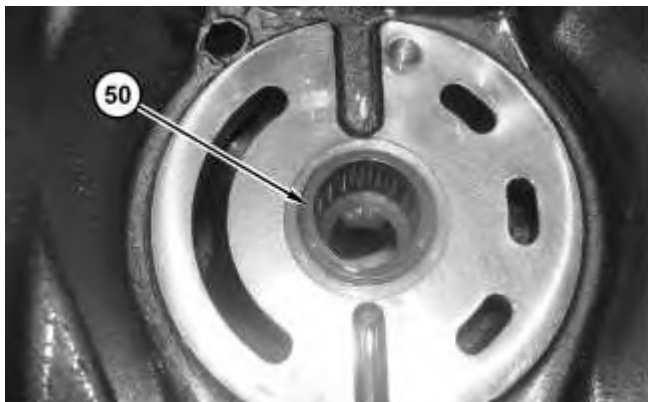

Illustration 1

g01222569

1. Install bearing (50).

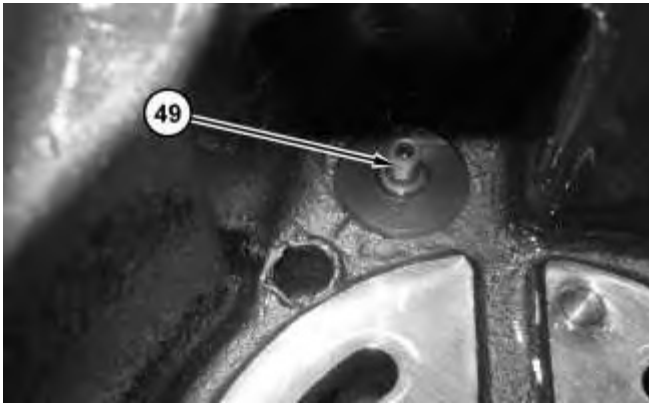

Illustration 2

g01222568

2. Install spool (49).



Illustration 3

g01222567

3. Install retainer (48).

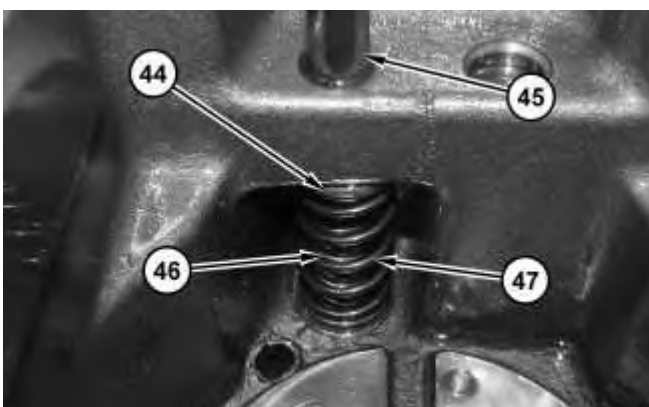

Illustration 4

g01222565

 **WARNING**

Improper assembly of parts that are spring loaded can cause bodily injury.

To prevent possible injury, follow the established assembly procedure and wear protective equipment.

4. Install retainer (44), spring (47), spring (46), and pin (45).

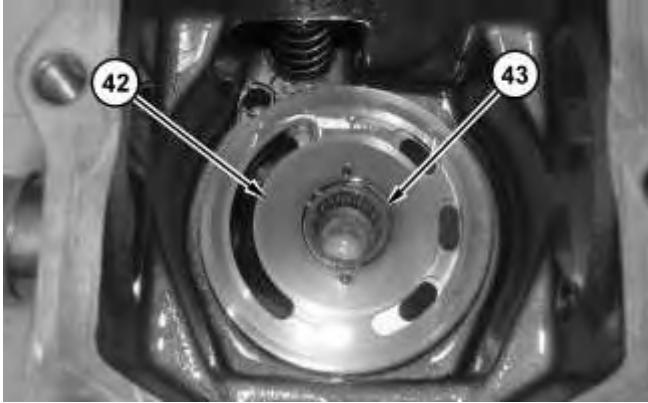

Illustration 5

g01222563

5. Install port plate (42) and shim (43).

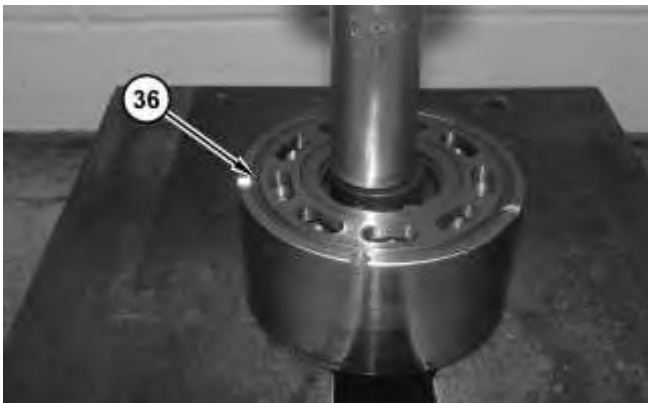

Illustration 6

g01222560

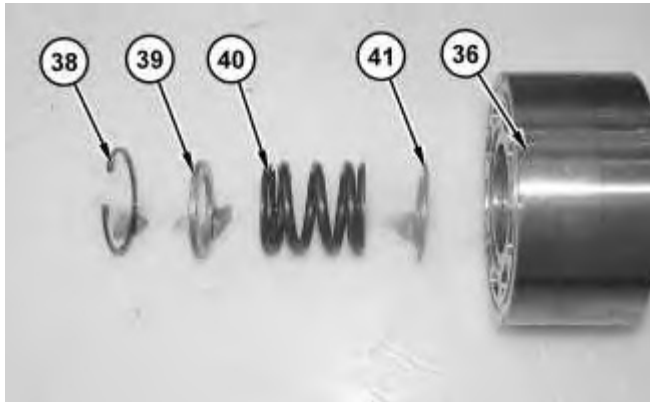

Illustration 7

g01222562

! WARNING

Improper assembly of parts that are spring loaded can cause bodily injury.

To prevent possible injury, follow the established assembly procedure and wear protective equipment.

6. Install washer (41), spring (40), and washer (39) into barrel (36).
7. Use Tooling (A) and Tooling (B) in order to install retaining ring (38).

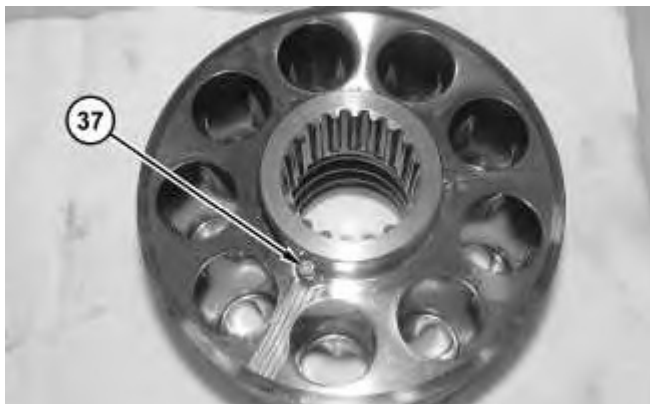

Illustration 8

g01222491

8. Install pins (37).

Thank you so much for reading.
Please click the “Buy Now!”
button below to download the
complete manual.



After you pay.

You can download the most
perfect and complete manual in
the world immediately.

Our support email:

ebooklibonline@outlook.com