



# Service Repair Manual

## **Models**

**320, 320L TRACK-TYPE  
EXCAVATOR**

---

Product: EXCAVATOR

Model: 320 L EXCAVATOR 9KK

Configuration: 320, 320L TRACK-TYPE EXCAVATORS 9KK00001-01358 (MACHINE) POWERED BY 3066 ENGINE

## Disassembly and Assembly 3064 and 3066 Engines for Caterpillar Built Machines

Media Number -SEN5553-10

Publication Date -01/05/2012

Date Updated -15/05/2012

i01615533

### Rocker Shaft - Assemble

SMCS - 1102-016

### Assembly Procedure

Table 1

Required Tools			
Tool	Part Number	Part Description	Qty
A	1P-0510	Driver Group	1

---

#### NOTICE

**Keep all parts clean from contaminants.**

**Contaminants may cause rapid wear and shortened component life.**

---

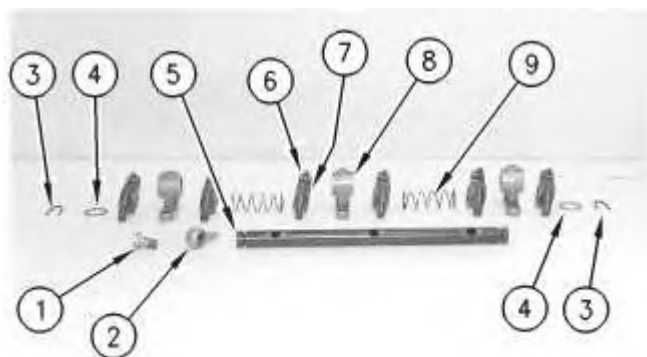

---

Illustration 1

g00609491



---

Illustration 2

g00609490

1. Use Tool (A) to install bushing (7) into rocker arm (6), if the bushing was removed.  
Refer to Specifications, "Rocker Shaft" for more information.

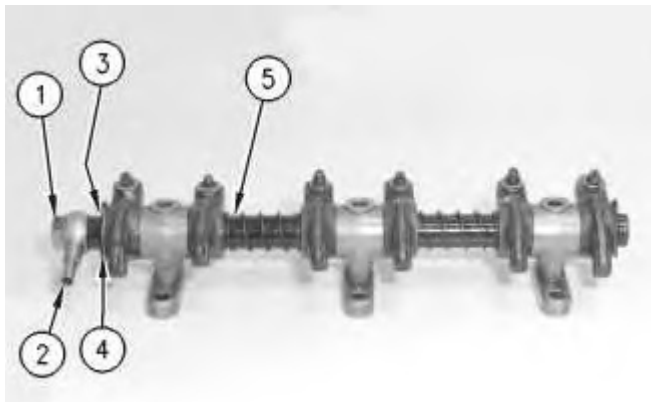

---

Illustration 3

g00609488

2. Install spacer (4) and clip (3) onto one end of shaft assembly (5) .
3. Slide components onto shaft (5) in the correct order. Refer to Illustration 1 in order to install the components correctly.
4. The shaft assembly includes the following components:
  - Bolt (1)
  - Oil tube (2)
  - Clip (3)

- Spacer (4)
- Shaft assembly (5)
- Rocker arm (6)
- Bushing (7)
- Rocker shaft bracket (8)
- Spring (9)

5. Install spacer (4) and clip (3) onto the other end of shaft assembly (5) .

6. Install bolt (1) and oil supply tube (2) into the end of shaft assembly (5) .

**End By:** Install the rocker shaft and pushrods. Refer to Disassembly and Assembly, "Rocker Shaft and Pushrod - Install".

Product: EXCAVATOR

Model: 320 L EXCAVATOR 9KK

Configuration: 320, 320L TRACK-TYPE EXCAVATORS 9KK00001-01358 (MACHINE) POWERED BY 3066 ENGINE

## Disassembly and Assembly 3064 and 3066 Engines for Caterpillar Built Machines

Media Number -SEN5553-10

Publication Date -01/05/2012

Date Updated -15/05/2012

i01576835

## Rocker Shaft and Pushrod - Install

SMCS - 1102-012; 1208-012

### Installation Procedure

---

#### NOTICE

**Keep all parts clean from contaminants.**

**Contaminants may cause rapid wear and shortened component life.**

---

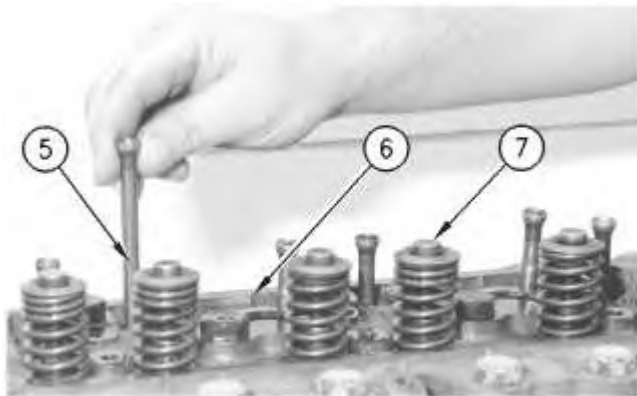

Illustration 1

g00609287

1. Install valve caps (7) on the end of the valve stem.
2. Install pushrods (5) in the cylinder head assembly (6) .

Thank you so much for reading.  
Please click the “Buy Now!”  
button below to download the  
complete manual.



After you pay.

You can download the most  
perfect and complete manual in  
the world immediately.

Our support email:

[ebooklibonline@outlook.com](mailto:ebooklibonline@outlook.com)