



Service Repair Manual

Models

320D2 Excavator



WARNING

Contact with high pressure fuel may cause fluid penetration and burn hazards. High pressure fuel spray may cause a fire hazard. Failure to follow these inspection, maintenance and service instructions may cause personal injury or death.

NOTICE

Ensure that all adjustments and repairs that are carried out to the fuel system are performed by authorized personnel that have the correct training.

Before beginning ANY work on the fuel system, refer to Operation and Maintenance Manual, "General Hazard Information and High Pressure Fuel Lines" for safety information.

Refer to System Operation, Testing and Adjusting, "Cleanliness of Fuel System Components" for detailed information on the standards of cleanliness that must be observed during ALL work on the fuel system.

1. Turn the fuel supply to the OFF position.
 2. Turn the battery disconnect switch to the OFF position.
-

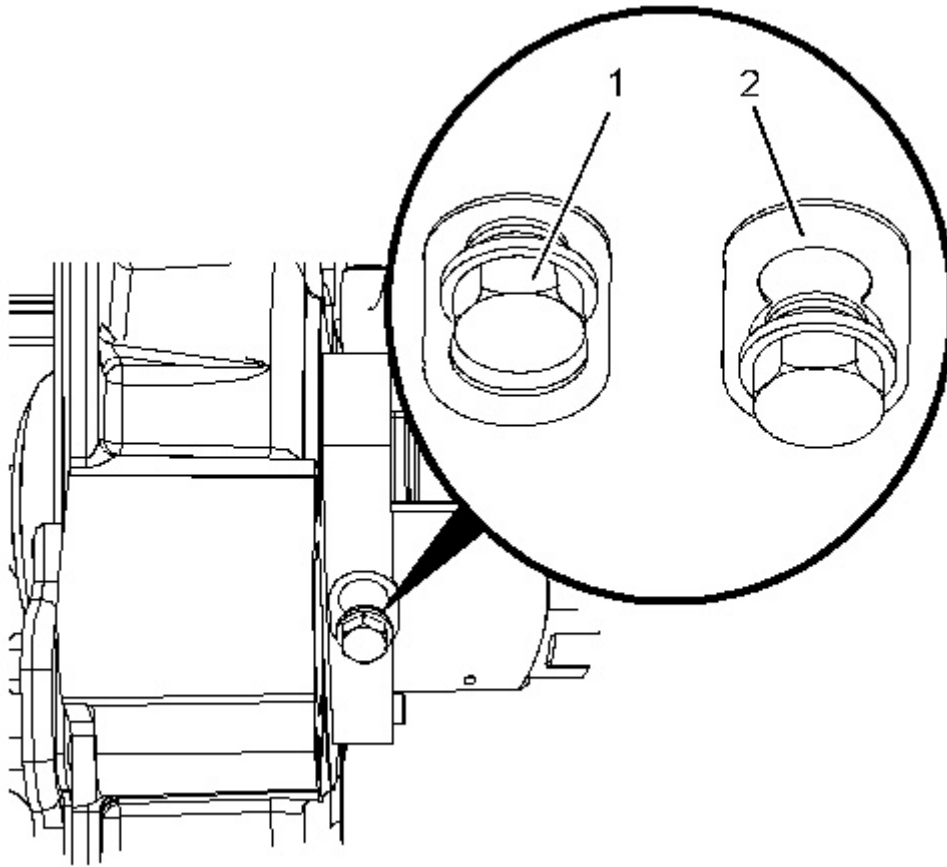

Illustration 1

g02695477

3. Use Tooling (A) in order to rotate the crankshaft so that number one piston is at top dead center position . Refer to System Operation, Testing and Adjusting, "Finding Top Center Position for No.1 Piston" for the correct procedure.
4. Use Tooling (B) in order to lock the crankshaft so that number one piston is at top dead center position.
5. Use Tooling (C) in order to lock the camshaft.
6. Loosen locking screw (1) . Rotate spacer (2) in order to allow locking screw (1) to tighten against the shaft of the fuel injection pump. Rotate the fuel injection pump gear in a counterclockwise direction in order to remove the backlash. Tighten locking screw (1) to a torque of 15 N·m (133 lb in).

Note: Locking the screw must be tightened in order to prevent the shaft of the fuel injection pump from rotating. The shaft of the fuel injection pump must not be rotated after the fuel injection pump has been removed from the engine.

7. Remove the backlash from the fuel pump gear. Lock the fuel injection pump in the correct position and remove the fuel pump gear. Refer to Disassembly and Assembly, "Fuel Pump Gear - Remove and Install" for the correct procedure.

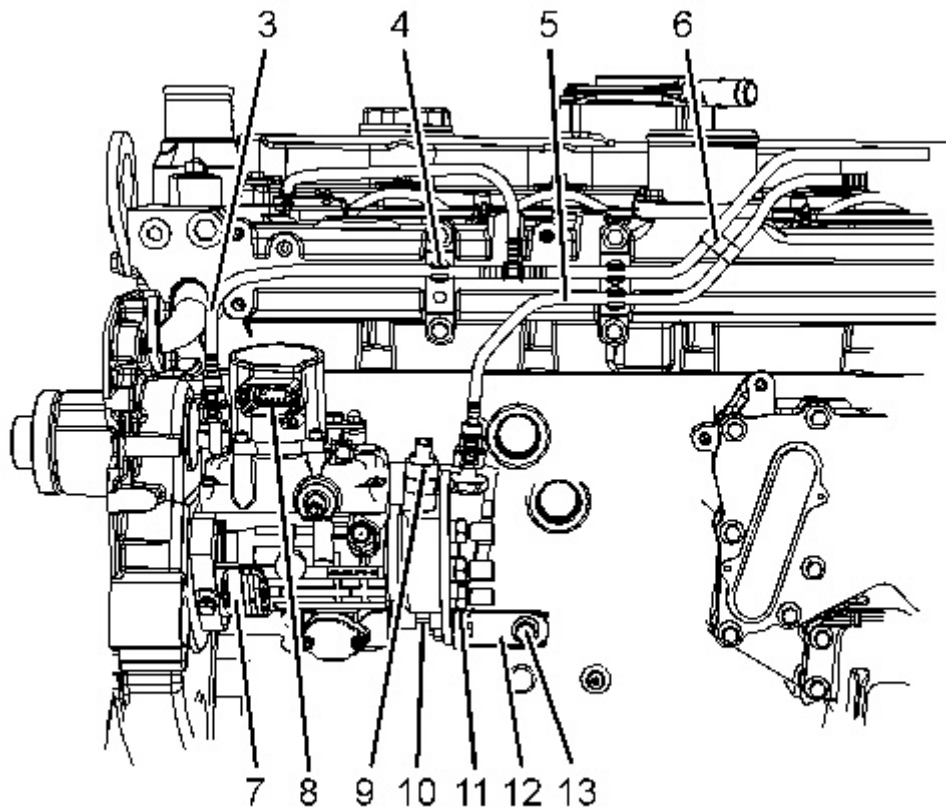

Illustration 2

g02695396

8. Clean fuel injection pump (7) and the area around the fuel injection pump. Ensure that the area is free from contamination before beginning disassembly.
9. Place a suitable container below fuel injection pump (7) in order to catch any fuel that might be spilled.
10. Disconnect plastic tube assembly (3) , and plastic tube assembly (5) from fuel injection pump (7) .
11. Remove plastic tube assembly (3) , and plastic tube assembly (5) from clips (4) and clip (6) . Position the plastic tube assemblies away from the fuel injection pump.
12. Use Tooling (D) in order to plug plastic tube assembly (3) , and plastic tube assembly (5) .
13. Use Tooling (D) in order to cap connection for the plastic tube assemblies on fuel injection pump (7) .
14. Disconnect the Original Equipment Manufactures (OEM) harness assembly from governor (8) .
15. Disconnect the OEM harness assemblies from solenoid (9) and solenoid (10) .
16. If necessary, disconnect the OEM harness assemblies from solenoid (10) .
17. Remove the nut and bolt (11) from fuel injection pump (7) .

18. Remove bolt (13) and remove bracket (12) from the cylinder block and the fuel injection pump.

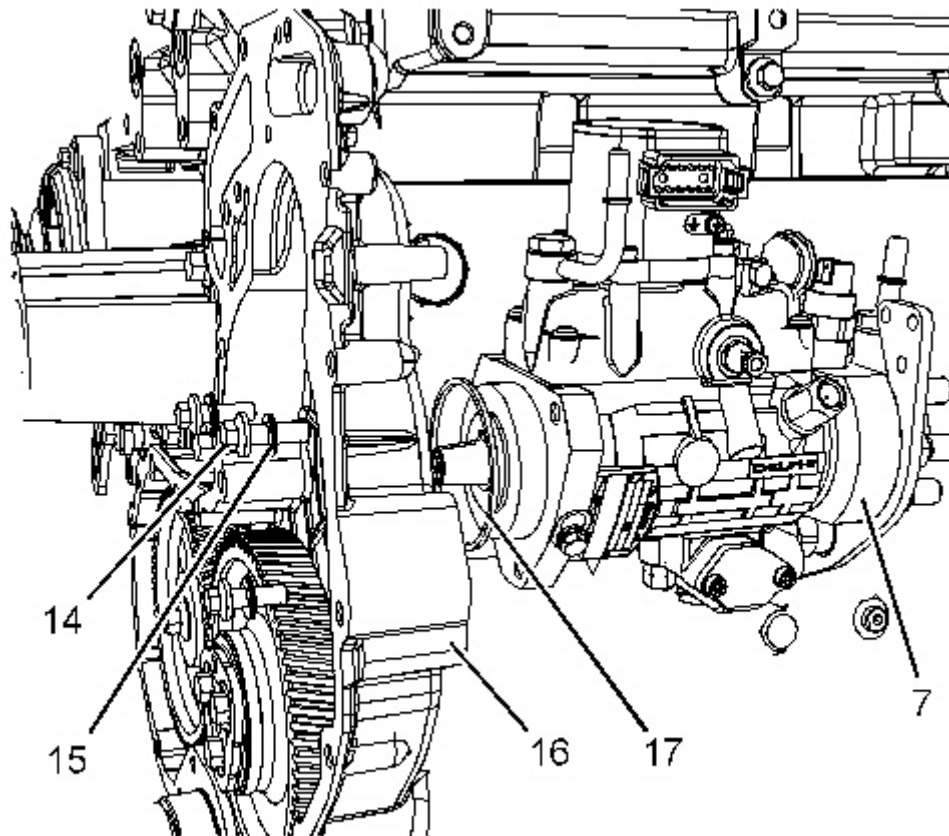

Illustration 3

g02695516

19. Remove bolts (14) and sealing washers (15) from fuel injection pump (7) .

Note: The fuel injection pump should be supported by hand as the bolts are removed.

20. Carefully remove fuel injection pump (7) from front housing (16) .

21. Remove O-ring seal (17) from fuel injection pump (7) .

Thank you so much for reading.
Please click the “Buy Now!”
button below to download the
complete manual.



After you pay.

You can download the most
perfect and complete manual in
the world immediately.

Our support email:

ebooklibonline@outlook.com