



Service Repair Manual

Models

320D2 Excavator

Product: EXCAVATOR

Model: 320D2 EXCAVATOR WDJ

Configuration: 320D2 & 320D2 L Excavators WDJ00001-UP (MACHINE) POWERED BY C7.1 Engine

Disassembly and Assembly 320D2 Excavator Engine Supplement

Media Number -UENR0199-09

Publication Date -01/07/2015

Date Updated -25/07/2018

i05537068

Water Pump - Remove and Install

SMCS - 1361-010

S/N - EKT1-UP

S/N - ESG1-UP

S/N - TGJ1-UP

S/N - WDJ1-UP

S/N - XAN1-UP

S/N - XBB1-UP

S/N - XCC1-UP

Removal Procedure

Start By:

- a. Remove the fan.
 - b. Remove the coolant tank (expansion).
-

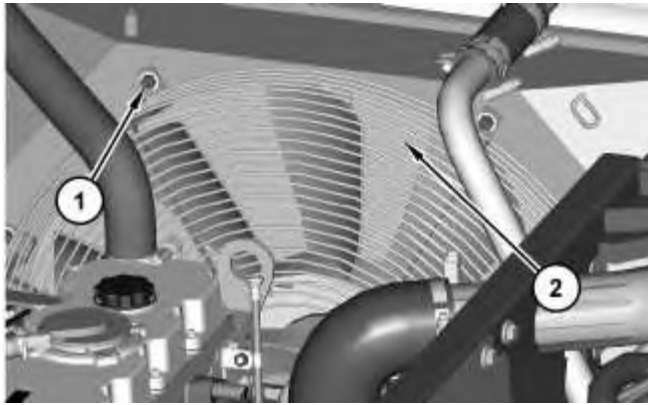

Illustration 1

g02795196

1. Remove bolts (1) and guard (2).



Illustration 2

g01306964

2. Disconnect hose (3).
-

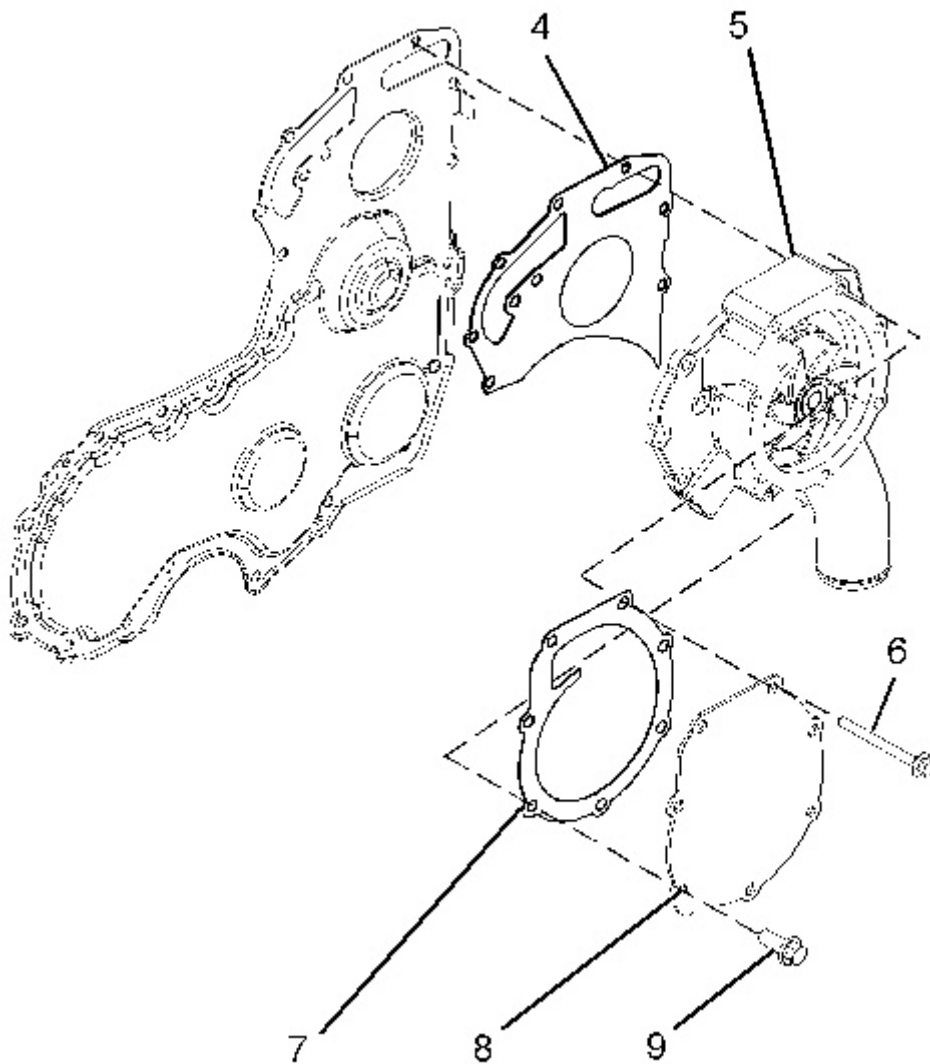

Illustration 3

g01307061

3. Remove bolts (6), cover (8), and gasket (7). Remove bolts (9) and water pump (5). Remove gasket (4).

Installation Procedure

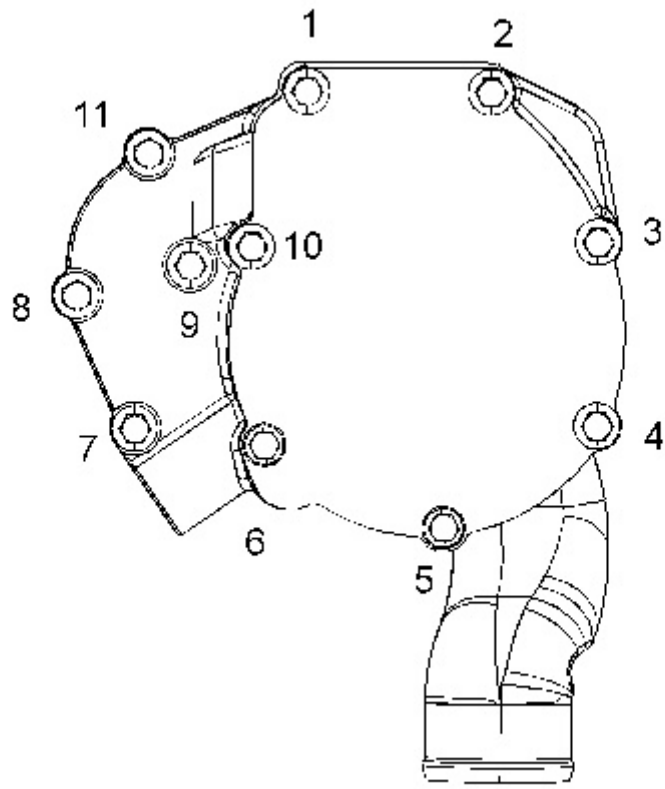

Illustration 4

g01183807

Thank you so much for reading.
Please click the “Buy Now!”
button below to download the
complete manual.



After you pay.

You can download the most
perfect and complete manual in
the world immediately.

Our support email:

ebooklibonline@outlook.com