



# Service Repair Manual

## **Models**

320D2 and 320D2 L Excavator

---

Product: EXCAVATOR

Model: 320D2 EXCAVATOR ZBD

Configuration: 320D2 & 320D2 L Excavators ZBD00001-UP (MACHINE) POWERED BY C7.1 Engine

## Disassembly and Assembly

### C7.1 (Mech) Engines for Caterpillar Built Machines

Media Number -UENR0674-08

Publication Date -01/06/2015

Date Updated -23/01/2017

i04780405

## Crankshaft Rear Seal - Remove

SMCS - 1161-011

### Removal Procedure

Table 1

Required Tools			
Tool	Part Number	Part Description	Qty
A	227-4389	E10 Torx Socket	1

#### Start By:

- Remove the flywheel. Refer to Disassembly and Assembly, "Flywheel - Remove".

---

#### NOTICE

**Keep all parts clean from contaminants.**

**Contaminants may cause rapid wear and shortened component life.**

---

---

#### NOTICE

**Care must be taken to ensure that fluids are contained during performance of inspection, maintenance, testing, adjusting and repair of the product. Be prepared to collect the fluid with suitable containers before opening any compartment or disassembling any component containing fluids.**

**Dispose of all fluids according to local regulations and mandates.**

---

**Note:** The crankshaft rear seal and the housing are manufactured as a one-piece assembly. The assembly is not serviceable. If the crankshaft rear seal is removed, the assembly must be replaced.

---

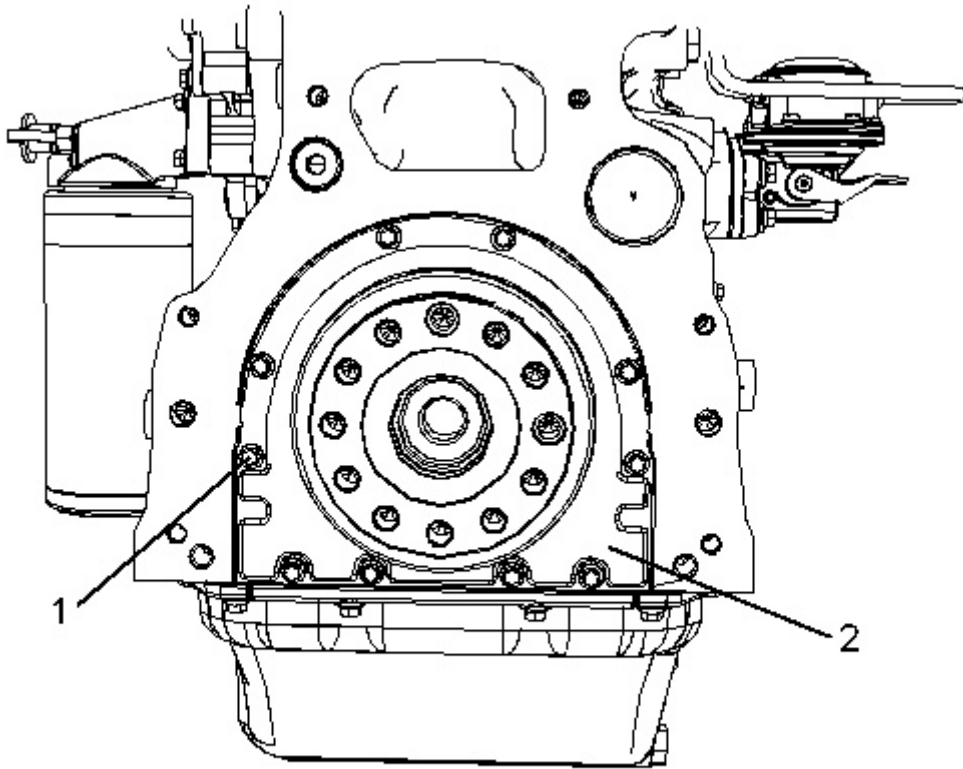

---

Illustration 1

g02711971

1. Use Tooling (A) in order to remove torx screws (1) from crankshaft rear seal (2).
2. Remove crankshaft rear seal (2) from the cylinder block. Discard the crankshaft rear seal.

Product: EXCAVATOR

Model: 320D2 EXCAVATOR ZBD

Configuration: 320D2 & 320D2 L Excavators ZBD00001-UP (MACHINE) POWERED BY C7.1 Engine

## Disassembly and Assembly

### C7.1 (Mech) Engines for Caterpillar Built Machines

Media Number -UENR0674-08

Publication Date -01/06/2015

Date Updated -23/01/2017

i04780403

## Crankshaft Rear Seal - Install

SMCS - 1161-012

### Installation Procedure

Table 1

Required Tools			
Tool	Part Number	Part Description	Qty
A	227-4389	E10 Torx Socket	1
B	FT-2806	Alignment Tool	1

**Note:** The crankshaft rear seal and the housing are manufactured as a one-piece assembly.

---

### NOTICE

**Keep all parts clean from contaminants.**

**Contaminants may cause rapid wear and shortened component life.**

---

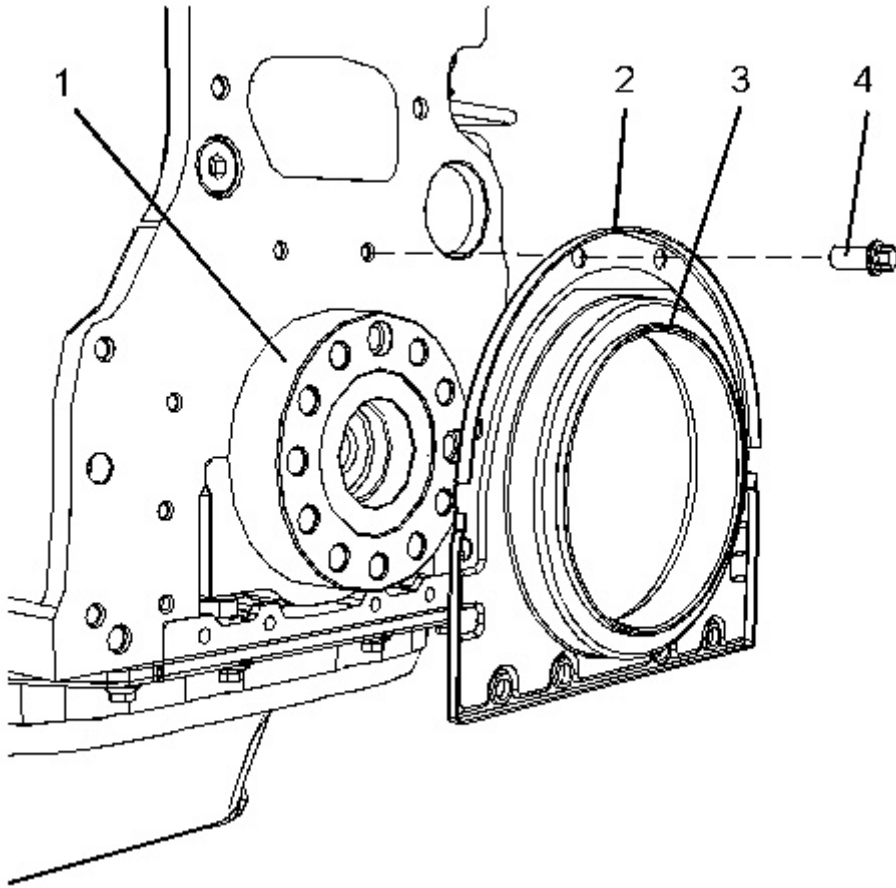

---

Illustration 1

g02717043

---

Thank you so much for reading.  
Please click the “Buy Now!”  
button below to download the  
complete manual.



After you pay.

You can download the most  
perfect and complete manual in  
the world immediately.

Our support email:

[ebooklibonline@outlook.com](mailto:ebooklibonline@outlook.com)