



Service Repair Manual

Models

420D BACKHOE LOADER

Product: BACKHOE LOADER

Model: 420D BACKHOE LOADER BKC

Configuration: 420D Backhoe Loader BKC00001-00501 (MACHINE) POWERED BY 3054 Engine

Disassembly and Assembly 3054C Engines for Caterpillar Built Machines

Media Number -SEN5069-18

Publication Date -01/05/2015

Date Updated -19/09/2018

i02296699

Rocker Shaft and Pushrod - Remove

SMCS - 1102-011; 1208-011

Removal Procedure

Table 1

Required Tools			
Tool	Part Number	Part Description	Qty
A	6K-0806	Cable Strap	3

Start By:

- Remove the valve mechanism cover. Refer to Disassembly and Assembly, "Valve Mechanism Cover - Remove and Install".

NOTICE

Keep all parts clean from contaminants.

Contaminants may cause rapid wear and shortened component life.

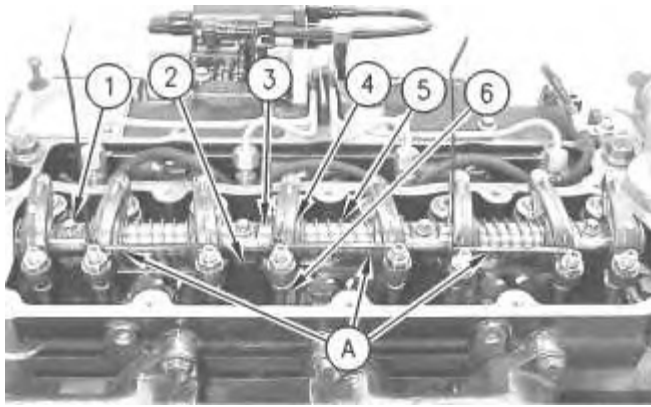

Illustration 1

g00960222

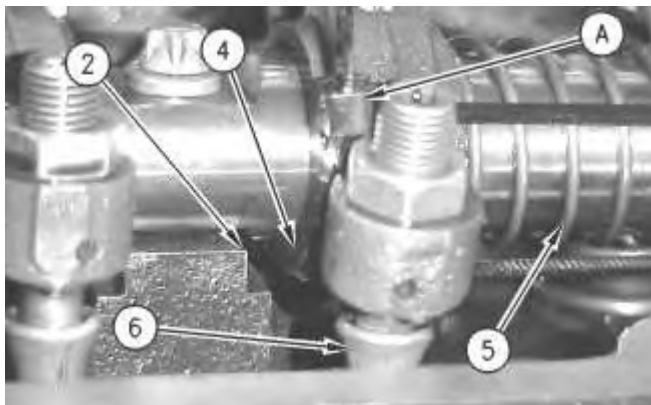

Illustration 2

g00960224

1. If the rocker shaft will not be disassembled, install the Tooling (A) around the rocker arms (4) in order to slightly compress the springs (5). The rocker arms must be held away from the machined faces of the cylinder head (2) during installation.
2. Remove the Torx screws (1) from the rocker shaft (3).
3. Remove the rocker shaft assembly from the cylinder head.
4. Remove the pushrods (6) from the cylinder head. Place an identification mark on each of the pushrods for installation.

Product: BACKHOE LOADER

Model: 420D BACKHOE LOADER BKC

Configuration: 420D Backhoe Loader BKC00001-00501 (MACHINE) POWERED BY 3054 Engine

Disassembly and Assembly 3054C Engines for Caterpillar Built Machines

Media Number -SEN5069-18

Publication Date -01/05/2015

Date Updated -19/09/2018

i02298103

Rocker Shaft - Disassemble

SMCS - 1102-015

Disassembly Procedure

Table 1

Required Tools			
Tool	Part Number	Part Description	Qty
A	1P-1855	Retaining Ring Pliers	1

Start By:

- Remove the rocker shaft assembly. Refer to Disassembly and Assembly, "Rocker Shaft and Pushrod - Remove".



WARNING

Personal injury can result from being struck by parts propelled by a released spring force.

Make sure to wear all necessary protective equipment.

Follow the recommended procedure and use all recommended tooling to release the spring force.

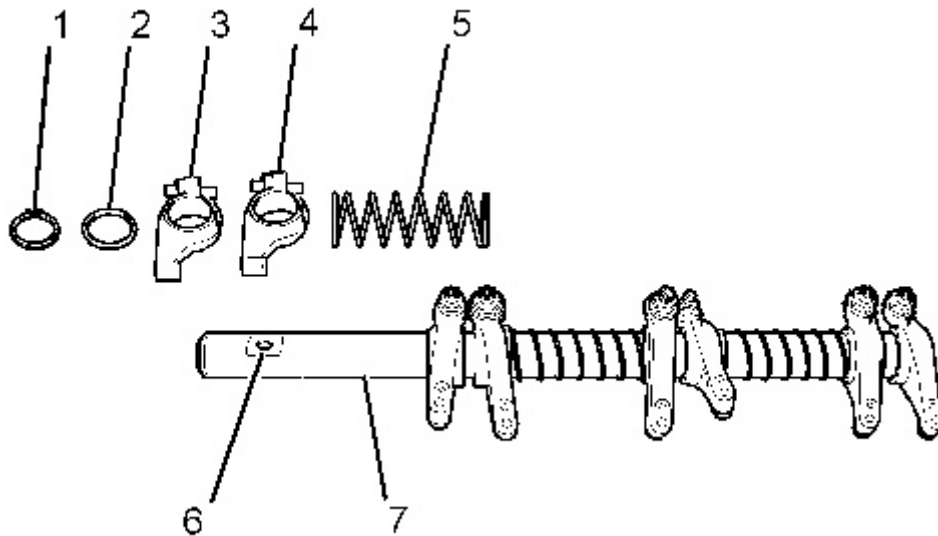

Illustration 1

g01150908

1. Remove the retaining ring (1) and remove the washer (2) from both ends of the rocker shaft assembly.

Note: The rocker shaft (7) is not symmetrical as there is a machined flat (6) toward one end of the shaft.
2. Place an identification mark on each of the components for installation. Ensure that you note the component's relationship to the machined flat (6).
3. Remove the rocker arm assembly (3) for the inlet valve from the rocker shaft (7). Remove the rocker arm assembly (4) for the exhaust valve from the rocker shaft (7).
4. Remove the spring (5) from the rocker shaft assembly.
5. Repeat Step 3 and Step 4 in order to completely disassemble the rocker shaft assembly.

Thank you so much for reading.
Please click the “Buy Now!”
button below to download the
complete manual.



After you pay.

You can download the most
perfect and complete manual in
the world immediately.

Our support email:

ebooklibonline@outlook.com