



Service Repair Manual

Models

420F2 Backhoe Loader

Product: BACKHOE LOADER

Model: 420F2 BACKHOE LOADER HWC

Configuration: 420F2 Center Pivot Backhoe Loader HWC00001-UP (MACHINE) POWERED BY C4.4 Engine

Disassembly and Assembly C4.4 Engines for Caterpillar Built Machines

Media Number -UENR4516-11

Publication Date -01/06/2015

Date Updated -29/10/2018

i05820279

Crankshaft Rear Seal - Remove

SMCS - 1161-011

Removal Procedure

Table 1

| Required Tools | | | |
|----------------|-------------|------------------|-----|
| Tool | Part Number | Part Description | Qty |
| A | 227-4390 | E12 Torx Socket | 1 |

Start By:

- Remove the flywheel. Refer to Disassembly and Assembly, "Flywheel - Remove" for the correct procedure.

NOTICE

Keep all parts clean from contaminants.

Contaminants may cause rapid wear and shortened component life.

NOTICE

Care must be taken to ensure that fluids are contained during performance of inspection, maintenance, testing, adjusting and repair of the product. Be prepared to collect the fluid with suitable containers before opening any compartment or disassembling any component containing fluids.

Dispose of all fluids according to local regulations and mandates.

Note: The crankshaft rear seal and the housing are manufactured as a one-piece assembly. The assembly is not serviceable. If the crankshaft rear seal is removed, the assembly must be replaced.

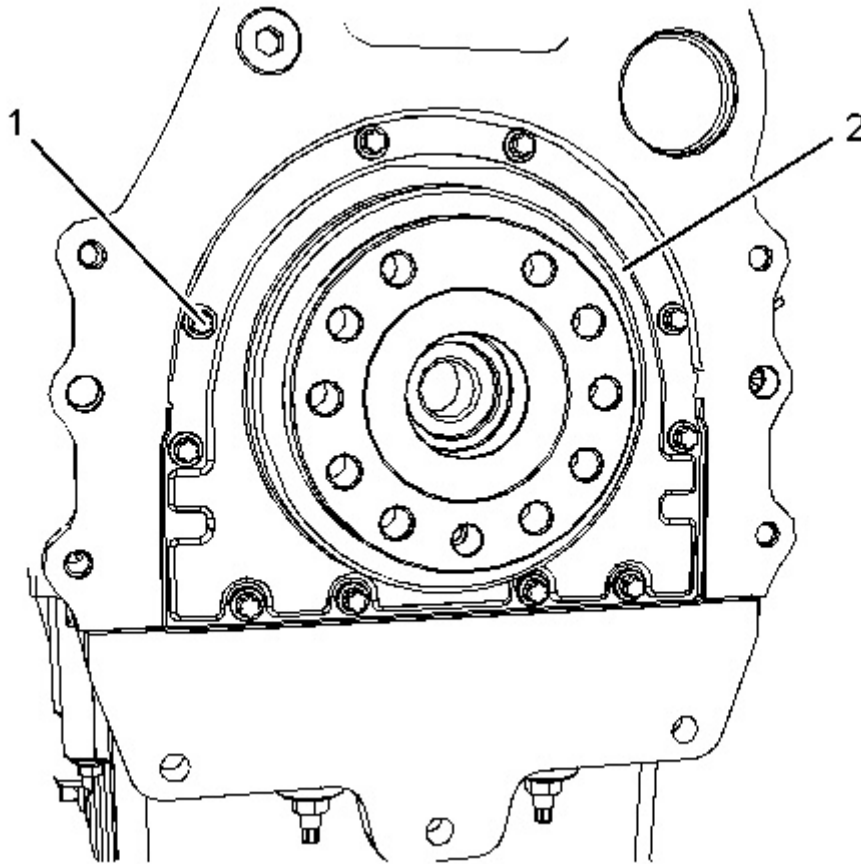

Illustration 1

g02449936

1. Use Tooling (A) in order to remove torx screws (1) from crankshaft rear seal (2).
2. Remove crankshaft rear seal (2) from the cylinder block. Discard the crankshaft rear seal.

Product: BACKHOE LOADER

Model: 420F2 BACKHOE LOADER HWC

Configuration: 420F2 Center Pivot Backhoe Loader HWC00001-UP (MACHINE) POWERED BY C4.4 Engine

Disassembly and Assembly C4.4 Engines for Caterpillar Built Machines

Media Number -UENR4516-11

Publication Date -01/06/2015

Date Updated -29/10/2018

i05820280

Crankshaft Rear Seal - Install

SMCS - 1161-012

Installation Procedure

Table 1

| Required Tools | | | |
|----------------|-------------|------------------|-----|
| Tool | Part Number | Part Description | Qty |
| A | 227-4390 | E12 Torx Socket | 1 |
| B | FT-2806 | Alignment Tool | 1 |

Note: The crankshaft rear seal and the housing are manufactured as a one-piece assembly.

NOTICE

Keep all parts clean from contaminants.

Contaminants may cause rapid wear and shortened component life.

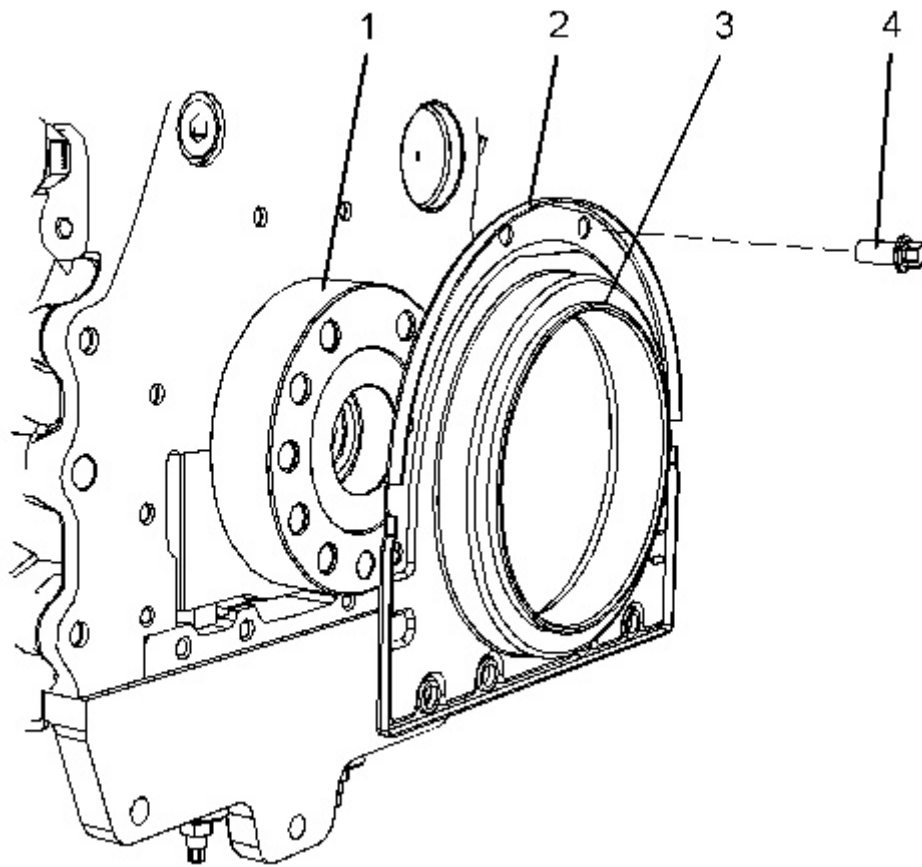

Illustration 1

g02450219

Thank you so much for reading.
Please click the “Buy Now!”
button below to download the
complete manual.



After you pay.

You can download the most
perfect and complete manual in
the world immediately.

Our support email:

ebooklibonline@outlook.com