



Service Repair Manual

Models

422F2 Backhoe Loader

Product: BACKHOE LOADER

Model: 422F2 BACKHOE LOADER LYF

Configuration: 422F2 Side Shift Backhoe Loader LYF00001-UP (MACHINE) POWERED BY C4.4 Engine

Disassembly and Assembly

422F2, 427F2, 428F2, 432F2, 434F2 and 444F2 Backhoe Loaders Powertrain

Media Number -UENR3743-01

Publication Date -01/06/2015

Date Updated -05/06/2018

i07435290

Transmission (Direct Drive) - Assemble

SMCS - 3030-016-DD; 3066-016

Assembly Procedure

Table 1

Required Tools			
Tool	Part Number	Part Description	Qty
A	395-1590	Lifting Eye Assembly	1
B	422-5471	Lifting Eye Assembly	2
C	4C-3652	Spring Compressor	1
D	1P-1859	Retaining Ring Pliers	1
H	137-8102	Spring Compressor	1
J	1P-0510	Driver Gp	1
K	-	Loctite High Flex Gasket Maker	-
L	-	Loctite Retaining Compound 648 ⁽¹⁾	-
M	-	Loctite Retaining Compound 243 ⁽²⁾	-
N	8T-5096	Dial Indicator Gp	1

⁽¹⁾ Loctite 649 is acceptable.

⁽²⁾ Loctite 242 is acceptable.

Note: The transmission will be assembled in major components. The major components will then be assembled.

Note: Apply a light film of clean transmission oil to all components before assembly.

Transmission case



Illustration 1

g03831934

1. Install breather (168).

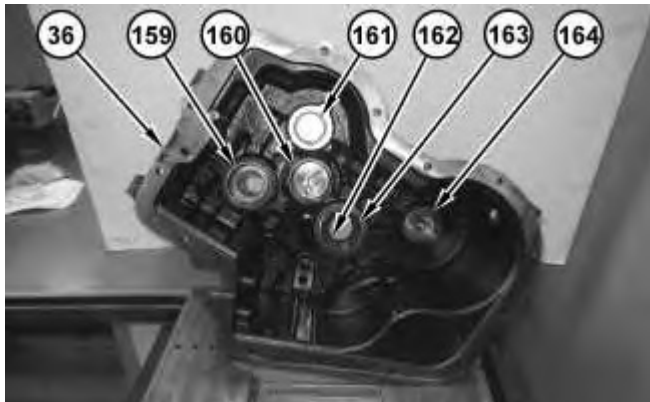

Illustration 2

g03831928



Illustration 3

g03832503

2. Use Tooling (J) to install lip seal (162) into case (36). Dimension (X) is the depth to install lip seal (162) into case (36). Dimension (X) is 4.00 ± 0.25 mm (0.157 ± 0.010 inch).

Note: Install the shims behind each bearing cup that was recorded on the disassembly procedure.

3. Install bearing cup (159), bearing cup (160), bearing cup (161), bearing cup (163), and bearing cup (164) into case (36).



Illustration 4

g03831925

4. Install temperature sensor (158). Tighten temperature sensor (158) to a torque of $20 \pm 3 \text{ N}\cdot\text{m}$ ($177 \pm 27 \text{ lb in}$).

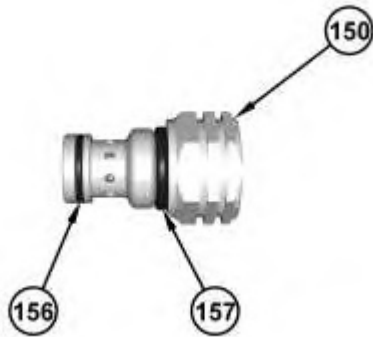
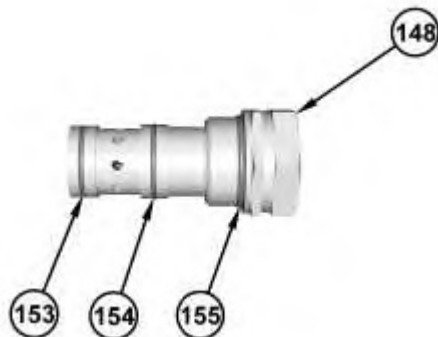

Illustration 5

g03831923

5. Install O-ring seals (153) and (154) onto relief valve (150).



6. Install O-ring seals (153), (154), and (155) onto relief valve (148).

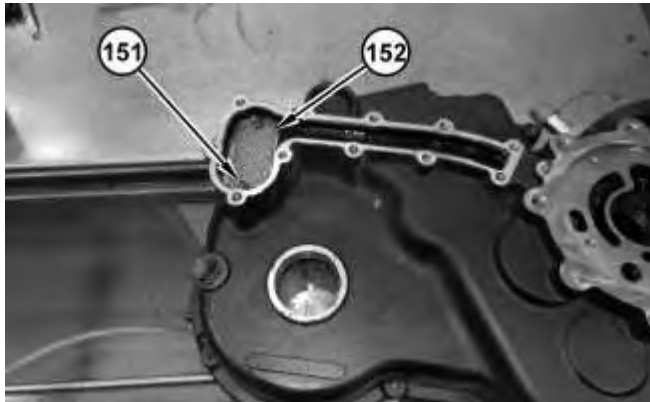

Illustration 7

7. Install strainer (152) and bolts (151).

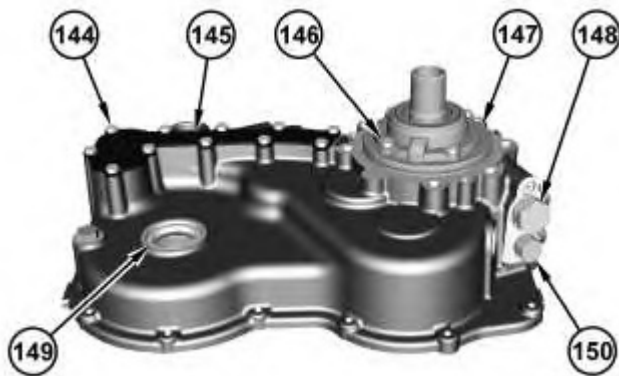

Illustration 8



Illustration 9

8. Install relief valve (148). Tighten relief valve (148) to a torque 46 to 54 N·m (34 to 40 lb ft).

Thank you so much for reading.
Please click the “Buy Now!”
button below to download the
complete manual.



After you pay.

You can download the most
perfect and complete manual in
the world immediately.

Our support email:

ebooklibonline@outlook.com