



Service Repair Manual

Models

426F2 Backhoe Loader

Product: BACKHOE LOADER

Model: 426 F2 BACKHOE LOADER DJ4

Configuration: 426F2 Backhoe Loader Side Shift DJ400001-UP (MACHINE) POWERED BY C4.4 Engine

Disassembly and Assembly 426F2 Back Hoe Loader Power Train System

Media Number -M0079727-01

Publication Date -01/06/2015

Date Updated -14/08/2017

i06943334

Axle Housing (Differential and Bevel Gear) (Front) - Assemble

SMCS - 3256-016-FR; 3258-016-FR; 3260-016-FR

S/N - DJ41-UP

S/N - EJ41-UP

Assembly Procedure

Table 1

Required Tools				
Tool	Qty	Part Number	Part Description	Illustration (Substep) Location
A	1	235-2797	Spanner Wrench As	Illustration 17 (1)
C	1	235-2784	Adjuster Tool Gp	Illustration 11 (2)
E	1	1P-0520	Driver Gp	Illustration 1 (2,4)
F	1	235-2789	Pinion Setting Tool	Illustration 2 (1) and 6 (4)
G	2	235-2795	Disc	Illustration 3 (1) and 5 (5)
H	1	235-2796	Shaft	Illustration 3 (2) and 5 (4)
J	1	6V-2012	Depth micrometer	Illustration 3 (5) and 5 (1)
K	-	-	Loctite 638	Illustration 14 (2)
L	1	8T-5096	Tool Gp	Illustration 18 (1)

Note: Check the O-ring seals, the gaskets, and the seals for wear or for damage. Replace the components, if necessary.

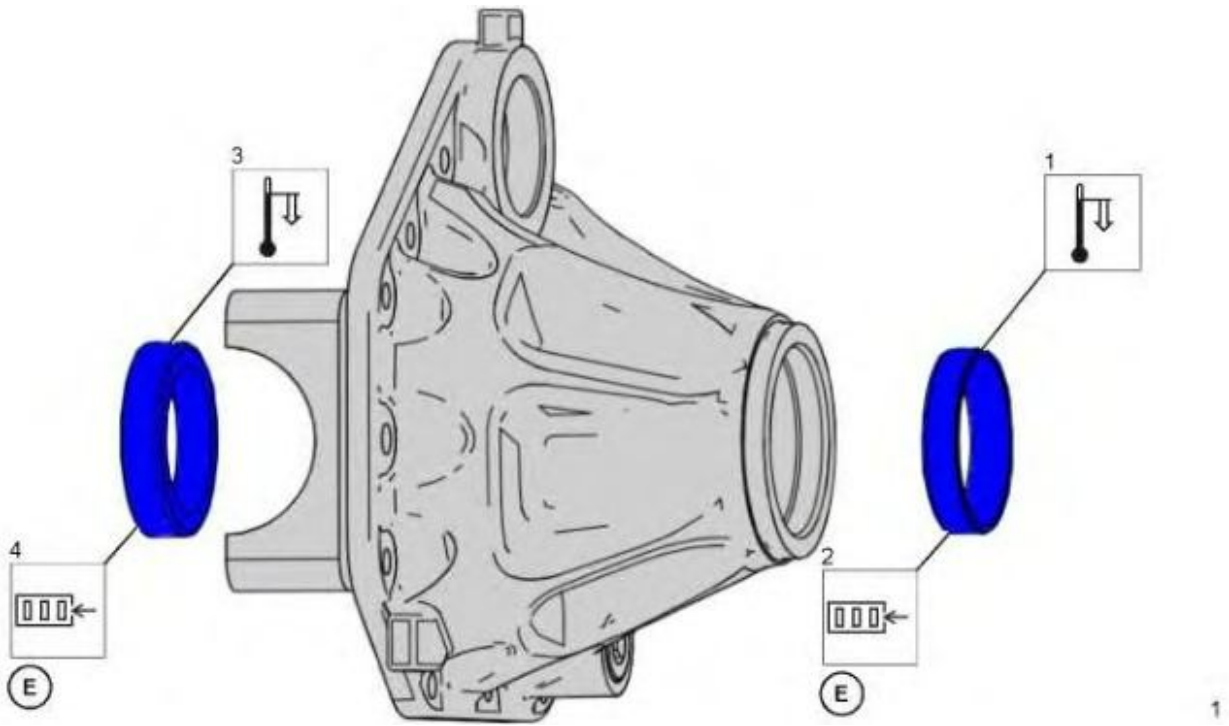

Illustration 1

g06177534

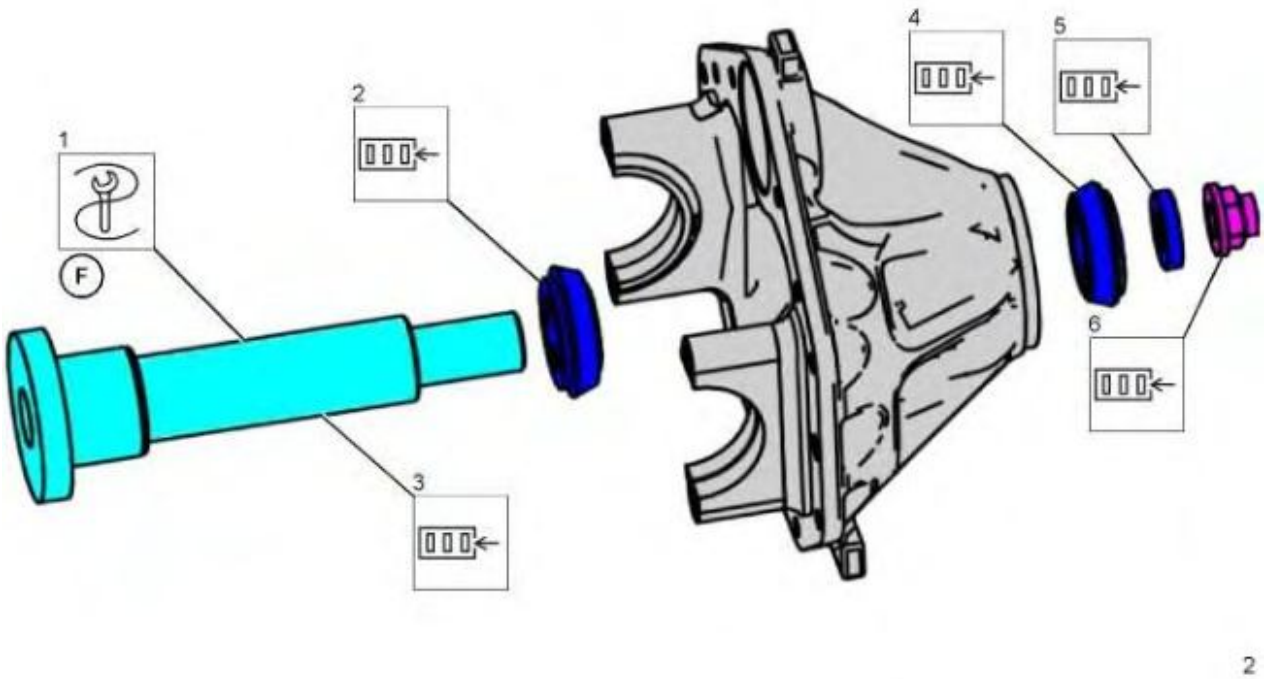
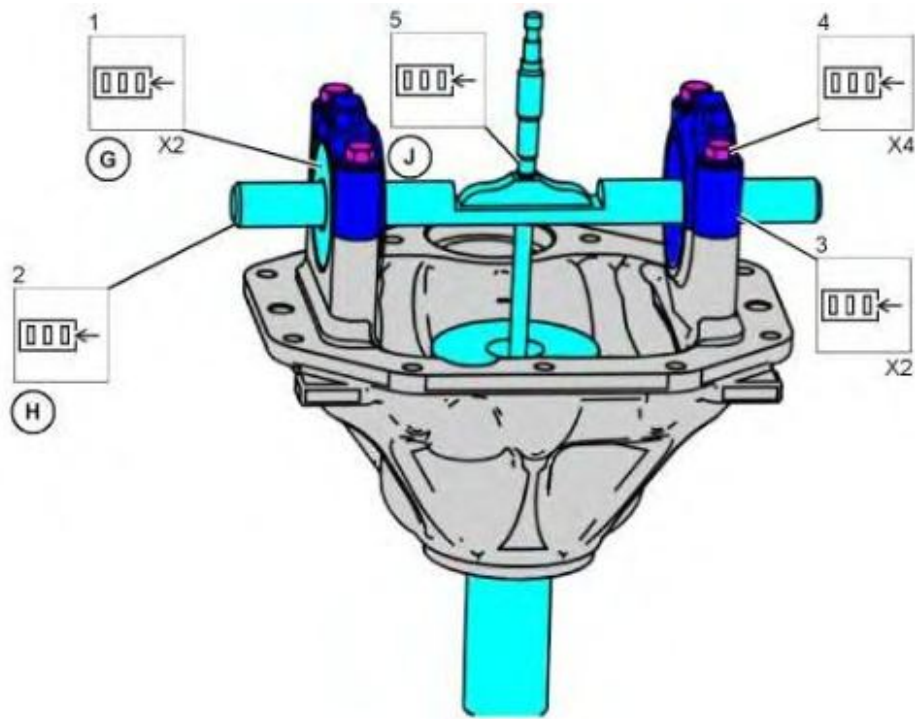

Illustration 2

g06182903



3

Illustration 3

g06182956

Tighten nut (4) until there is no end play.

Measure the depth from Tooling (H) to the bottom of the hole in Tooling (F). Record the measurement as Measurement (X).

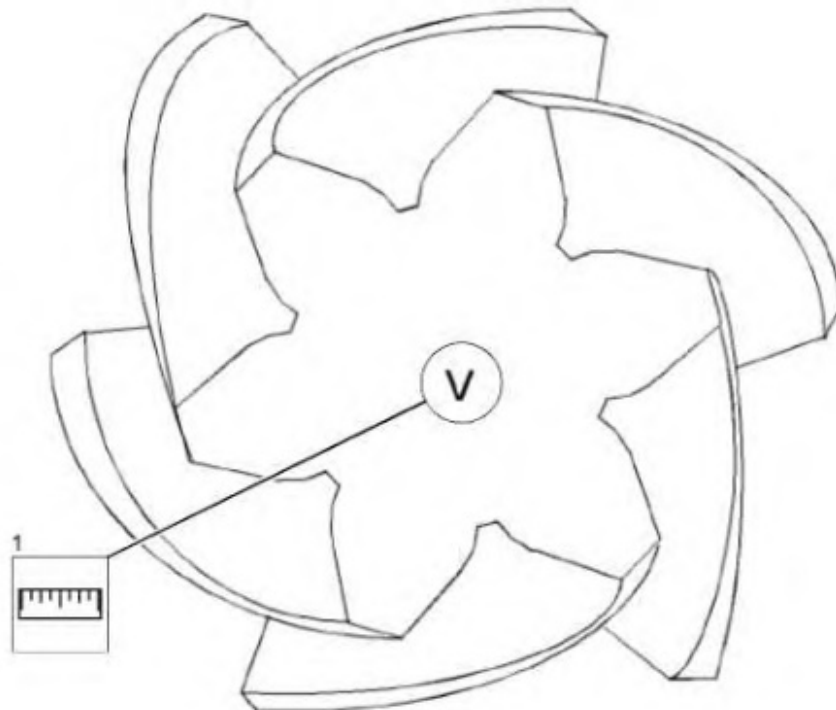

4

Illustration 4

g06182978

Measurement (V) is stamped on the head of the pinion shaft. Measurement (S) is the thickness of the shim that is used between the pinion shaft and the bearing cone. Use the following formula to calculate Measurement (S) : $X \text{ mm} - V \text{ mm} = S \text{ mm}$. Choose the shim with the thickness of Measurement (S).

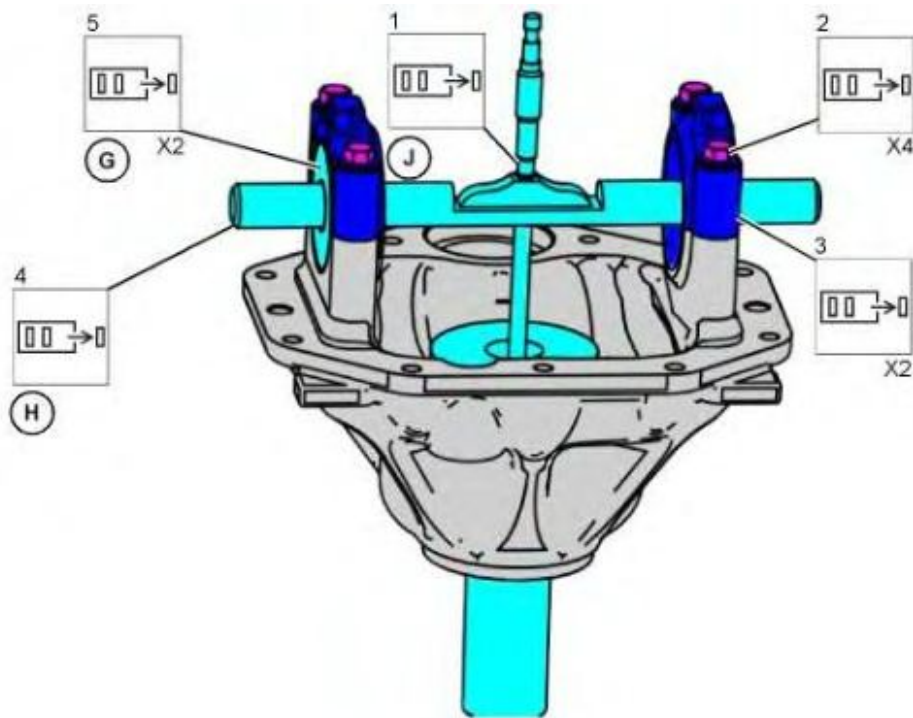

5

Illustration 5

g06182992

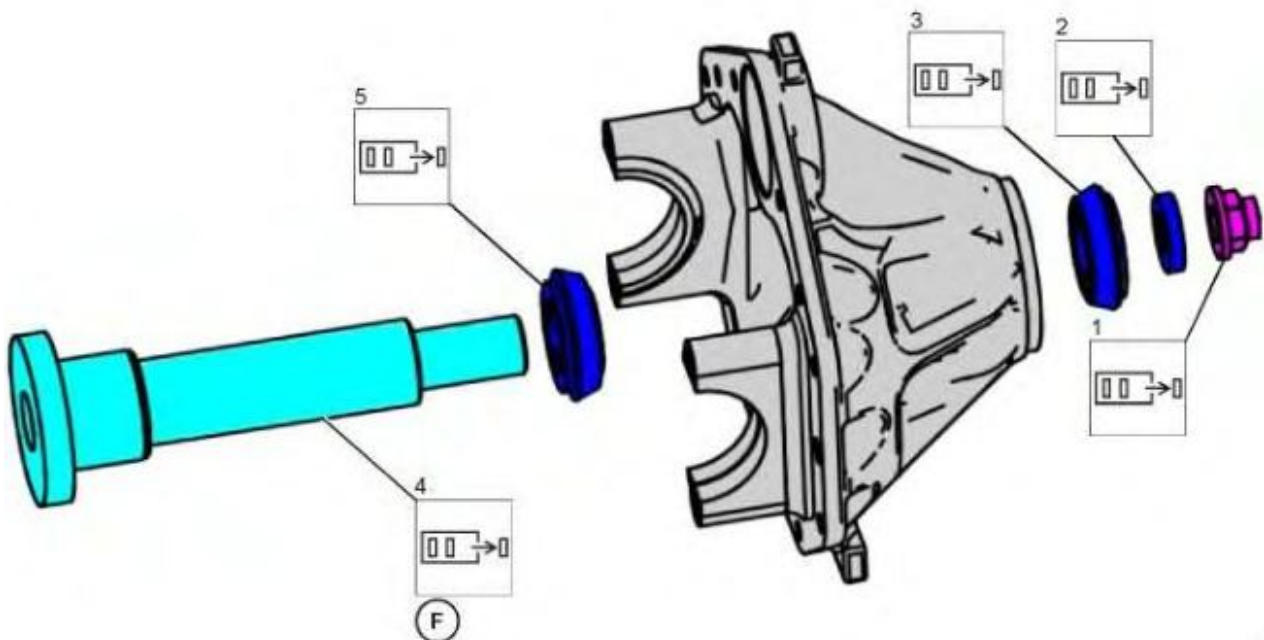

6

Illustration 6

g06183003

Thank you so much for reading.
Please click the “Buy Now!”
button below to download the
complete manual.



After you pay.

You can download the most
perfect and complete manual in
the world immediately.

Our support email:

ebooklibonline@outlook.com