



Service Repair Manual

Models

428F Backhoe Loader

Product: BACKHOE LOADER

Model: 428F BACKHOE LOADER LBH

Configuration: 428F Backhoe Loader LBH00001-UP (MACHINE) POWERED BY C4.4 Engine

Disassembly and Assembly C4.4 (Mech) Engines for Caterpillar Built Machines

Media Number -KENR9210-10

Publication Date -01/12/2014

Date Updated -08/08/2018

i02763427

Crankshaft Rear Seal - Remove

SMCS - 1161-011

Removal Procedure

Table 1

Required Tools			
Tool	Part Number	Part Description	Qty
A	227-4390	E12 Torx Socket	1

Start By:

- Remove the flywheel. Refer to Disassembly and Assembly, "Flywheel - Remove".

NOTICE

Keep all parts clean from contaminants.

Contaminants may cause rapid wear and shortened component life.

NOTICE

Care must be taken to ensure that fluids are contained during performance of inspection, maintenance, testing, adjusting and repair of the product. Be prepared to collect the fluid with suitable containers before opening any compartment or disassembling any component containing fluids.

Dispose of all fluids according to local regulations and mandates.

Note: The crankshaft rear seal and the housing are manufactured as a one-piece assembly. The assembly is not serviceable. If the crankshaft rear seal is removed, the assembly must be replaced.

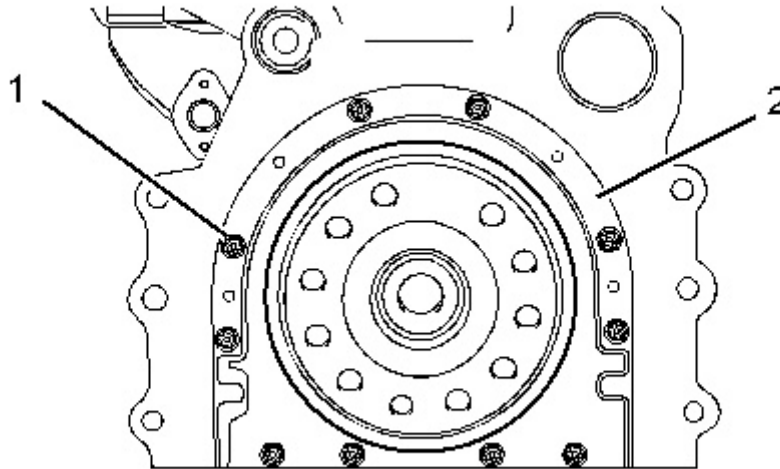

Illustration 1
Typical example

g01269512

1. Use Tooling (A) in order to remove torx screws (1) from crankshaft rear seal (2).
2. Remove crankshaft rear seal (2) from the cylinder block. Discard the crankshaft rear seal.

Product: BACKHOE LOADER

Model: 428F BACKHOE LOADER LBH

Configuration: 428F Backhoe Loader LBH00001-UP (MACHINE) POWERED BY C4.4 Engine

Disassembly and Assembly C4.4 (Mech) Engines for Caterpillar Built Machines

Media Number -KENR9210-10

Publication Date -01/12/2014

Date Updated -08/08/2018

i02763428

Crankshaft Rear Seal - Install

SMCS - 1161-012

Installation Procedure

Table 1

Required Tools			
Tool	Part Number	Part Description	Qty
A	227-4390	E12 Torx Socket	1
B	FT-2806	Alignment Tool	1

Note: The crankshaft rear seal and the housing are manufactured as a one-piece assembly.

NOTICE

Keep all parts clean from contaminants.

Contaminants may cause rapid wear and shortened component life.

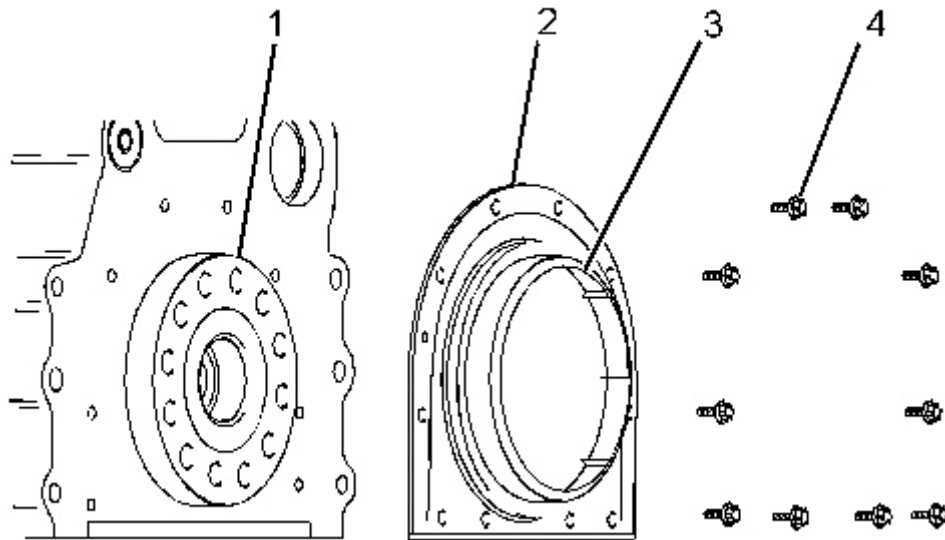

Illustration 1

g01258105

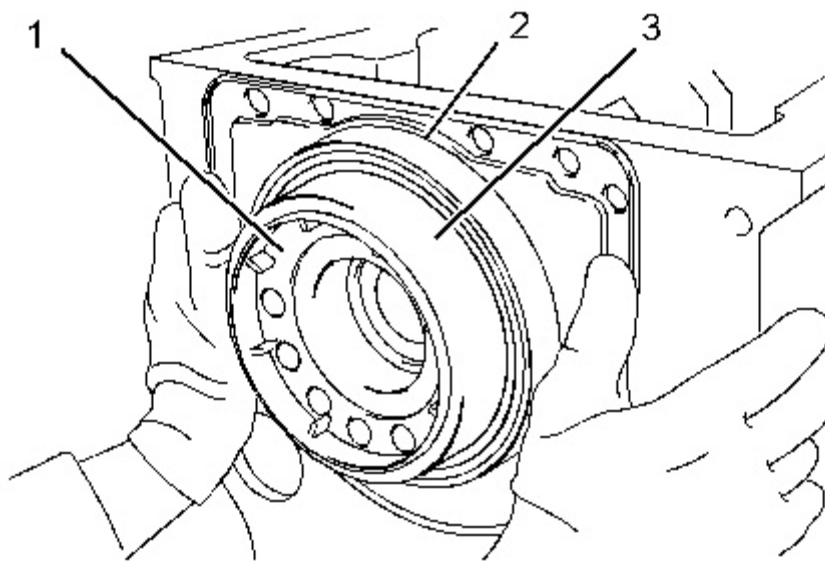

Illustration 2

g01255709

Typical example

1. Ensure that crankshaft flange (1) is clean, dry and free from damage.
2. Ensure that the face of the cylinder block and the bridge piece are clean and dry.
3. A new crankshaft rear seal is supplied with a plastic sleeve (3). Ensure that the plastic sleeve is squarely installed within crankshaft rear seal (2).

Note: The plastic sleeve is included in order to protect the lip of the seal as the seal is pushed over the crankshaft flange.

Note: Do not lubricate the crankshaft rear seal or the crankshaft flange. The crankshaft rear seal must be installed dry.

Thank you so much for reading.
Please click the “Buy Now!”
button below to download the
complete manual.



After you pay.

You can download the most
perfect and complete manual in
the world immediately.

Our support email:

ebooklibonline@outlook.com