



Service Repair Manual

Models

446D Backhoe Loader

Product: BACKHOE LOADER

Model: 446D BACKHOE LOADER DBL

Configuration: 446D Backhoe Loader DBL00001-UP (MACHINE) POWERED BY 3114 Engine

Disassembly and Assembly 446D Backhoe Loader Machine Systems

Media Number -REN8711-01

Publication Date -01/07/2004

Date Updated -17/08/2018

i02136242

Bank Valve (Loader) - Disassemble

SMCS - 5051-015; 5124-015

Disassembly Procedure

Start By:

- a. Remove the bank valve for the loader. Refer to Disassembly and Assembly, "Bank Valve (Loader) - Remove".

NOTICE

Care must be taken to ensure that fluids are contained during performance of inspection, maintenance, testing, adjusting and repair of the product. Be prepared to collect the fluid with suitable containers before opening any compartment or disassembling any component containing fluids.

Refer to Special Publication, NENG2500, "Caterpillar Tools and Shop Products Guide" for tools and supplies suitable to collect and contain fluids on Caterpillar products.

Dispose of all fluids according to local regulations and mandates.

NOTICE

Keep all parts clean from contaminants.

Contamination of the hydraulic system with foreign material will reduce the service life of the hydraulic system components.

To prevent contaminants from entering the hydraulic system, always plug or cap the lines, fittings, or hoses as they are disconnected. Cover any disassembled components and clean them properly before assembly.

Clean the hydraulic system properly after any major component exchange or especially after a component failure, to remove any contamination.

Note: Cleanliness is an important factor. Before the disassembly procedure, the exterior of the component should be thoroughly cleaned. This will help to prevent dirt from entering the internal mechanism.

Note: Put identification marks on all of the components of the control valve bank as the components are being removed. All of the parts must be reinstalled in the part's original location. Do not damage any of the internal parts during the removal. Keep all of the internal parts of the valve clean and lubricated.

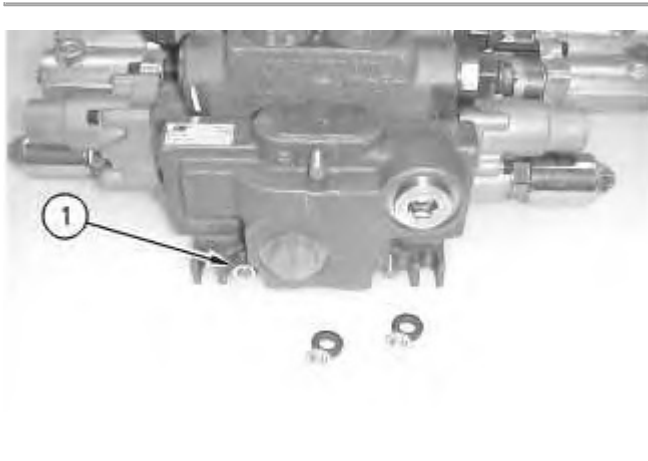

Illustration 1

g00733207

1. Remove nuts (1) and the washers.

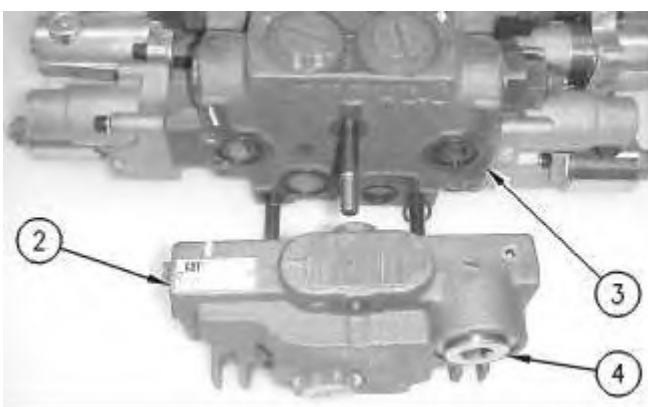

Illustration 2

g00733215

2. Separate cover (2) from auxiliary valve (3).

3. Remove plug (4).

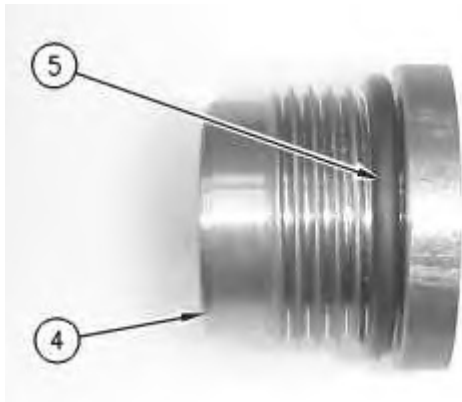

Illustration 3

g00733197

4. Remove O-ring seal (5) from plug (4).

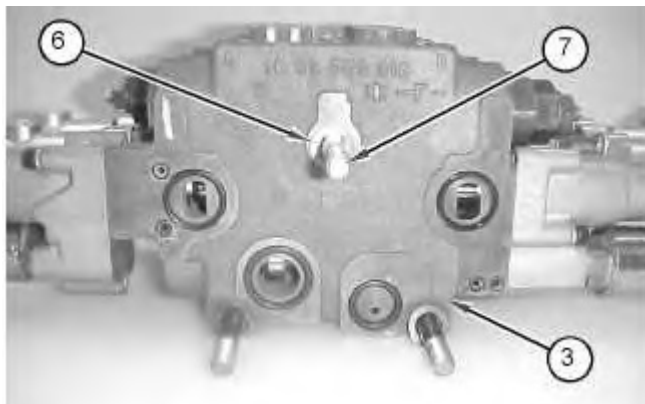
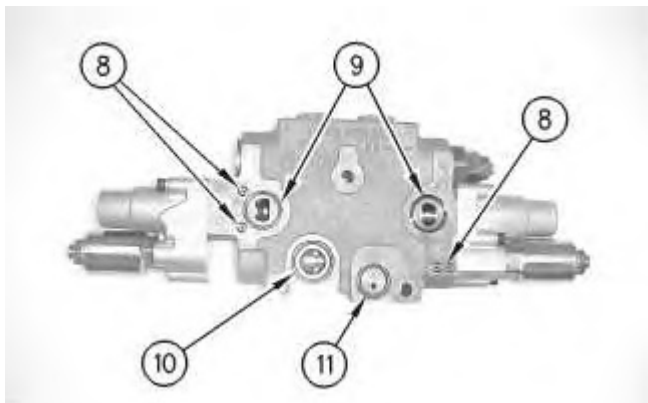

Illustration 4

g01085622

5. Remove shims (6) from studs (7).

6. Slide auxiliary valve (3) from studs (7).



7. Remove O-ring seals (8), (9), (10), and (11) from the auxiliary valve.

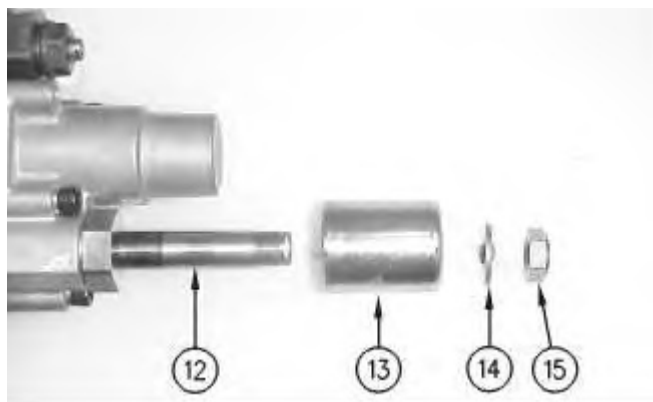

Illustration 6

8. Remove the following items from cartridge assembly (12): nut (15), washer (14) and coil assembly (13).
9. Remove cartridge assembly (12).

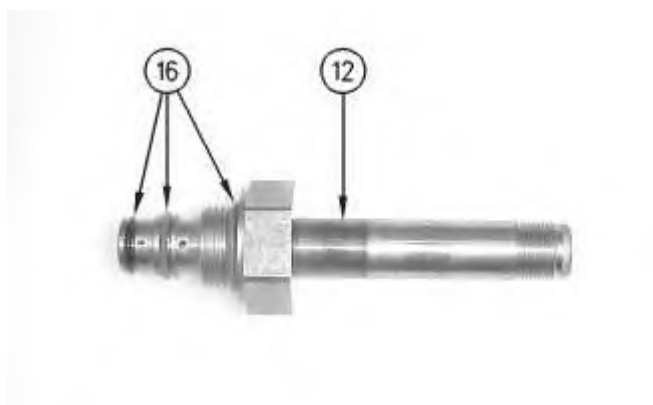

Illustration 7

10. Remove O-ring seals (16) from cartridge assembly (12).



Thank you so much for reading.
Please click the “Buy Now!”
button below to download the
complete manual.



After you pay.

You can download the most
perfect and complete manual in
the world immediately.

Our support email:

ebooklibonline@outlook.com