



Service Repair Manual

Models

450F BACKHOE LOADER

Product: BACKHOE LOADER

Model: 450F BACKHOE LOADER HJR

Configuration: 450F Backhoe Loader HJR00001-UP (MACHINE) POWERED BY C4.4 Engine

Disassembly and Assembly C4.4 Engines for Caterpillar Built Machines

Media Number -UENR0602-11

Publication Date -01/08/2013

Date Updated -25/10/2017

i04047746

Crankshaft Front Seal - Remove and Install - Crankshaft Front Seal for Heavy Duty Front Cover

SMCS - 1160-010

Removal Procedure

Table 1

Required Tools			
Tool	Part Number	Part Description	Qty
A	1P-2320	Combination Puller	1

Start By:

- Remove the crankshaft pulley. Refer to Disassembly and Assembly, "Crankshaft Front Pulley- Remove and Install" for the correct procedure.

NOTICE

Keep all parts clean from contaminants.

Contaminants may cause rapid wear and shortened component life.

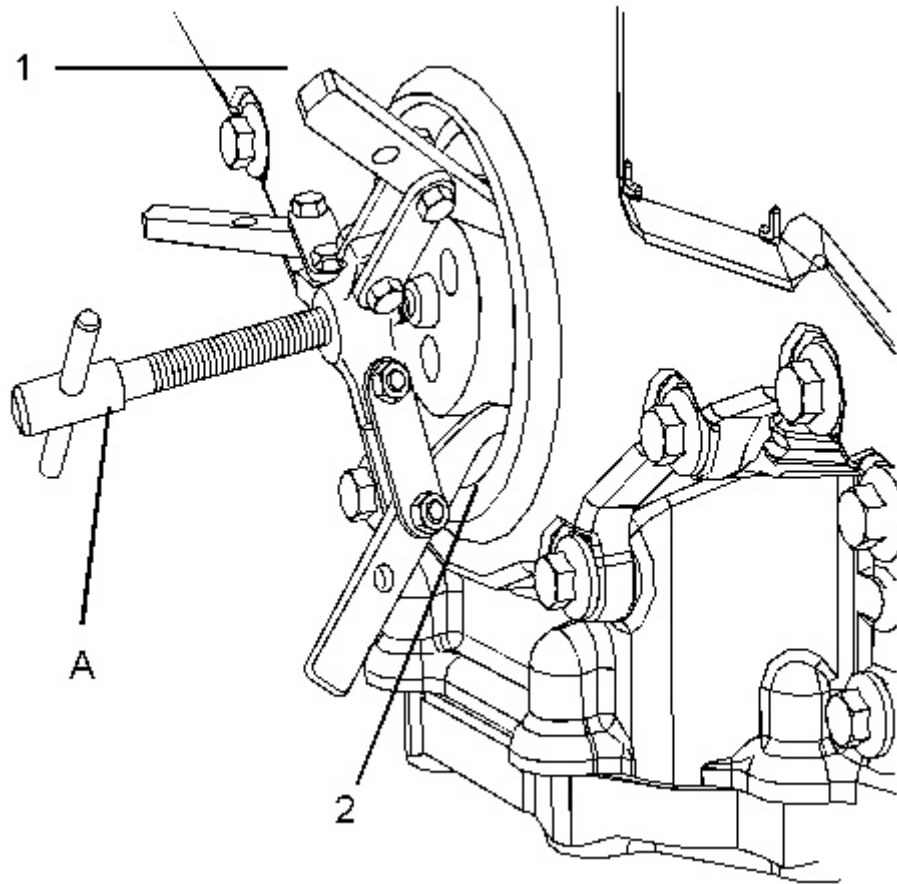

Illustration 1

g02443718

1. Install the legs of Tooling (A) behind crankshaft front seal (2). Install a suitable spacer between Tooling (A) and the crankshaft.
2. Use Tooling (A) in order to pull crankshaft front seal (2) out of front cover (1).

Note: Do not damage the edge of the front cover for the crankshaft front seal.

Installation Procedure

Table 2

Required Tools			
Tool	Part Number	Part Description	Qty
B	9U-6206	Front Seal Installer	1
	9U-6207	Plate	1
	9U-6208	Anchor Plate	1
	276-1209	Seal Installer Tool	1
	9U-6209	Sleeve	1

NOTICE

Keep all parts clean from contaminants.

Contaminants may cause rapid wear and shortened component life.

1. Ensure that the bore for the crankshaft front oil seal in the front cover is clean and free from damage.
-

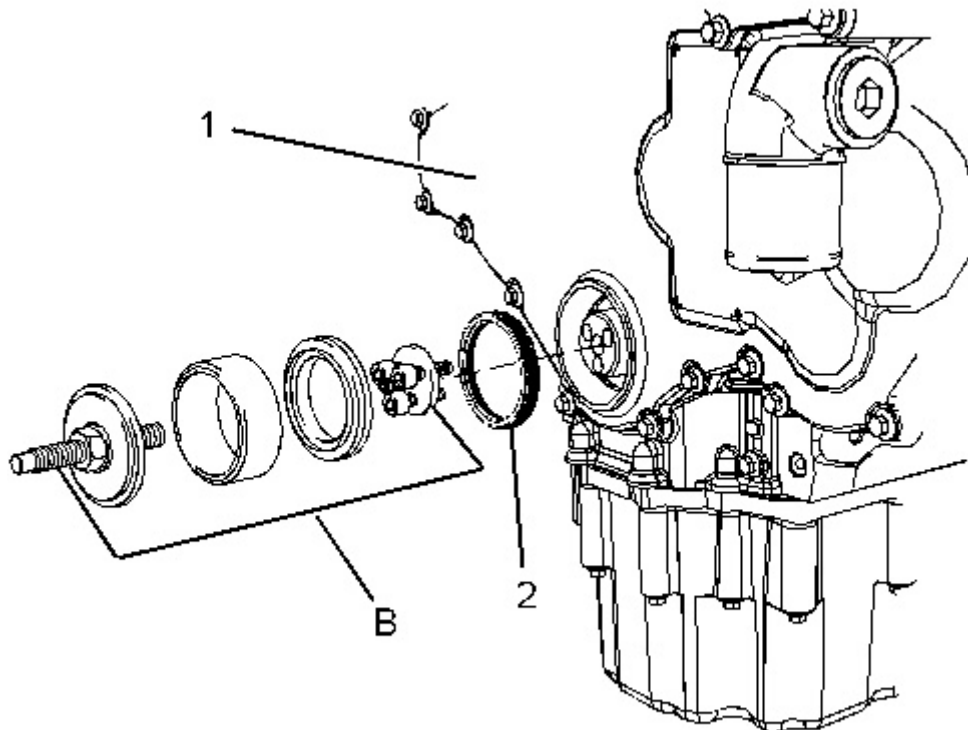

Illustration 2

g02443719

2. Assemble Tooling (B).
3. Correctly position a new crankshaft front seal (2) to front cover (1).

Note: If the crankshaft front seal is supplied with a sleeve, remove the sleeve from the crankshaft front seal before installation.

4. Use Tooling (B) to install crankshaft front seal (2) to front cover (1). Ensure that the front face of the crankshaft front seal is installed to a depth of 6.5 ± 0.2 mm (0.256 ± 0.008 inch).
5. Remove Tooling (B) from the crankshaft.

End By:

- a. Install the crankshaft pulley. Refer to Disassembly and Assembly, "Crankshaft Front Pulley-Remove and Install" for the correct procedure.

[Copyright 1993 - 2019 Caterpillar Inc.](#)

Mon Dec 9 23:18:33 UTC+0800 2019

[All Rights Reserved.](#)

[Private Network For SIS Licensees.](#)

Thank you so much for reading.
Please click the “Buy Now!”
button below to download the
complete manual.



After you pay.

You can download the most
perfect and complete manual in
the world immediately.

Our support email:

ebooklibonline@outlook.com