



Service Repair Manual

Models

938G WHEEL LOADER

Product: WHEEL LOADER

Model: 938G WHEEL LOADER 6WS

Configuration: 938G Wheel Loader 6WS00001-UP (MACHINE) POWERED BY 3126 Engine

Disassembly and Assembly Flexxair Fan

Media Number -REN3699-07

Publication Date -01/02/2012

Date Updated -21/06/2016

i01742847

Mechanical Actuated Fan - Assemble

SMCS - 1356-016

Shifter Block – Assemble

Note: The following procedure should only be performed by persons that have taken the fan rebuilding training course at FLEXXAIRE Manufacturing Inc. The shifter block assembly is sold only as an assembly unless you have had the training.

Note: Proceed to “Hub - Assemble” if you have purchased a shifter block assembly.

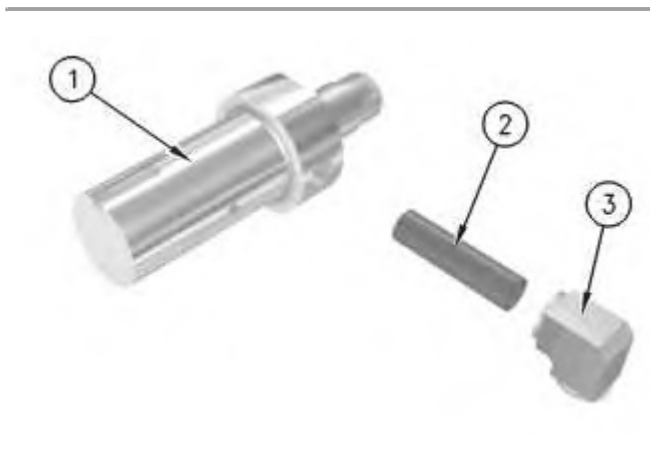

Illustration 1

g00597621

1. Thread elbow (3) onto pickup tube (2). Then, thread pickup tube (2) into through shaft bearing end (1).

Note: The orientation of pickup tube (2) in Illustration 2 is shown in the most common direction. However, other applications may require pickup tube (2) to be rotated 180 degrees. Pickup tube (2) is stationary. Pickup tube (2) does not rotate. The arrows indicate the direction of oil flow into pickup tube (2).

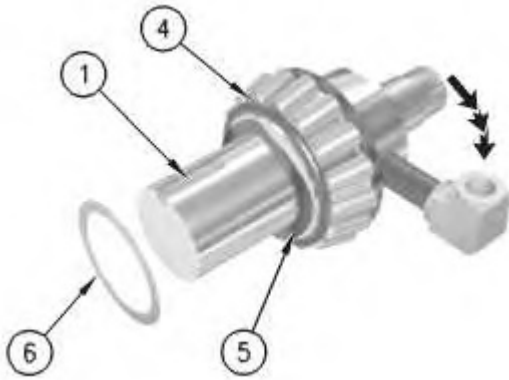

Illustration 2

g00597622

2. Slide bearing cone (4) onto through shaft bearing end (1). Slide wave washer (5) and spacer (6) onto through shaft bearing end (1).

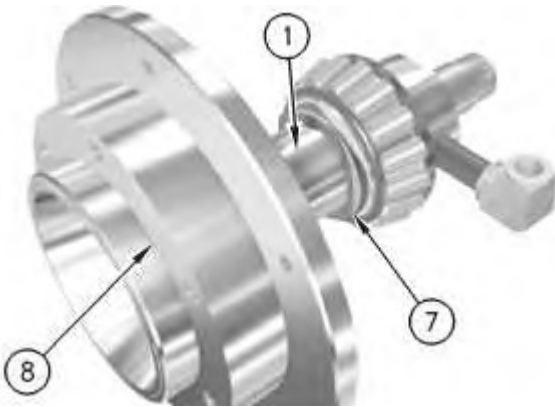

Illustration 3

g00597623

3. Slide wave washer (7) onto through shaft bearing end (1).
4. Insert the races into the bores of shifter block plate (8).
5. Slide shifter block plate (8) onto through shaft bearing end (1).



Illustration 4

g00597624

- Slide bearing cone (9) onto through shaft bearing end (1).



Illustration 5

g00597625

- Install locking washer (10) and bearing locknut (11) onto through shaft bearing end (1).

Note: Once proper clearance is obtained, bend the tabs of locking washer (10) into the slots in bearing locknut (11). Proper clearance is 0.0254 mm to 0.0762 mm (0.001 inch to 0.003 inch). The shifter block assembly should spin freely.

Hub – Assemble

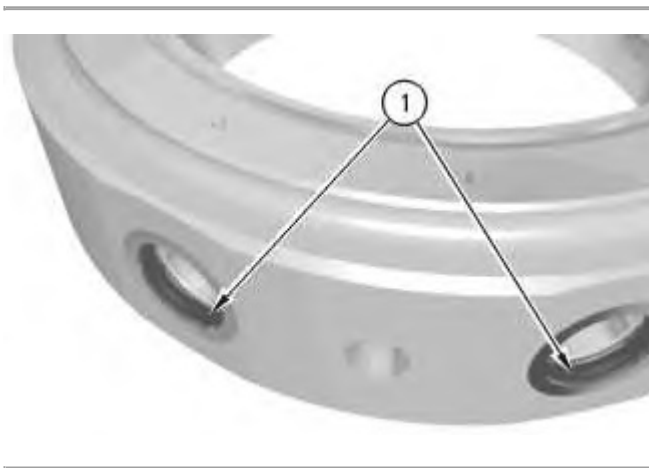

Illustration 6

g00597501

- Lubricate O-Ring (1) with a light film of oil and insert O-Ring (1) into the hub insert.

Note: Clean the O-Ring groove thoroughly before installing O-Ring (1) in order to prevent leakage.

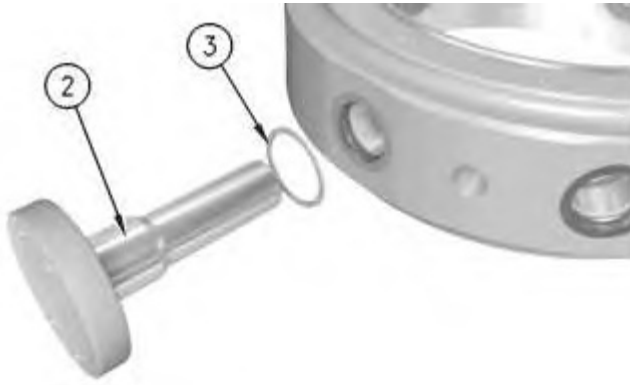

Illustration 7

g00597503

2. Lubricate the shank of blade mounting shaft (2) with oil. Install nylon washer (3) onto blade mounting shaft (2) and insert blade mounting shaft (2) into the hub insert.

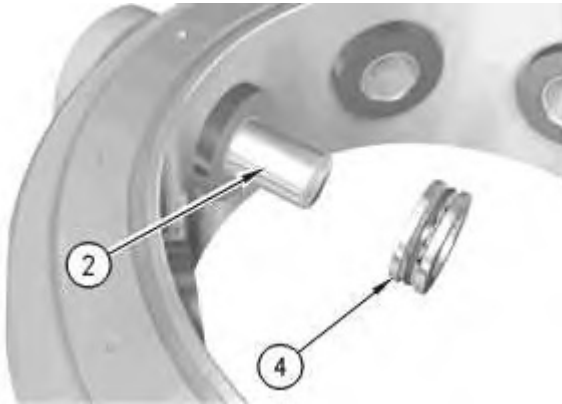

Illustration 8

g00597506

3. Install the race of bearing (4) with the larger inside diameter onto blade mounting shaft (2).
4. Install the cage of bearing (4) onto blade mounting shaft (2).
5. Install the race of bearing (4) with the smaller inside diameter onto blade mounting shaft (2).



Illustration 9

g00597507

Thank you so much for reading.
Please click the “Buy Now!”
button below to download the
complete manual.



After you pay.

You can download the most
perfect and complete manual in
the world immediately.

Our support email:

ebooklibonline@outlook.com