



# Service Repair Manual

## **Models**

# 950H WHEEL LOADER

---

Product: WHEEL LOADER

Model: 950H WHEEL LOADER N1A

Configuration: 950H Wheel Loader N1A00001-UP (MACHINE) POWERED BY C7 Engine

## Disassembly and Assembly

### IT62H Integrated Toolcarrier and 950H and 962H Wheel Loaders Machine Systems

Media Number -REN8881-01

Publication Date -01/06/2009

Date Updated -08/06/2009

i02288172

## Piston Pump (Steering) - Disassemble

SMCS - 4306-015; 5070-015-ZH

### Disassembly Procedure

Table 1

Required Tools			
Tool	Part Number	Part Description	Qty
A	1P-4878	Plate <sup>(1)</sup>	1
B	1P-1861	Retaining Ring Pliers	1

<sup>(1)</sup> 33.3 mm (1.31 inch) diameter

#### Start By:

- a. Remove the steering pump. Refer to Disassembly and Assembly, "Piston Pump (Steering) - Remove".

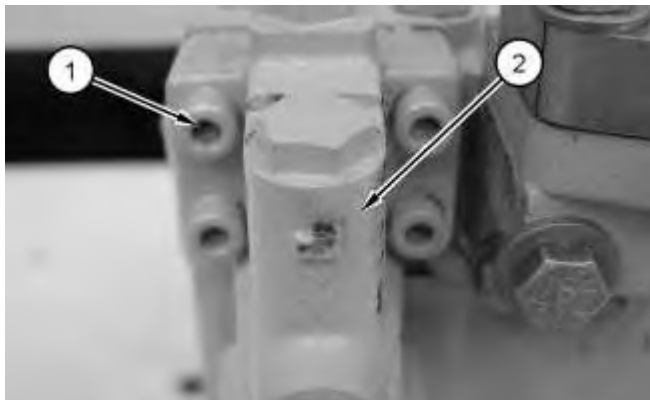

Illustration 1

g01145338

1. Remove bolts (1) and valve (2).

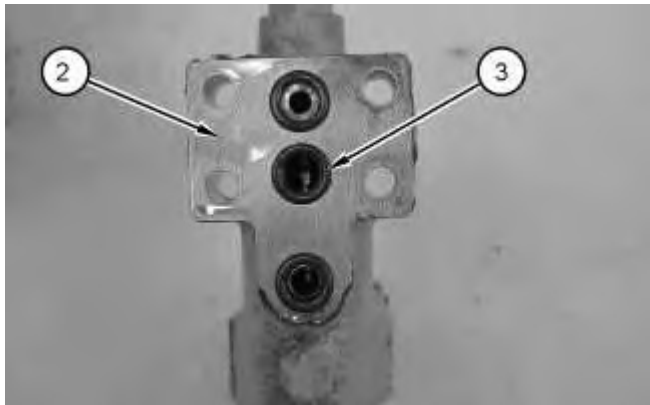

Illustration 2

g01145339

2. Remove O-ring seals (3) from valve (2).

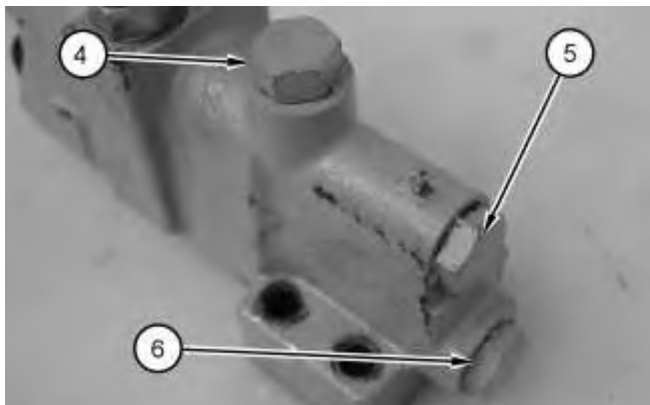

Illustration 3

g01145340



**Personal injury can result from being struck by parts propelled by a released spring force.**

**Make sure to wear all necessary protective equipment.**

**Follow the recommended procedure and use all recommended tooling to release the spring force.**

- 
3. Remove plug (4), the O-ring seals, plug (5), and plug (6).
-

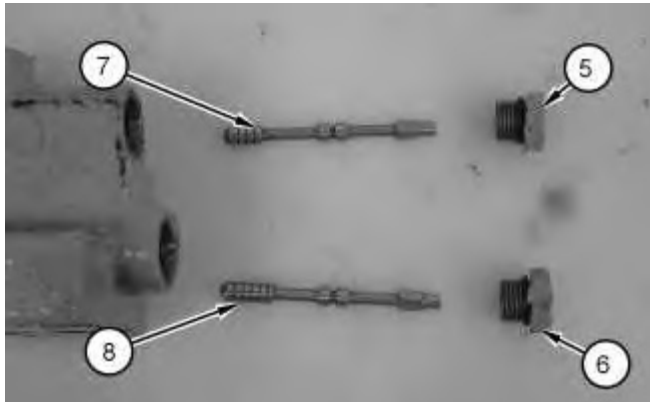

Illustration 4

g01145341

4. Remove spool (7) and spool (8).
5. Remove the O-ring seals from plug (5) and plug (6).

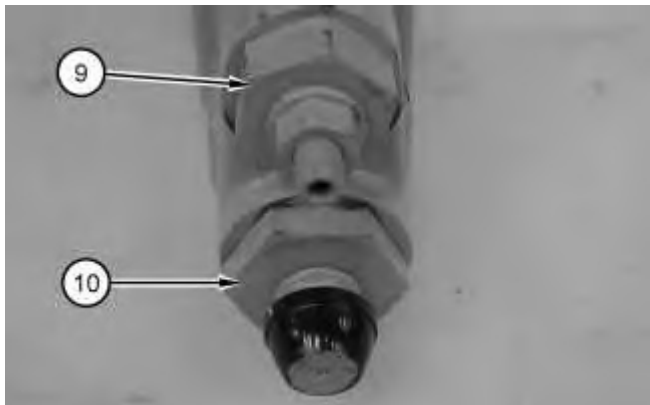

Illustration 5

g01145342

## **WARNING**

**Personal injury can result from being struck by parts propelled by a released spring force.**

**Make sure to wear all necessary protective equipment.**

**Follow the recommended procedure and use all recommended tooling to release the spring force.**

6. Remove adjustment screw (9) and adjustment screw (10).

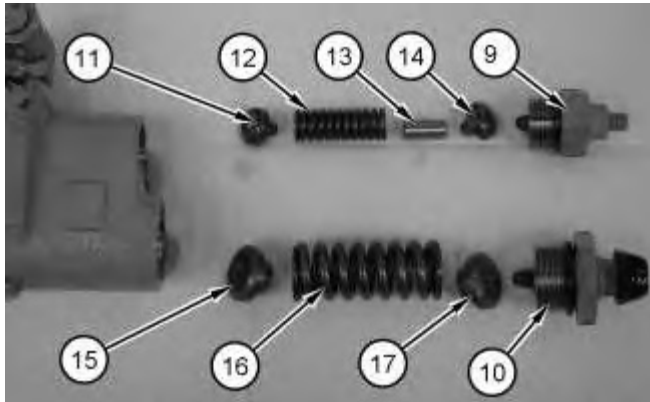

Illustration 6

g01145354

7. Remove retainer (14), spacer (13), spring (12), and retainer (11).
8. Remove retainer (17), spring (16), and retainer (15).
9. Remove the O-ring seals from adjustment screw (9) and adjustment screw (10).

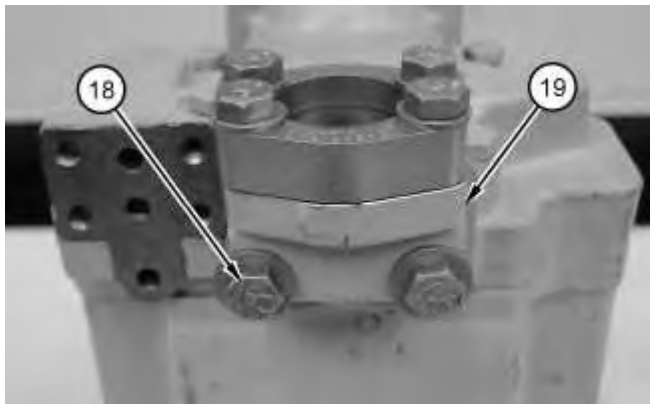

Illustration 7

g01145355

10. Remove bolts (18) and elbow (19).



Illustration 8

g01145356

Thank you so much for reading.  
Please click the “Buy Now!”  
button below to download the  
complete manual.



After you pay.

You can download the most  
perfect and complete manual in  
the world immediately.

Our support email:

[ebooklibonline@outlook.com](mailto:ebooklibonline@outlook.com)