



# Service Repair Manual

## **Models**

# 966F SERIES II WHEEL LOADER

---

Product: WHEEL LOADER

Model: 966F WHEEL LOADER 7HL

Configuration: 966 F SERIES II WHEEL LOADER (LOGGING ARRANGEMENT) 7HL00001-UP (MACHINE)

## Disassembly and Assembly 966F WHEEL LOADER VEHICLE SYSTEMS

Media Number -SEN4779-01

Publication Date -01/03/2004

Date Updated -24/10/2005

SEN47790018

### Pilot And Hydraulic Pump

SMCS - 5073-010; 5073-015; 5073-016

### Remove & Install Pilot And Hydraulic Pump



**WARNING**

**Release the pressure from the hydraulic system before any lines are removed or disconnected.**

**NOTE:** Identify all hydraulic lines as they are removed to aid in the proper installation. Cap and plug all lines and fittings as they are removed to prevent excess fluid loss and contamination.

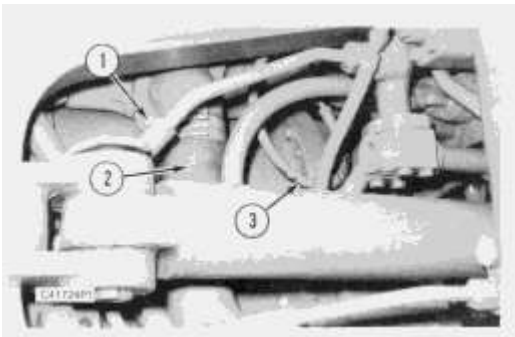

1. Remove four bolts and washers (1) and line (2).
2. Remove line (3) from the front of the pump.

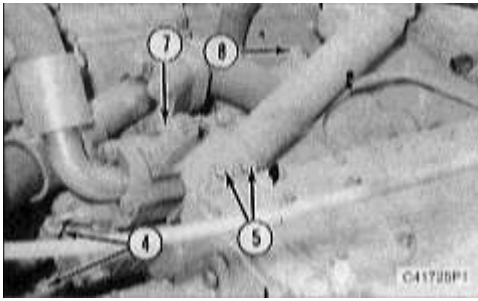

3. Remove two lines (4). Remove four bolts and washers (8) and the hydraulic line.
4. Remove four bolts and washers (5) and disconnect wire harness (7).

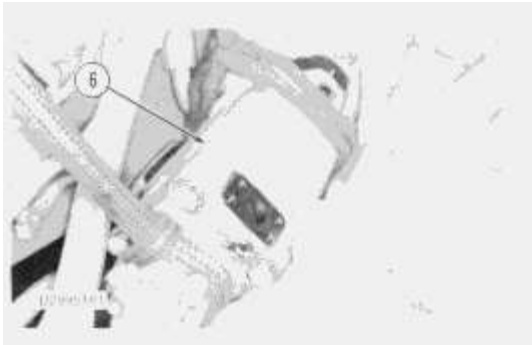

5. Open the access door behind the cab. Fasten a hoist to the pump and remove the two bolts and hydraulic pump (6). The weight of the pump is **68 kg (150 lb)**.

**NOTE:** To install pilot and hydraulic pump, reverse the removal steps.

## Disassemble Pilot And Hydraulic Pump

Tools Needed		A	B
1P1859	Pliers	1	
1P0510	Driver Group		1

Start By:

- a. remove pilot and hydraulic pump



1. Remove pilot oil pump (1) from the hydraulic pump.

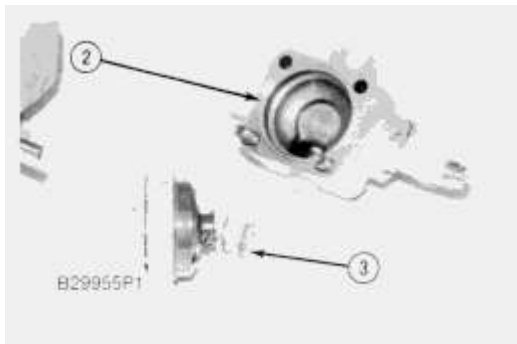

2. Remove cover (2) and spring (3) from the pump.

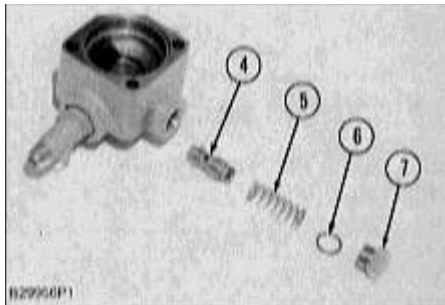

**WARNING**

**Spring (5) is under compression behind plug (7).**

3. Remove plug (7), spring (5) and spool assembly (4).

4. Remove O-ring seal (6) from the plug.

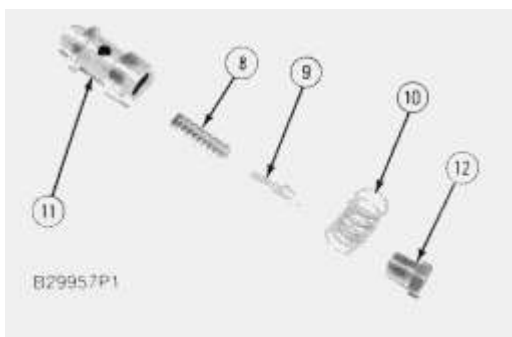

**WARNING**

**Spring (8) is under compression behind bolt (12).**

5. Remove bolt (12), spring (10), valve (9) and spring (8) from valve spool (11).

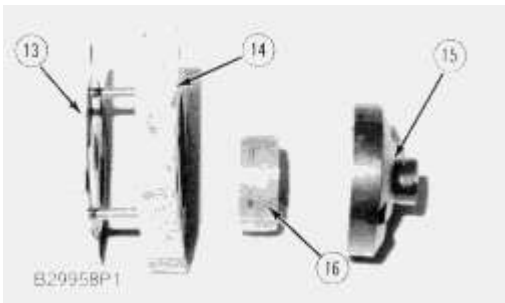

6. Remove plate (15) and rotor assembly (16) from the ring.
7. Remove ring (14) and the dowels from adapter (13).
8. Remove the O-ring seals from the adapter and the plate.

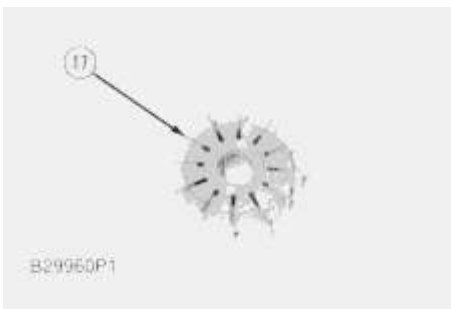

9. Remove vanes (17) from the rotor.

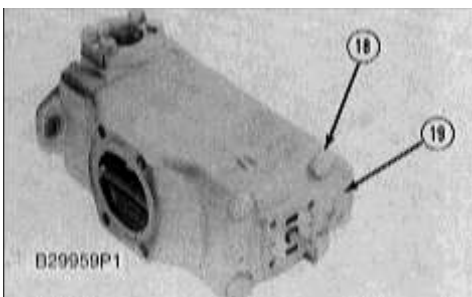

10. Scribe a line on the housings for assembly purposes and remove four bolts (18). Make a separation of cartridge assembly (19) from the pump.

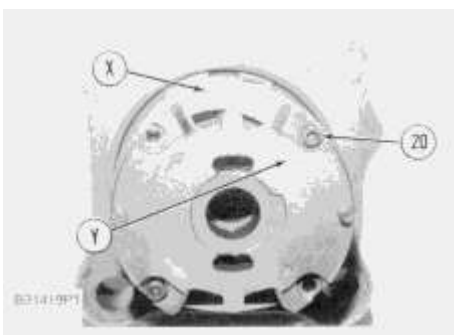

**NOTE:** Make a note of the direction of the arrows at locations (X) and (Y) and the location of bolts (20) for assembly purposes.

11. Remove the cartridge and the O-ring seal from the housing.

Thank you so much for reading.  
Please click the “Buy Now!”  
button below to download the  
complete manual.



After you pay.

You can download the most  
perfect and complete manual in  
the world immediately.

Our support email:

[ebooklibonline@outlook.com](mailto:ebooklibonline@outlook.com)