



Service Repair Manual

Models

993K Wheel Loader

Product: WHEEL LOADER

Model: 993K WHEEL LOADER Z8D

Configuration: 993K Wheel Loader Z8D00001-UP (MACHINE) POWERED BY C32 Engine

Disassembly and Assembly C27 and C32 Engines for Caterpillar Built Machines

Media Number -KENR8148-13

Publication Date -01/09/2018

Date Updated -05/09/2018

i06750410

Inlet and Exhaust Valves - Remove and Install

SMCS - 1105-010

Removal Procedure

Table 1

Required Tools			
Tool	Part Number	Part Description	Qty
A	5S-1330	Valve Spring Compressor	1
B	441-0714	Tool As	1

Start By:

- Remove the cylinder head.

NOTICE

Keep all parts clean from contaminants.

Contaminants may cause rapid wear and shortened component life.

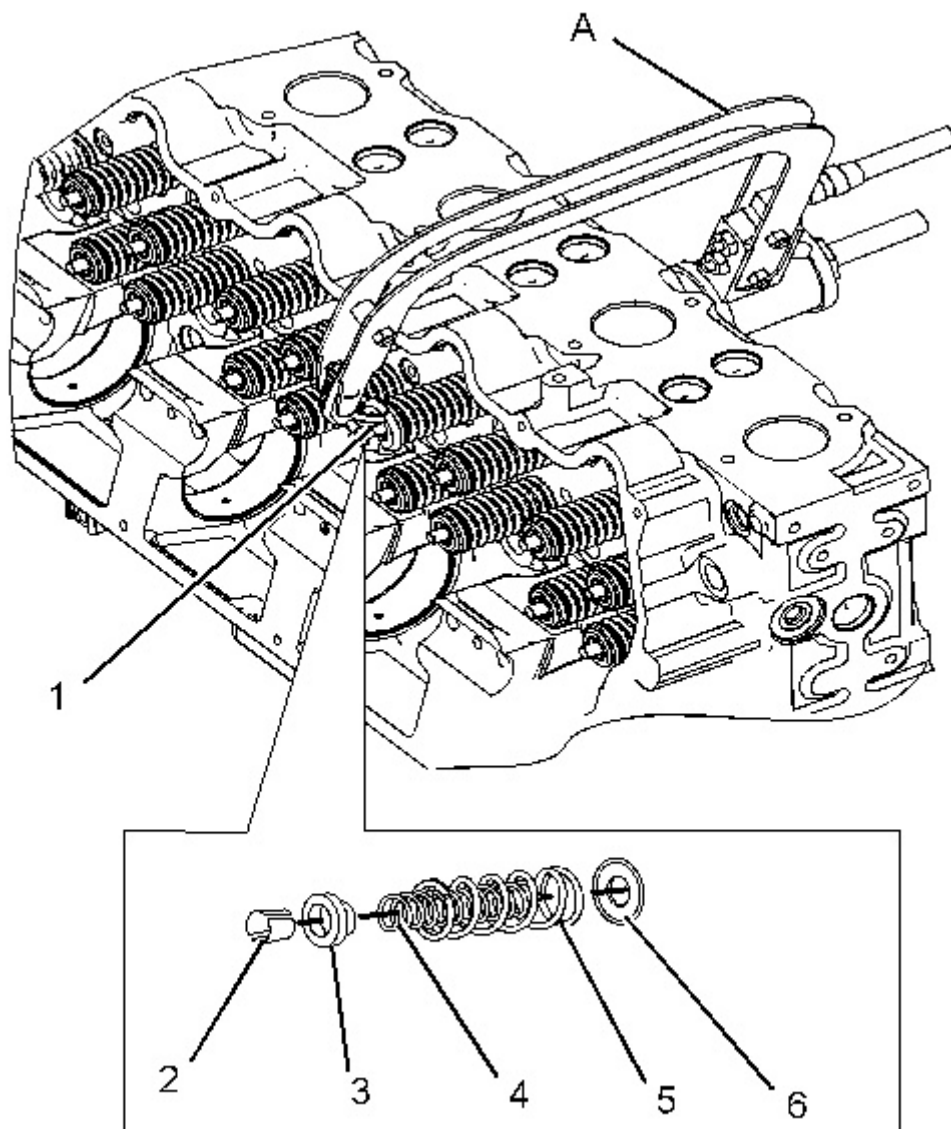

Illustration 1

g01015263

WARNING

Personal injury can result from being struck by parts propelled by a released spring force.

Make sure to wear all necessary protective equipment.

Follow the recommended procedure and use all recommended tooling to release the spring force.

1. Install Tooling (A) and compress the valve springs. Remove valve spring keepers (2) from valve (1).

2. Carefully remove Tooling (A) from valve (1).
3. Remove valve rotator (3).
4. Remove outer valve spring (5) and inner valve spring (4) from valve (1).
5. Remove washer (6) and valve (1) from the valve guide.
6. Use Tooling (B) to check the valve springs (spring force). Refer to Specifications, "Cylinder Head Valves" for additional information on the valve springs.
7. Inspect the valves. Refer to Specifications, "Cylinder Head Valves" for additional information on the inlet and exhaust valves.

Installation Procedure

Table 2

Required Tools			
Tool	Part Number	Part Description	Qty
A	5S-1330	Valve Spring Compressor	1

NOTICE

Keep all parts clean from contaminants.

Contaminants may cause rapid wear and shortened component life.

Note: A small amount of grease can be used to hold the retainer locks in position during installation.

1. Lubricate the valves with clean engine oil. Install the valves in the cylinder head.
-

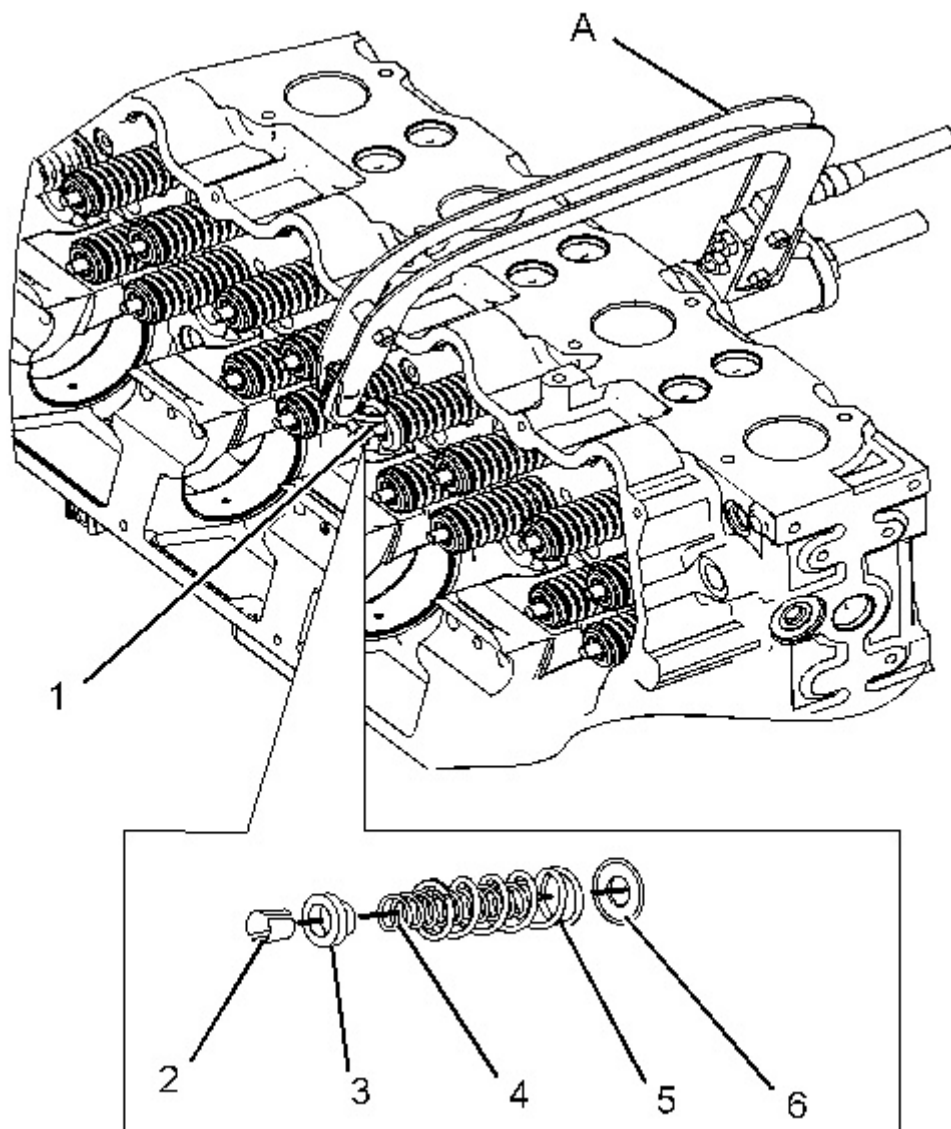

Illustration 2

g01015263

WARNING

Improper assembly of parts that are spring loaded can cause bodily injury.

To prevent possible injury, follow the established assembly procedure and wear protective equipment.

2. Install washer (6) on the valve guide.
3. Install inner valve spring (4) and outer valve spring (5) on valve (1).
4. Install valve rotator (3) on valve (1).

Thank you so much for reading.
Please click the “Buy Now!”
button below to download the
complete manual.



After you pay.

You can download the most
perfect and complete manual in
the world immediately.

Our support email:

ebooklibonline@outlook.com