

Product: TRACK-TYPE TRACTOR

Model: D6N TRACK-TYPE TRACTOR AKM

Configuration: D6N XL, D/S, LGP TRACK-TYPE TRACTOR AKM00001-UP (MACHINE) POWERED BY 3126B Engine

## Disassembly and Assembly D6N Track-Type Tractor Power Train

Media Number -REN5257-04

Publication Date -01/12/2015

Date Updated -15/12/2015

i02462212

# Transmission and Bevel Gears - Connect

SMCS - 3010-077

## Connection Procedure

Table 1

Required Tools			
Tool	Part Number	Part Description	Qty
A	1P-2420	Transmission Repair Stand	1
B	138-7575	Link Bracket	2

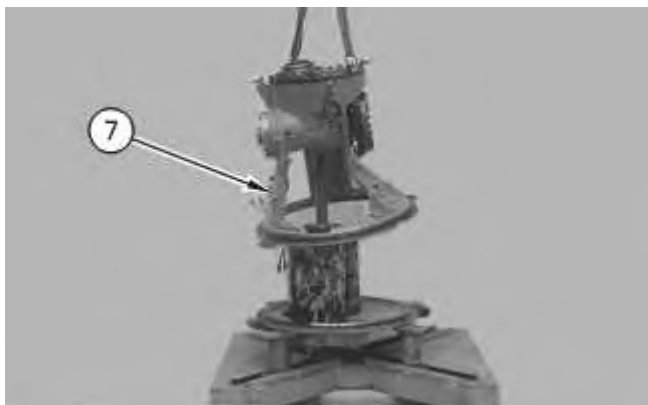

Illustration 1

g00955946

1. Attach Tooling (B) and a suitable lifting device to bevel and transfer gears (7). Position bevel and transfer gears (7). The weight of bevel and transfer gears (7) is approximately 249 kg (550 lb).



Illustration 2

g00955945

2. Install bolts (6).



Illustration 3

g00955942

3. Install bolt (5). Connect harness assembly (4).

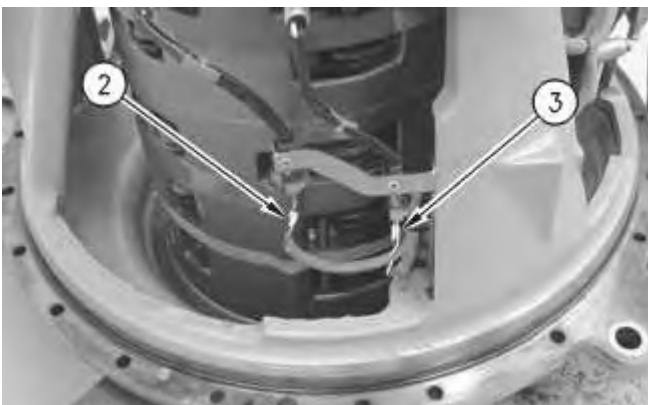
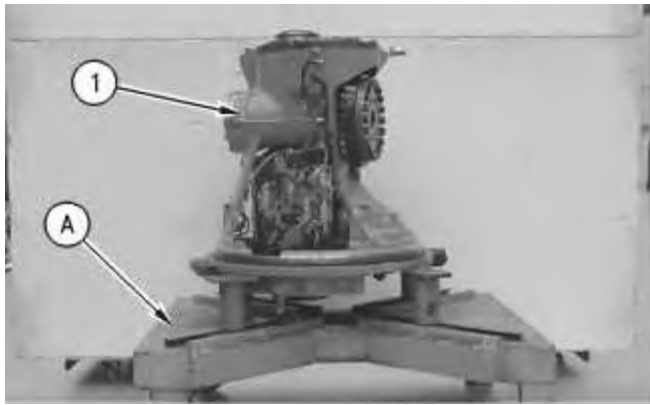

Illustration 4

g00955943

4. Connect harness assemblies (3) and (2).



---

Illustration 5

g00955941

5. Remove the transmission and bevel gears (1) from Tooling (A).

**End By:**

- a. Install the transmission and bevel gears. Refer to Disassembly and Assembly, "Transmission and Bevel Gears - Install".
-

Product: TRACK-TYPE TRACTOR

Model: D6N TRACK-TYPE TRACTOR AKM

Configuration: D6N XL, D/S, LGP TRACK-TYPE TRACTOR AKM00001-UP (MACHINE) POWERED BY 3126B Engine

## Disassembly and Assembly D6N Track-Type Tractor Power Train

Media Number -REN5257-04

Publication Date -01/12/2015

Date Updated -15/12/2015

i02462294

# Bevel and Transfer Gears - Disassemble

SMCS - 3011-015

## Disassembly Procedure

Table 1

Required Tools			
Tool	Part Number	Part Description	Qty
A	1P-2420	Transmission Repair Stand	1
B	5F-7343	Bearing Puller Gp	1
C	8T-2839	Spanner Wrench	1

### Start By:

- a. Separate the transmission and bevel gears. Refer to Disassembly and Assembly, "Transmission and Bevel Gears - Separate".
-

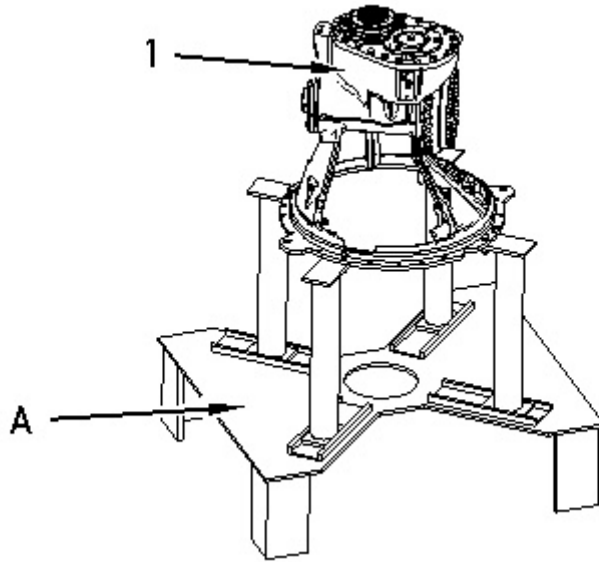

---

Illustration 1

g00959670

1. Mount bevel and transfer gears (1) onto Tooling (A).

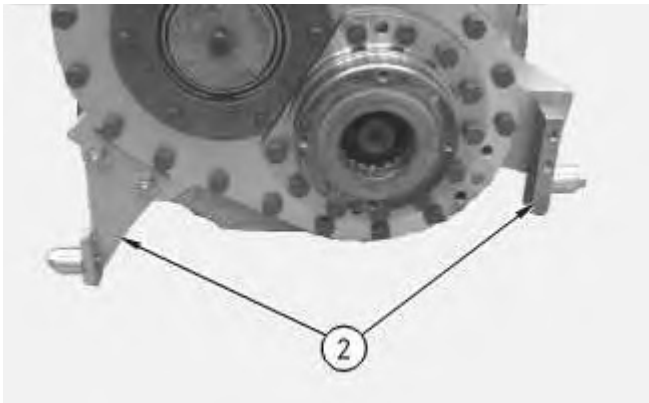

---

Illustration 2

g00954579

2. Remove bracket assemblies (2).
-

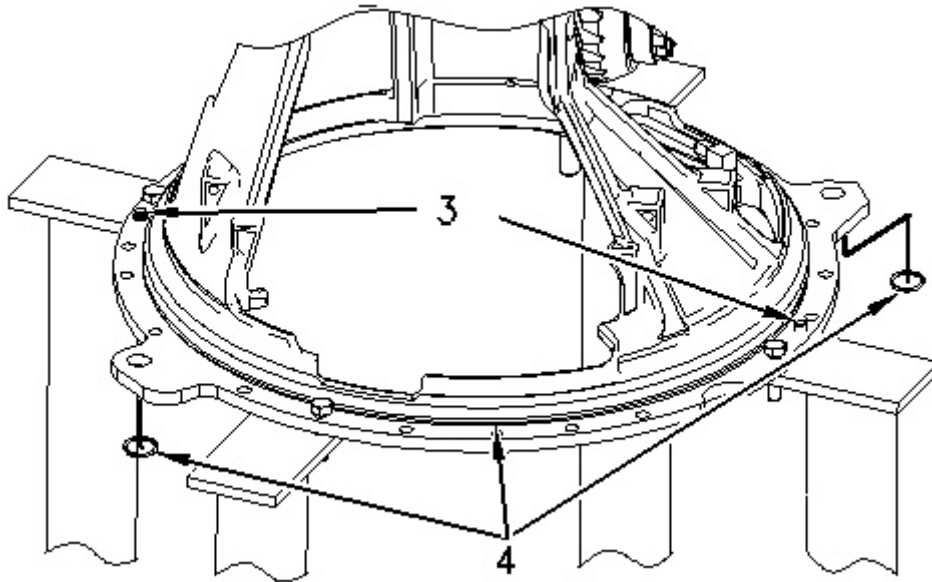

Illustration 3

g00954580

3. Remove O-ring seals (4).
4. If necessary, remove pins (3).

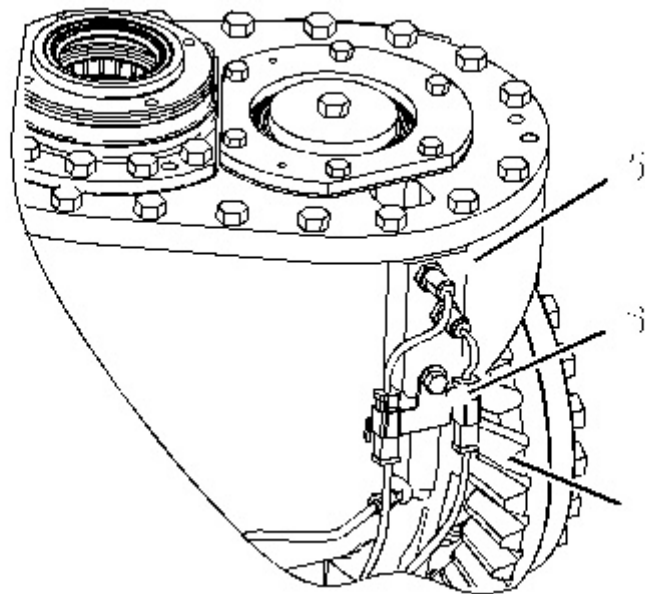
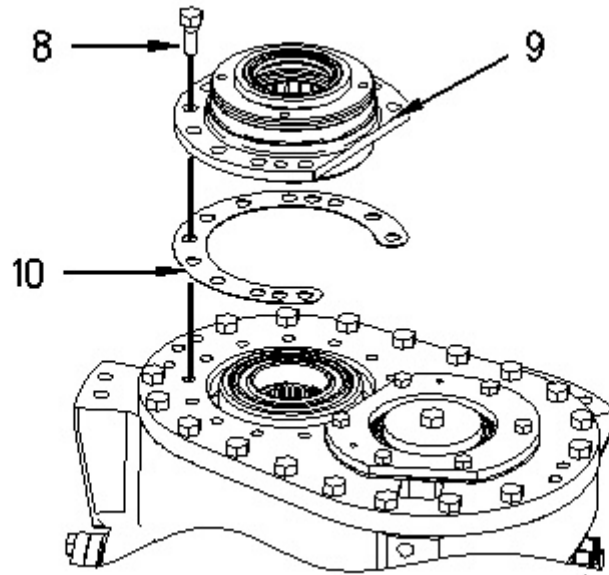

Illustration 4

g01228572

5. Disconnect harness assemblies (7), sensors (5), and bracket (6).



---

Illustration 5

g00954584

6. Remove bolts (8). Use two bolts (8) in order to remove cage (9).
7. Remove shims (10).

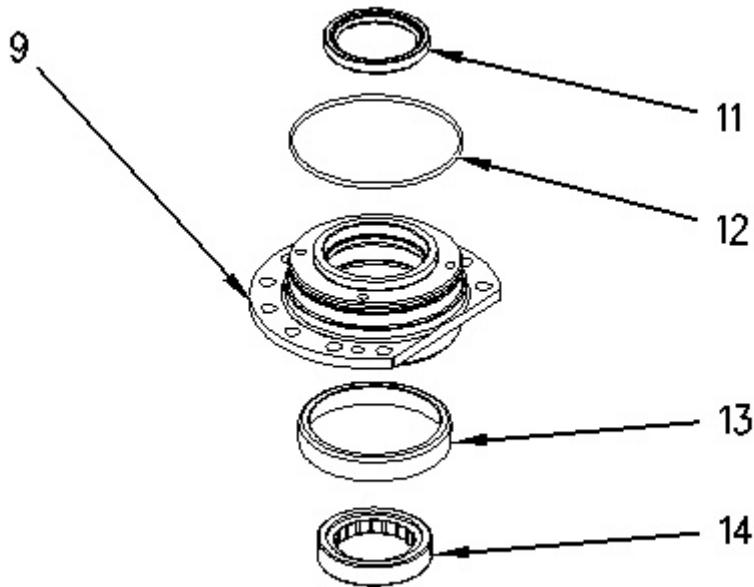

---

Illustration 6

g00994151

8. Remove O-ring seal (12), seal (11), bearing (14), and bearing cup (13) from cage (9).
-

Thank you so much for reading.  
Please click the “Buy Now!”  
button below to download the  
complete manual.



After you pay.

You can download the most  
perfect and complete manual in  
the world immediately.

Our support email:

[ebooklibonline@outlook.com](mailto:ebooklibonline@outlook.com)