



# Service Repair Manual

## **Models**

# D6N TRACK-TYPE TRACTOR

---

Product: TRACK-TYPE TRACTOR

Model: D6N TRACK-TYPE TRACTOR DJA

Configuration: D6N TRACK-TYPE TRACTOR XL, LGP Differential Steering DJA00001-UP (MACHINE) POWERED BY C6.6 Engine

## Disassembly and Assembly D6N Track-Type Tractor Power Train

Media Number -KENR5137-08

Publication Date -01/07/2018

Date Updated -25/07/2018

i04902472

# Steering Planetary and Brake - Disassemble

SMCS - 4132-015

## Disassembly Procedure

Table 1

Required Tools			
Tool	Part Number	Part Description	Qty
A	138-7575	Link Bracket	3
B	1P-0520	Driver Group	1
C	-	3/8 × 16 Forcing Screw	3

### Start By:

- Remove the right hand final drive, the planetary group, and the brake. Refer to Disassembly and Assembly, "Final Drive, Steering Planetary, and Brake (Right Side) - Remove".

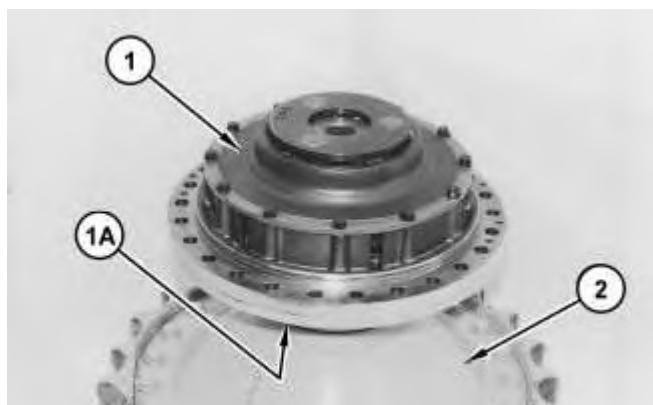

Illustration 1

g01234433

1. Position the final drive, the planetary group, and the brake.
2. Remove bolts (1A) (not shown) that hold the planetary group and brake (1) to final drive (2).
3. Attach Tooling (A) and a suitable lifting device (not shown) to the planetary group and brake (1).
4. Install Tooling (C) in the final drive hub.
5. Tighten Tooling (C) evenly in order to separate the planetary group and brake (1) from final drive (2). The weight of the planetary group and brake (1) is approximately 136 kg (300 lb).



---

Illustration 2

g00622109



## WARNING

**Personal injury can result from parts and/or covers under spring pressure.**

**Spring force will be released when covers are removed.**

**Be prepared to hold spring loaded covers as the bolts are loosened.**

---

6. Remove bolts (3).
  7. Remove ring gear (4) from housing (5).
-



Illustration 3

g01234571

8. Remove friction discs (6) and the brake plates from housing (5).

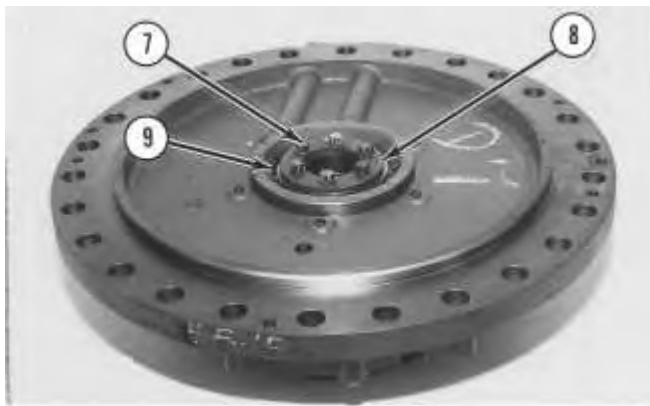

Illustration 4

g00622111

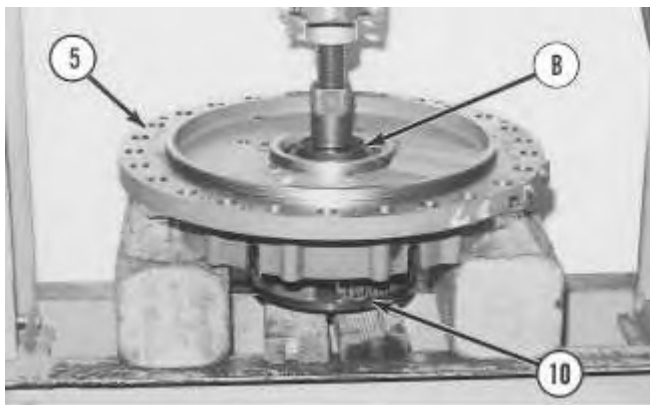

Illustration 5

g00622113

9. Remove bolts (7) and plate (8).

**Note:** Do not allow carrier (10) to fall when the carrier is pressed from housing (5).

**Note:** If a shim pack is present between the plate (9) and planetary carrier (10). Reuse the same shim pack during assembly only if reusing the same planetary carrier (10). If a new planetary carrier (10) is being used the shim pack should be discarded.

10. Use a suitable press and Tooling (B) to remove carrier (10) from housing (5).
11. Remove bearing cone (9) from housing (5).



Illustration 6

g00622127

12. Remove ring (14) from planetary carrier (11).
13. Remove bolts (13).
14. Remove slinger (12) from planetary carrier (11).

---

### NOTICE

**The component is destroyed if the component is removed.**

---

15. If necessary, remove bearing cone (15) from planetary carrier (11).



Illustration 7

g00996861

16. Use a hammer and a suitable punch to push pin (21) in shaft (20).
-

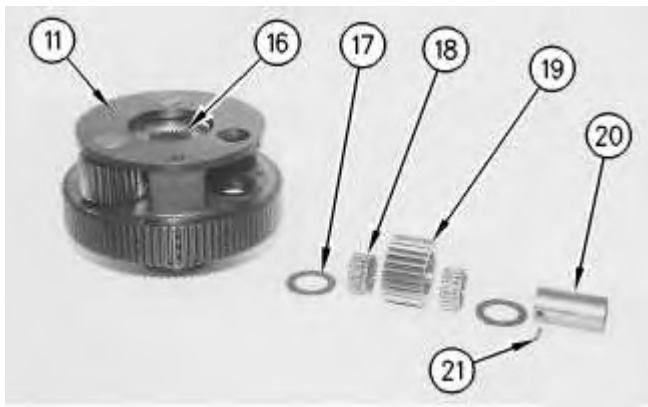

Illustration 8

g00996857

17. Remove shaft (20), planetary gear (19), discs (17), and bearings (18) from planetary carrier (11).
18. Remove pin (21) from shaft (20).
19. Repeat Steps 16 through 18 for the remaining planetary gears.
20. Remove sun gear (16) from planetary carrier (11).



Illustration 9

g00622132



**WARNING**

**Personal injury can result from parts and/or covers under spring pressure.**

**Spring force will be released when covers are removed.**

**Be prepared to hold spring loaded covers as the bolts are loosened.**

21. Remove bolts (22) and the washers.

22. Remove retainer (23) from piston (24).



Illustration 10

g00996858

23. If necessary, remove bearing cups (25) from retainer (23).

24. Remove seal ring (26) from the retainer.



Illustration 11

g00622156

25. Remove piston (24) and O-ring seal (27) from the housing.



Illustration 12

g00996860

26. Remove seal ring (28) from piston (24).

Thank you so much for reading.  
Please click the “Buy Now!”  
button below to download the  
complete manual.



After you pay.

You can download the most  
perfect and complete manual in  
the world immediately.

Our support email:

[ebooklibonline@outlook.com](mailto:ebooklibonline@outlook.com)