



Service Repair Manual

Models

M313C WHEELED Excavator

Product: WHEELED EXCAVATOR

Model: M313C WHEELED EXCAVATOR H2A

Configuration: M313C Excavator H2A00001-UP (MACHINE) POWERED BY 3054E Engine

Disassembly and Assembly

M313C Wheeled Excavator Power Train

Media Number -REN8617-00

Publication Date -01/04/2006

Date Updated -17/04/2006

i02405149

Travel Brake Valve - Assemble

SMCS - 4265-016

Assembly Procedure

NOTICE

Keep all parts clean from contaminants.

Contamination of the hydraulic system with foreign material will reduce the service life of the hydraulic system components.

To prevent contaminants from entering the hydraulic system, always plug or cap the lines, fittings, or hoses as they are disconnected. Cover any disassembled components and clean them properly before assembly.

Clean the hydraulic system properly after any major component exchange or especially after a component failure, to remove any contamination.

Note: Cleanliness is an important factor. Before the assembly procedure, the exterior of the component should be thoroughly cleaned. This will help to prevent dirt from entering the internal mechanism.

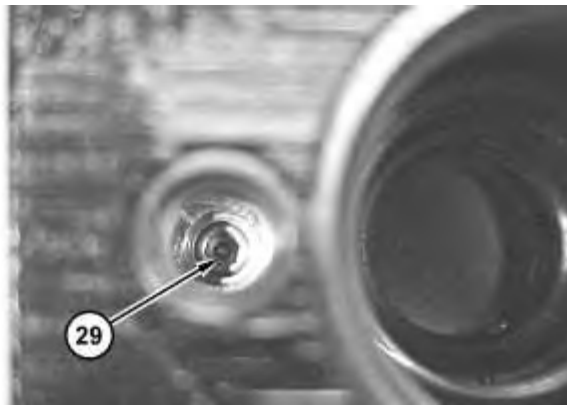

Illustration 1

g01185275

1. Install shuttle valve (29).

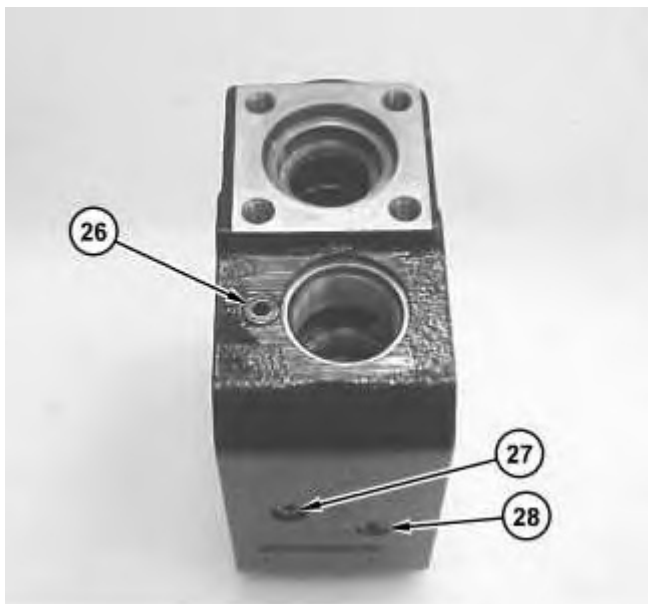
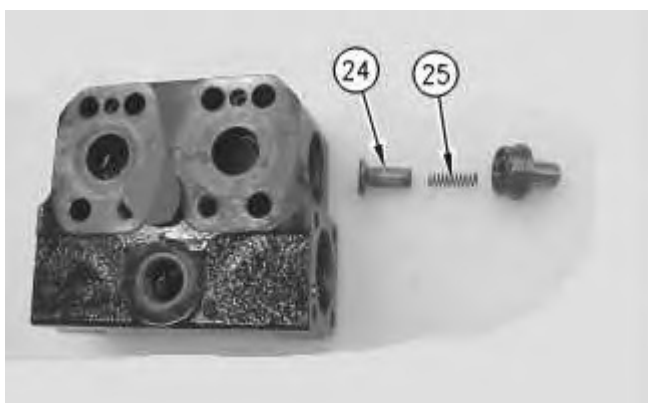

Illustration 2

g01185274

2. Install the O-ring seals on plugs (26), (27), and (28). Install plugs (26), (27), and (28). Tighten plugs (26), (27), and (28) to a torque of 20 N·m (15 lb ft).



3. Install piston (24) and spring (25).

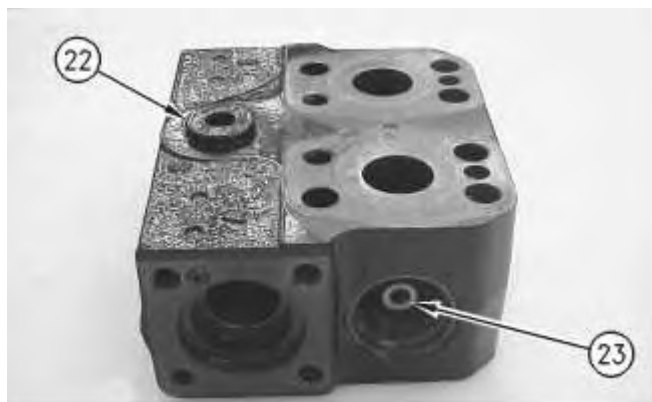

Illustration 4



Improper assembly of parts that are spring loaded can cause bodily injury.

To prevent possible injury, follow the established assembly procedure and wear protective equipment.

4. Install poppet (23).
5. Repeat Steps 3 through 4 for the opposite side of the valve.
6. Install plug (22) and the O-ring seal. Tighten plug (22) to a torque of 90 N·m (66 lb ft).

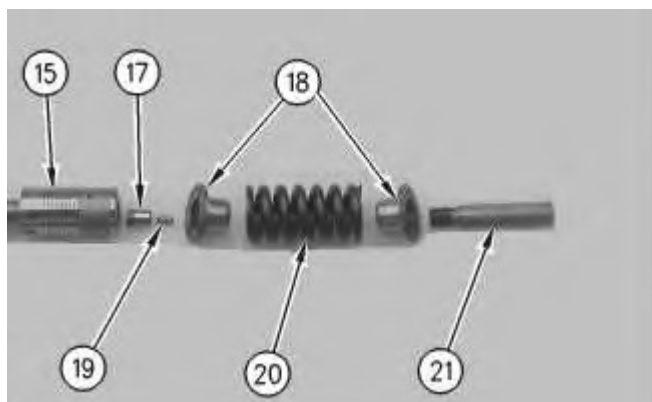

Illustration 5



WARNING

Improper assembly of parts that are spring loaded can cause bodily injury.

To prevent possible injury, follow the established assembly procedure and wear protective equipment.

7. Install piston (17), piston (19), spring (20), spring seats (18), and retaining bolt (21) onto valve assembly (15).

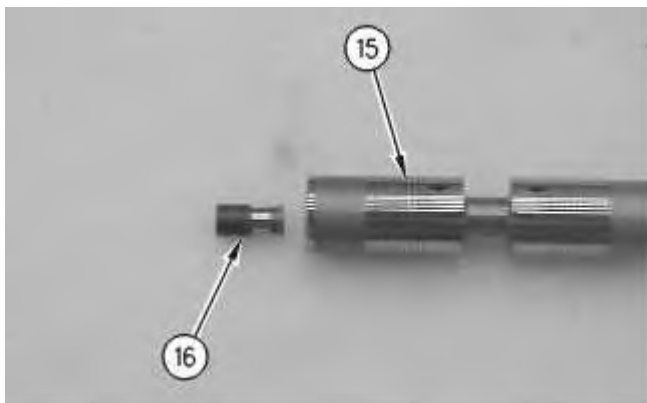

Illustration 6

g00893669

8. Install plug (16) into valve assembly (15).

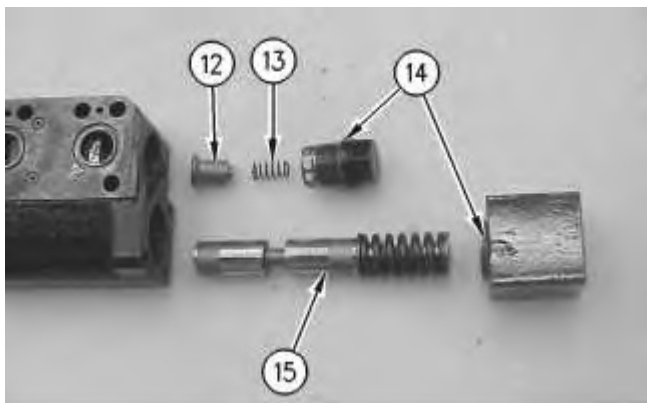

Illustration 7

g00893668

9. Install valve assembly (15).
 10. Install piston (12) and spring (13).
 11. Install O-ring seals (14).
-

Thank you so much for reading.
Please click the “Buy Now!”
button below to download the
complete manual.



After you pay.
You can download the most
perfect and complete manual in
the world immediately.

Our support email:
ebooklibonline@outlook.com