

TM10259 - 17D Excavator Muffler Remove and Install

Muffler Remove and Install

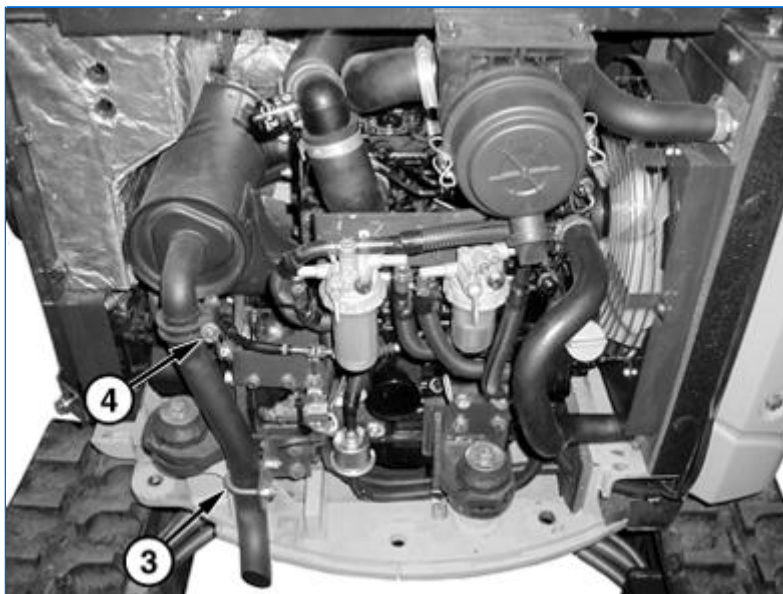

1. TX1018155A-UN: Side Panels



TX1018156A-UN: Exhaust Pipe

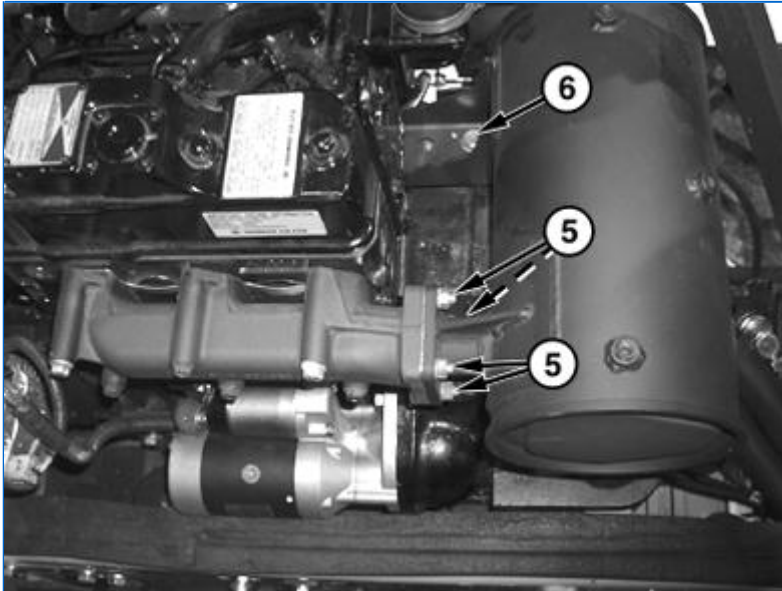

T207372A-UN: Muffler

LEGEND:

- 1 - Side Panel
- 2 - Side Panel
- 3 - Exhaust Pipe Clamp
- 4 - Exhaust Pipe-to-Muffler Clamp
- 5 - Muffler-to-Exhaust Manifold Nut (4 used)
- 6 - Muffler Bracket Cap Screw

Park machine on level surface.

2. Remove side panels (1 and 2).
3. Remove counterweight. [See Counterweight Remove and Install](#) . (Group 1749.)

4. **NOTE:**

If exhaust pipe needs to be replaced, remove exhaust pipe-to-muffler clamp (4).

Remove exhaust pipe clamp (3).

5. Remove four muffler-to-exhaust manifold nuts (5) and washers.
6. Remove muffler bracket cap screw (6) and remove muffler.
7. Install muffler gasket and muffler.
8. Install muffler bracket cap screw (6).
9. Install muffler-to-exhaust manifold nuts (5) and tighten.

10. **NOTE:**

If removed, tighten exhaust pipe-to-muffler clamp (4).

Install exhaust pipe clamp (3).

11. Install counterweight and left-side panels. [See Counterweight Remove and Install](#) . (Group 1749.)

TM10259 - 17D Excavator Thermostat Remove and Install

Thermostat Remove and Install

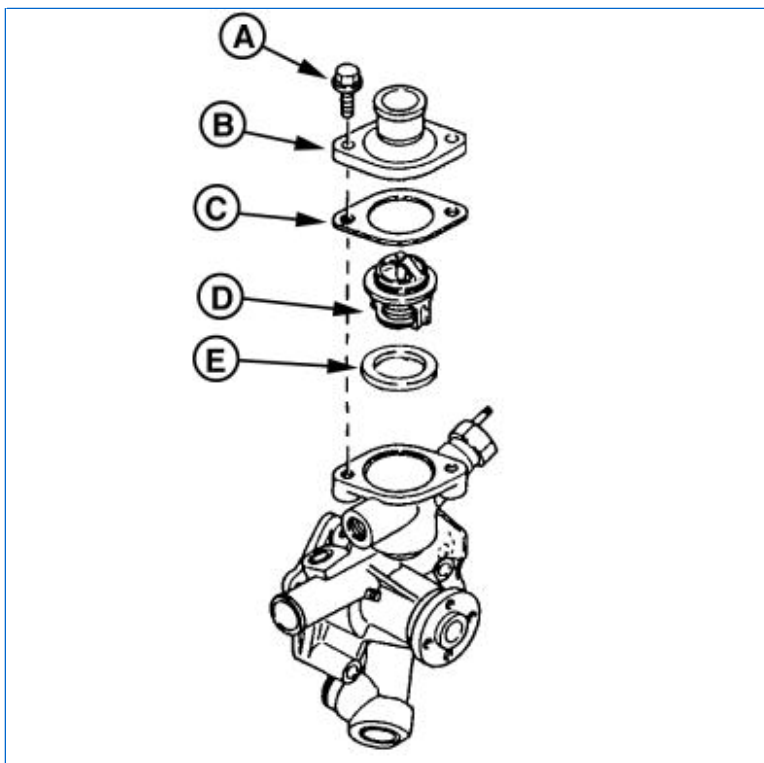

M82315A-UN: Thermostat

LEGEND:

- A - Thermostat Cover Cap Screw (2 used)
- B - Thermostat Cover
- C - Cover Gasket
- D - Thermostat
- E - Gasket

1. Remove counterweight. [See Counterweight Remove and Install](#) . (Group 1749.)
2. Drain cooling system into an appropriate container for storage or disposal. [See Draining Cooling System](#) . (Operator's Manual.)
3. Remove air cleaner assembly. [See Air Cleaner Assembly Remove and Install](#) . (Group 0400.)
4. Remove thermostat cover cap screws (A).
5. Remove thermostat cover (B), cover gasket (C), thermostat (D), and gasket (E).
6. Test thermostat. [See Engine Thermostat Test](#) . (Group 9010-25.)
7. At installation, replace gaskets.
8. Install thermostat, gaskets, thermostat cover, and thermostat cover cap screws and tighten to specification.

Item	Measurement	Specification
Thermostat Cover Cap Screw	Torque	20 N·m 15 lb-ft

9. Fill cooling system. [See Cooling System Fill and Deaeration](#) . (Operator's Manual.)
10. Install counterweight. [See Counterweight Remove and Install](#) . (Group 1749.)

TM10259 - 17D Excavator Water Pump Remove and Install

Water Pump Remove and Install

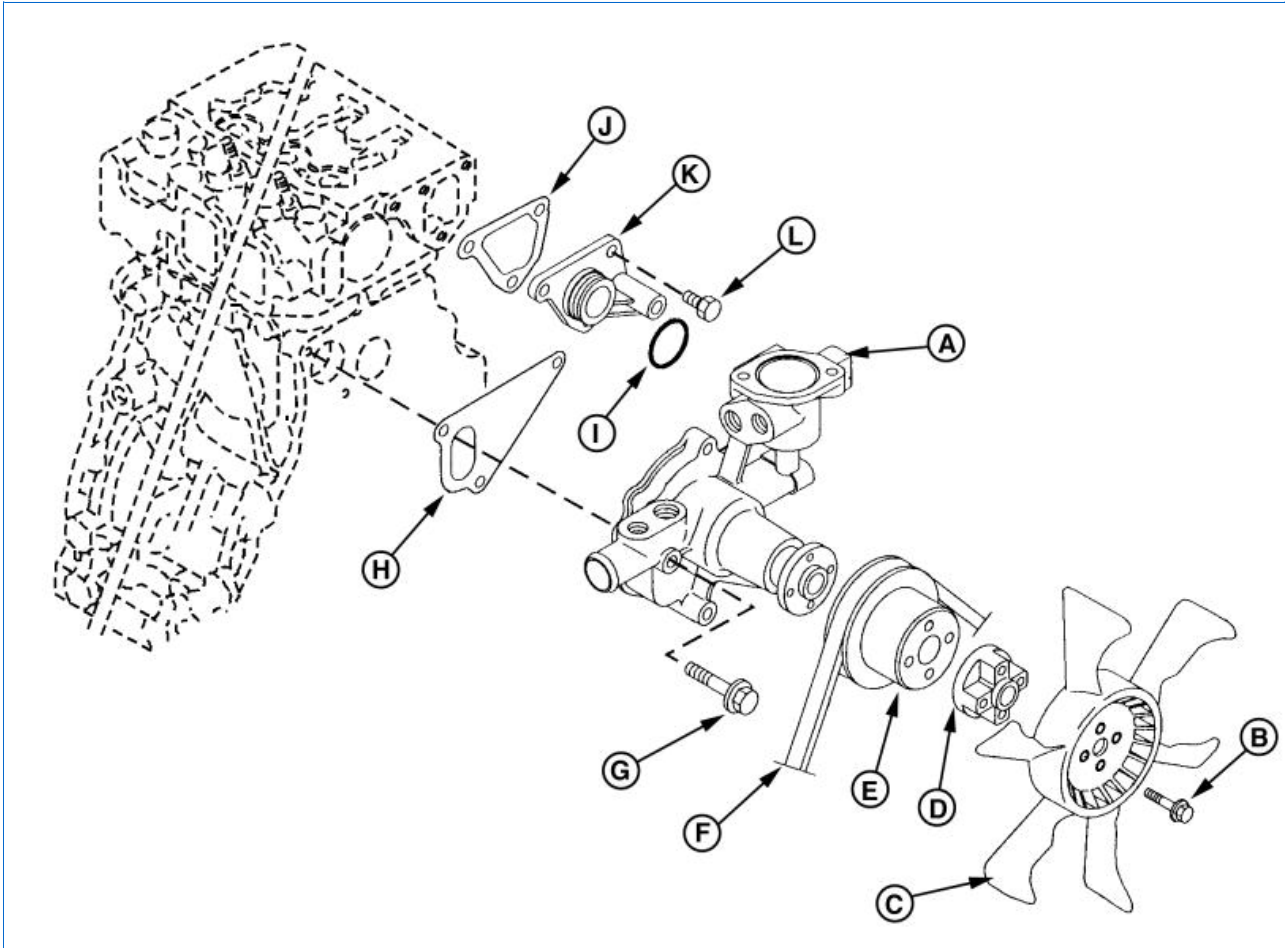

RG8583A-UN: Water Pump

LEGEND:

- A - Water Pump
- B - Fan-to-Water Pump Cap Screw (4 used)
- C - Fan
- D - Spacer
- E - Pulley
- F - Fan Belt
- G - Water Pump-to-Cylinder Head Cap Screw (4 used)
- H - Gasket
- I - O-Ring
- J - Gasket
- K - Ball Joint
- L - Cap Screw (3 used)

1. Drain cooling system into appropriate container for storage or disposal. [See Draining Cooling System](#) . (Operator's Manual.)

Item	Measurement	Specification
Cooling System	Capacity	2.9 L 3.0 qt

2. Remove counterweight. [See Counterweight Remove and Install](#) . (Group 1749.)
3. Remove radiator. [See Radiator Remove and Install](#) . (Group 0510.)
4. Remove thermostat and cover. [See Thermostat Remove and Install](#) . (Group 0400.)
5. Disconnect coolant temperature sensor leads.
6. Remove fan belt (F).

Thank you so much for reading.
Please click the “Buy Now!”
button below to download the
complete manual.



After you pay.

You can download the most
perfect and complete manual in
the world immediately.

Our support email:

ebooklibonline@outlook.com