

TM12894 - 35G Excavator

Sprocket Remove and Install

Sprocket Remove and Install

-: Specifications

SPECIFICATIONS	
Cap Screw Torque	110 N·m 81 lb.-ft.

-: Other Material

OTHER MATERIAL
7649 Loctite ® Klean N Prime
271 Loctite ® Thread Lock and Sealer (high strength)

1. **NOTE:**

Prevent excessive wear to track. Sprocket must be replaced when the tooth tips become excessively rounded, worn, or chipped. If machine is driven in one direction a majority of the time, wear will be on one side of teeth. To extend service life, change sprockets from one side of machine to the other.

Park and prepare machine for service safely. [See Park and Prepare for Service Safely](#) . (Group 0001.)

2. Remove track. [See Rubber Track Remove and Install](#) or [see Track Chain Remove and Install](#) . (Group 0130.)

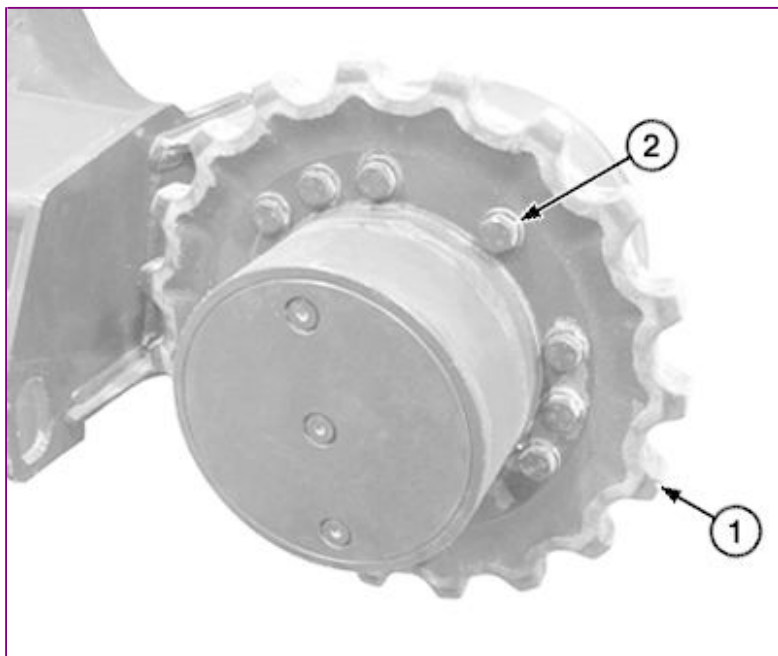

3. TX1133091A-UN: Sprocket

LEGEND:

- 1 - Sprocket
- 2 - Cap Screw (12 used)

Remove cap screws (2) and sprocket (1).

4. Repair or replace as necessary.
5. Apply PM37509 Klean N Prime and PM37421 Thread Lock and Sealer (high strength) to threads of cap screws.
6. Install sprocket.
7. Install cap screws and tighten to specification.

Item	Measurement	Specification
Cap Screw	Torque	110 N·m 81 lb.-ft.

8. Install track. [See Rubber Track Remove and Install](#) or [see Track Chain Remove and Install](#) . (Group 0130.)

TM12894 - 35G Excavator

Front Idler Remove and Install

Front Idler Remove and Install

-: Specifications

SPECIFICATIONS	
Front Idler Weight (approximate)	26 kg 58 lb.

1. Park and prepare machine for service safely. [See Park and Prepare for Service Safely](#) . (Group 0001.)
2. Remove track. [See Rubber Track Remove and Install](#) or [see Track Chain Remove and Install](#) . (Group 0130.)

3.



CAUTION:

Prevent possible crushing injury from heavy component. Use appropriate lifting device.



TX1132778A-UN: Front Idler

LEGEND:

- 1 - Front Idler
- 2 - Track Frame

Attach appropriate lifting device to support front idler (1).

Item	Measurement	Specification
Front Idler	Weight (approximate)	26 kg 58 lb.

4. Remove front idler from track frame (2).
5. Measure front idler wear. [See 35G Front Idler Flange Height](#) . (SP326VOL1 Undercarriage Appraisal Manual.)

6. Repair or replace as necessary. [See Front Idler Disassemble and Assemble](#) . (Group 0130.)

7.



CAUTION:

Prevent possible crushing injury from heavy component. Use appropriate lifting device.

Using an appropriate lifting device, install front idler.

Item	Measurement	Specification
Front Idler	Weight (approximate)	26 kg 58 lb.

8. Install track. [See Rubber Track Remove and Install](#) or [see Track Chain Remove and Install](#) . (Group 0130.)

9. Adjust track tension. [See Check Track Sag—Rubber Track](#) . (Operator's Manual.)

TM12894 - 35G Excavator
Front Idler Disassemble and Assemble

Front Idler Disassemble and Assemble

-: Specifications

SPECIFICATIONS	
Front Idler Weight (approximate)	26 kg 58 lb.
Yoke-to-Axle Cap Screw Torque	65 N·m 47 lb.-ft.
Yoke-to-Plate Cap Screw Torque	90 N·m 66 lb.-ft.

-: Other Material

OTHER MATERIAL	
NEVER-SEEZ® Anti-Seize Lubricant	
271 Loctite® Thread Lock and Sealer (high strength)	

1.



CAUTION:

Prevent possible crushing injury from heavy component. Use appropriate lifting device.

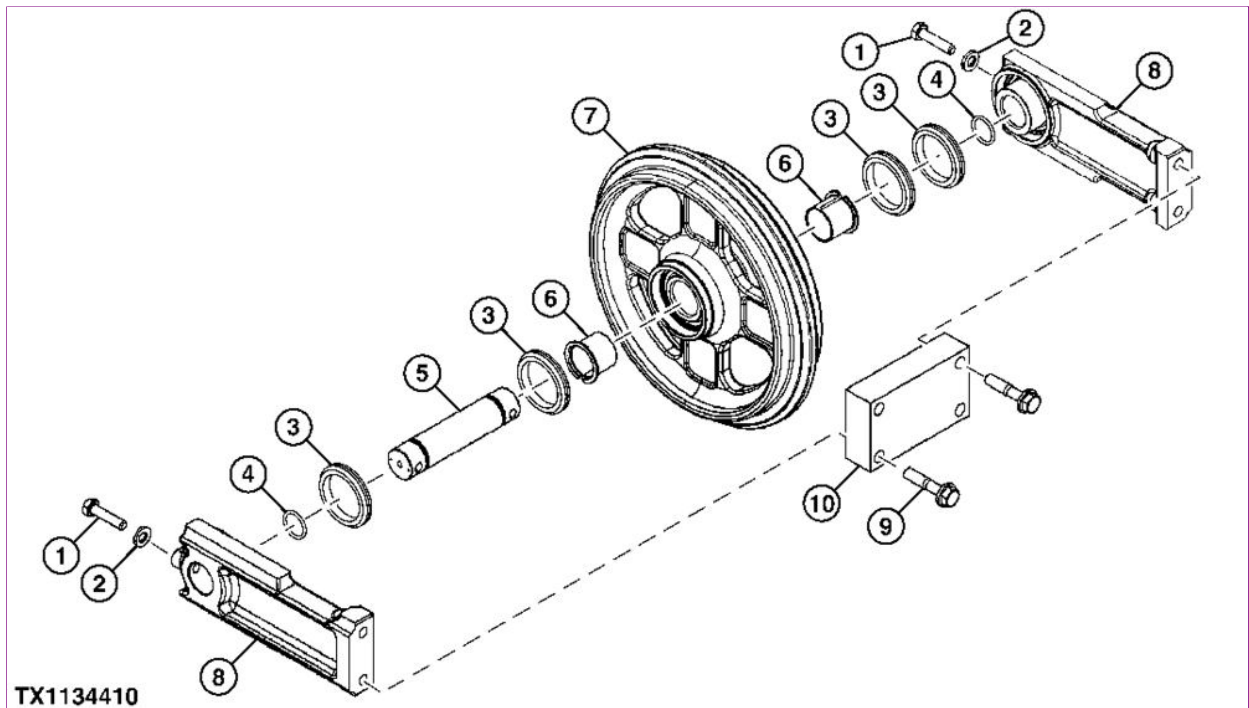

TX1134410

TX1134410-UN: Front Idler

LEGEND:

- 1 - Cap Screw (2 used)
- 2 - Washer (2 used)
- 3 - Metal Face Seal (2 used)
- 4 - O-Ring (2 used)
- 5 - Axle
- 6 - Bushing (2 used)
- 7 - Idler
- 8 - Yoke (2 used)
- 9 - Cap Screw (4 used)
- 10 - Plate

Remove front idler using appropriate lifting device. [See Front Idler Remove and Install](#) . (Group 0130.)

Item	Measurement	Specification
Front Idler	Weight (approximate)	26 kg 58 lb.

2. Remove cap screws (9) and plate (10).

3. Remove cap screws (1), washers (2), and yokes (8).

4. **NOTE:**

Thank you so much for reading.
Please click the “Buy Now!”
button below to download the
complete manual.



After you pay.

You can download the most
perfect and complete manual in
the world immediately.

Our support email:

ebooklibonline@outlook.com