

# TM1925 - 450CLC Excavator

## Track Carrier Roller

### Track Carrier Roller

#### Remove and Install Track Carrier Roller

NOTE:

[See Undercarriage Appraisal Manual for component wear measurements.](#)

1.



**CAUTION:**

*High pressure grease in track adjuster cylinder. Do not remove grease fitting or nut and valve assembly to release grease.*

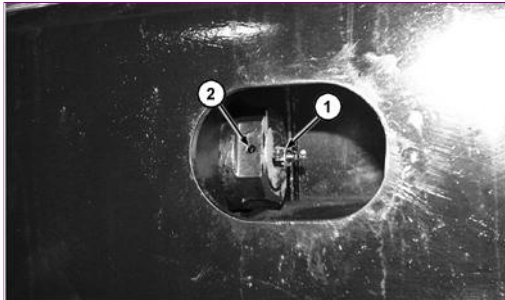

T138569B-UN: Nut and Valve Assembly

LEGEND:

- 1 - Nut and Valve Assembly
- 2 - Bleed Hole

Loosen nut and valve assembly (1) one turn to release grease from track adjuster cylinder through bleed hole (2).



2.

T6557DJ-UN: Jack and Wooden Blocks

Raise track link just enough to permit upper roller removal.

3.



**CAUTION:**

*Securely support track to prevent accidental lowering of track.*

Install wooden blocks between track link and frame.

4.



**CAUTION:**

*The approximate weight of track carrier roller is 35 kg (77 lb).*

Item	Measurement	Specification
Track Carrier Roller		
Track Carrier Roller	Weight	35 kg (77 lb) approximate

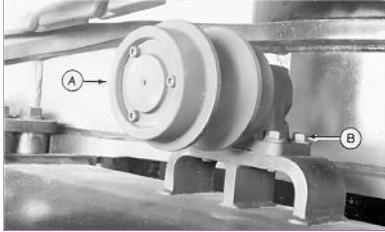

T7029AL-UN: Cap Screw and Roller

**LEGEND:**

- A - Upper Roller
- B - Cap Screw (4 used)

Remove cap screws (B) to remove upper roller (A).

5. Install upper roller (A). Tighten cap screws (B).

Item	Measurement	Specification
<b>Track Carrier Roller</b>		
Roller-to-Frame Cap Screw	Torque	393 N·m (290 lb-ft)

6. Check roller oil level by removing plug in cover. Add oil as necessary. (See Track Roller, Front Idler, and Carrier Roller Oil in Operator's Manual.) Approximate oil capacity is 120 mL (4 fl oz).
7. Remove wooden blocks and jack.
8. [Check and Adjust Track Sag](#) . (See Operator's Manual.)

**Disassemble and Assemble Track Carrier Roller**

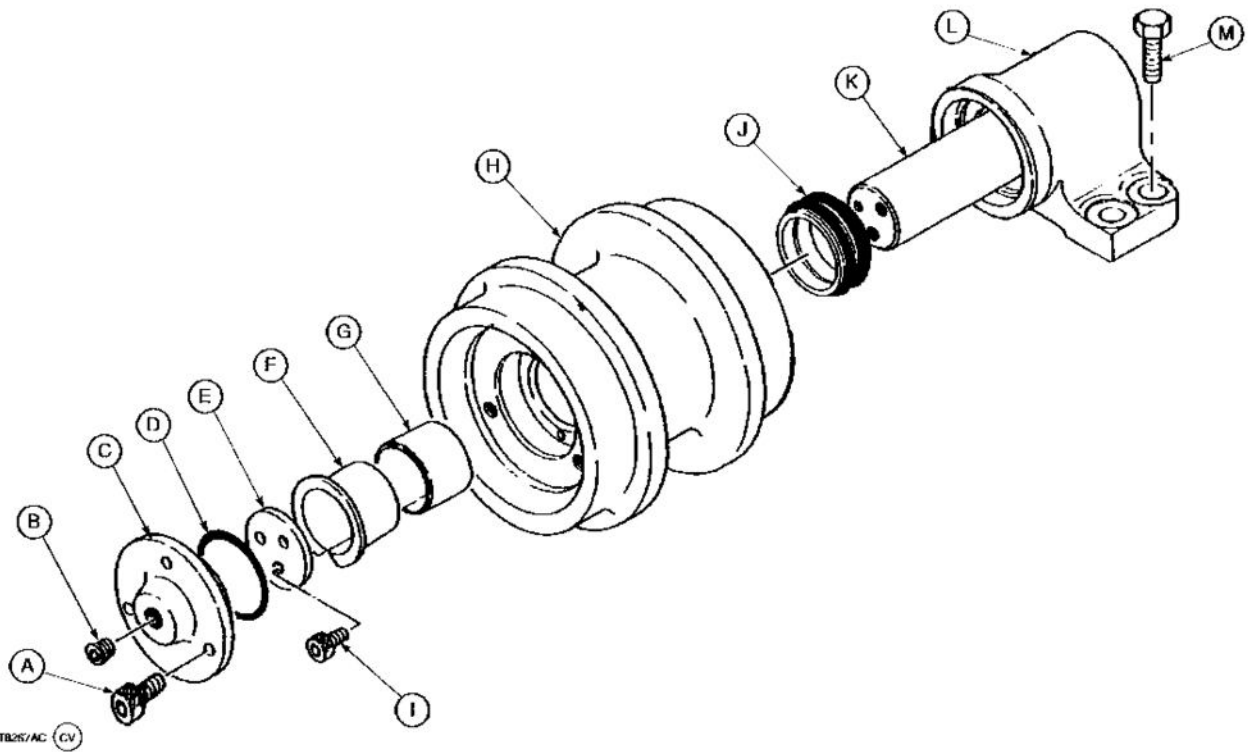

T8267AC-UN: Track Carrier Roller Assembly

**LEGEND:**

- A - Cap Screw (3 used)
- B - Plug
- C - Cover
- D - O-Ring
- E - Thrust Washer
- F - Bushing
- G - Bushing
- H - Roller
- I - Cap Screw (3 used)
- J - Metal Face Seal
- K - Axle
- L - Bracket
- M - Cap Screw (4 used)

1. Remove plug (B) to drain oil.
2. Remove parts (A, C—E and I) to remove roller (H).

3. **IMPORTANT:**

**Metal face seals can be reused if they are not worn or damaged. A seal must be kept together as a set because of wear patterns on seal ring face.**

Remove metal face seal (J) from roller (H) and bracket (L). Keep seal rings together as a matched set with faces together to protect lapped surfaces. [Inspect metal face seals](#). (See procedure in this group.)

4. Remove bushings (F and G) if replacement is necessary.

5. Replace parts as necessary.

6. Install bushing (F) in roller so flange is tight against shoulder. Install bushing (G).

7. **IMPORTANT:**

**O-rings and seat surfaces must be clean, dry, and oil free so O-rings do not slip when roller is turning.**

Thoroughly clean the O-rings and seat surfaces in roller, bracket, and seal rings using a volatile, non-petroleum base solvent and lint-free tissues.

8. Install O-ring on seal rings.

9. Install seal rings and O-rings as an assembly into bracket (L) and roller (H).

Apply equal pressure with the fingers at four equally spaced points on seal ring face. Seal must "pop"

into place so O-ring and seal ring is seated squarely in bore.

10. **NOTE:**

*A volatile, non-petroleum base solvent or talcum powder may be used as a lubricant.*

Clean seal ring face using clean oil and lint-free tissues. Apply a thin film of oil to each seal ring face.

11. Install roller (H) and thrust washer (E). Tighten cap screws (I).

Item	Measurement	Specification
<b>Track Carrier Roller</b>		
Thrust Washer-to-Axle Cap Screw	Torque	64 N·m (47 lb-ft)

12. Install O-ring (D) and cover (C). Tighten cap screws (A).

Item	Measurement	Specification
<b>Track Carrier Roller</b>		
Cover-to-Roller Cap Screw	Torque	64 N·m (47 lb-ft)

13. Fill roller with 120 mL (4 fl oz) of clean oil. See Track Roller, Front Idler, and Carrier Roller Oil. (See Operator's Manual.)

14. Apply cure primer and pipe sealant to threads of plug (B). Install plug.

# TM1925 - 450CLC Excavator Remove and Install Track Shoe

## Remove and Install Track Shoe

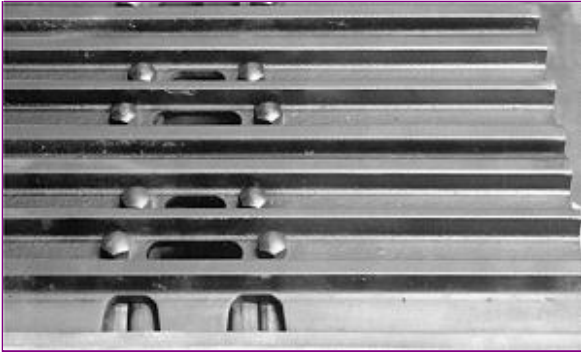

T6557DO-UN: Track Shoe Cap Screws

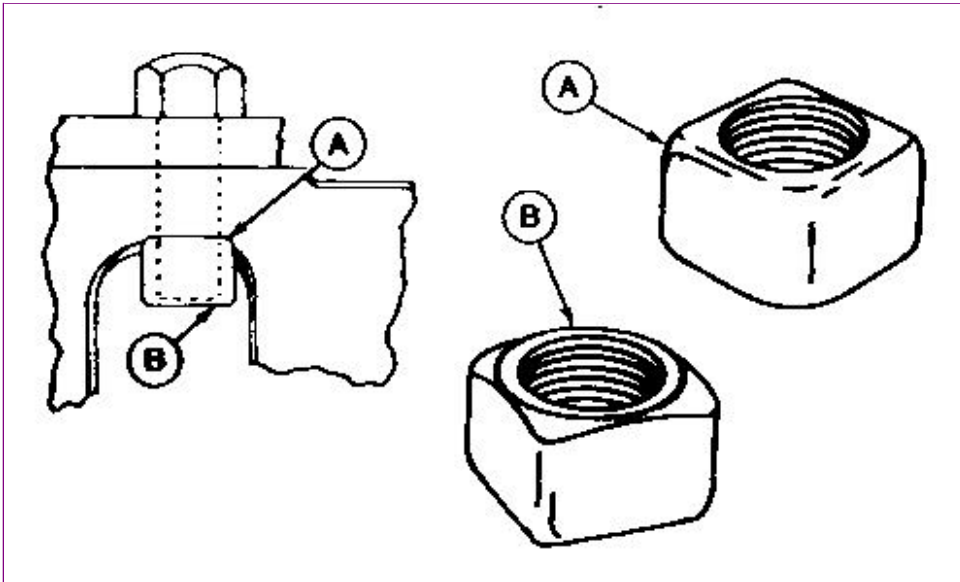

T6794AM-UN: Track Shoe Nuts

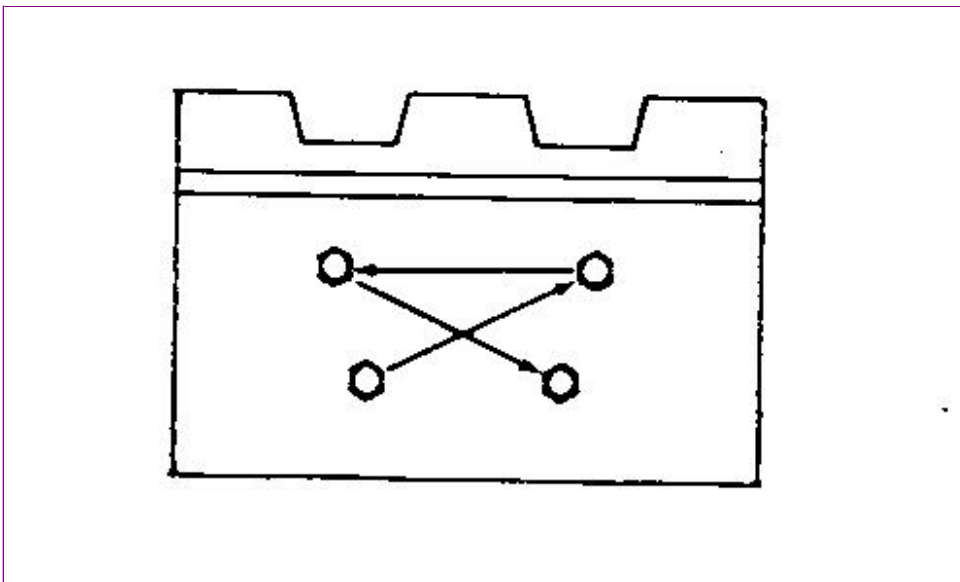

T6352AH-UN: Tightening Sequence

**LEGEND:**

- A - Rounded Edge
- B - Chamfered Edge

1. Remove nuts, cap screws, and shoe.
2. Apply a light coat of oil to cap screw threads and install shoe.
3. Install all track shoe nuts with rounded edges (A) against the link and chamfered edges (B) away from the link. Be sure nut is properly positioned in the link so there is full contact between the nut and the link.
4. Starting at any cap screw, tighten cap screws in sequence shown.

<b>Item</b>	<b>Measurement</b>	<b>Specification</b>
<b>Track Shoe</b>		
Shoe-to-Chain Cap Screw	Torque	1375 N·m (1015 lb-ft)

Thank you so much for reading.  
Please click the “Buy Now!”  
button below to download the  
complete manual.



After you pay.

You can download the most  
perfect and complete manual in  
the world immediately.

Our support email:

[ebooklibonline@outlook.com](mailto:ebooklibonline@outlook.com)