

RR2 TWO-ROW ROW-CROP CULTIVATOR



OPERATORS MANUAL RR2 TWO-ROW ROW-CROP CULTIVATOR

OMN159527 G9 English

**DES MOINES WORKS
OMN159527 G9**

LITHO IN THE U.S.A.
ENGLISH





Introduction



This safety alert symbol indicates important safety messages in this manual. When you see this symbol, be alert to the possibility of personal injury and carefully read the message that follows.

This operator's manual contains SI Metric equivalents which follow immediately after the U.S. customary units of measure.

"Right-hand" and "left-hand" sides are determined by facing in the direction the cultivator will travel when in use.

Your warranty appears on your copy of the purchase order which you should have received from your dealer.

Record your serial number on page 17.

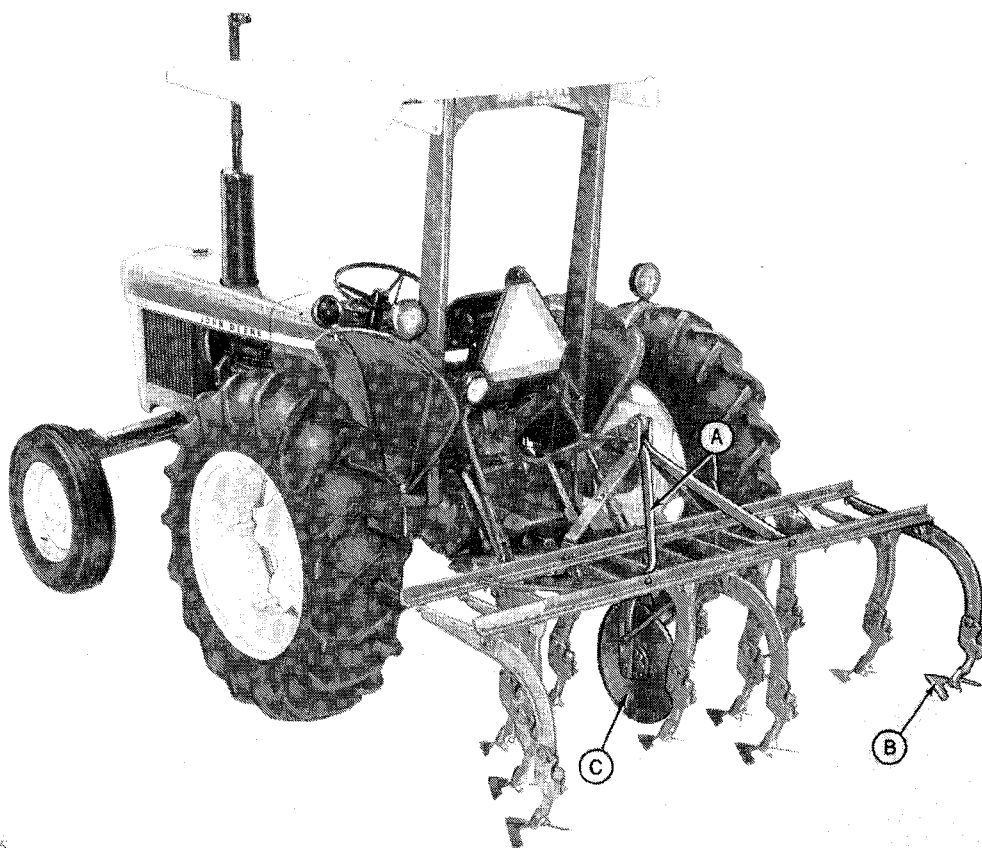

N28845

A—Hitch Mast

B—Sweep

C—Coulters

John Deere RR2, 2-Row Row-Crop Cultivator on John Deere 830 Tractor

RR2 CULTIVATOR

PREDELIVERY CHECK LIST

- ☐ Both reflectors installed.
- ☐ All customer-ordered attachments are installed.
- ☐ The correct customer-ordered sweeps or shovels are installed.
- ☐ All grease fittings have been lubricated.

I have performed the above predelivery service to the best of my ability.

Signed _____

Date _____

DELIVERY CHECK LIST

At the time of delivery, important information should be conveyed directly to the customer. Check off each item below as it is fully explained to the customer.

- ☐ Give the operator's manual to the customer and explain all operating adjustments.
- ☐ Advise the customer to lubricate the machine as directed in the operator's manual.
- ☐ Tell the customer of safety precautions that must be observed when using the machine.
- ☐ If it becomes necessary to transport the cultivator on public roads or highways, advise customer to check with local and state agencies regarding the regulations for transporting oversize equipment and the use of accessory lights and devices for adequate warning to operators of other vehicles on such roads.
- ☐ To the best of my knowledge, this machine has been delivered ready for field use and the customer has been fully informed regarding proper care and operation.

Signed _____

Date _____

OWNER REGISTER

Name _____

Address _____

Post Office _____

State _____ Zip Code _____

Serial No. _____

Date Purchased _____

AFTER-SALE CHECK LIST

The following is a suggested list of items, to be checked at a dealer-customer mutually agreeable time during the first operating season.

- ☐ Check with the customer as to the performance of the cultivator. Make certain customer understands the proper operating adjustments for the crop (or soil condition).
- ☐ If possible, operate the cultivator to see that it is functioning properly.
- ☐ Acquaint the customer with any special attachment which will help to do a better job.
- ☐ Go over entire cultivator for loose or missing bolts.
- ☐ Check for broken or damaged parts.
- ☐ Check with the customer to ascertain if the recommended periodic lubrication has been performed.
- ☐ Review the operator's manual with the customer and stress the importance of proper lubrication and safety precautions.

Signed _____

Date _____



Contents

	Pages
Safety	2-3
Preparing Tractor	4-6
Attaching and Detaching	7
Transporting	8
Operating Cultivator	9-12
Depth Control	9
Coulter	9
Shanks and Sweeps	10
Plant Shields	11
Disk Hillers	11
Guide Rod	11
Row Spacing	12
Lubrication	13
Storage	14
Assembly	15-16
Specifications	17
Serial Number	17



Safety

Operate Safely

DO NOT operate cultivator without reading this operator's manual.

DO NOT allow anyone to ride on the cultivator when it is in motion. Observe operation only from the tractor platform.

Always shut off tractor engine and shift to "Park" when leaving tractor. Remove ignition key when leaving tractor unattended.

DO NOT operate close to a ditch or creek.

Slow down when turning.

Drive slowly over rough ground.

Apply both tractor brakes evenly when making emergency stops. Plan ahead.

Wear relatively tight and belted clothing to prevent being caught on some part of the machine.

Protect Against Noise

Prolonged exposure to loud noise can cause impairment or loss of hearing.

Wear a suitable hearing protective device such as earmuffs (A) or earplugs (B) to protect against objectionable or uncomfortable loud noises.



A—Earmuffs
B—Earplugs

Avoid Fires

DO NOT refuel with the tractor engine running.

DO NOT smoke or use a lantern when refueling.

Transport Safely

Always raise the cultivator before transporting.

DO NOT fail to latch the tractor brakes together.

Shift the tractor into a lower gear when transporting down steep slopes or hills.

Keep the SMV emblem and reflectors clean and visible.

Stop slowly.

When transporting the cultivator on a road or highway at night or during the day, use accessory lights and devices for adequate warning to operators of other vehicles. In this regard, check local governmental regulations. Various safety lights and device are available from your John Deere dealer.

KNOW the width of your cultivator.

Practice Safe Maintenance

DO NOT adjust or clean the cultivator while in motion.

When working on or around the cultivator, support the cultivator frame on stands.

Always shut off the tractor engine when working on or around the cultivator.

Be careful of sharp edges when working around cultivator.

If touch-up spray can paint is used, be careful when discarding empty can. Do not incinerate or puncture can.

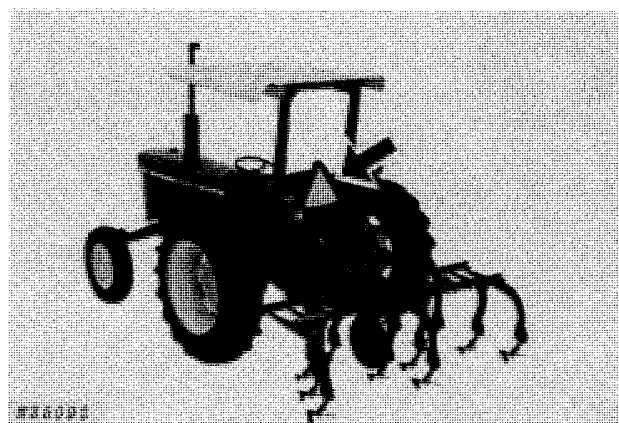



Preparing Tractor

850 AND 950 TRACTORS

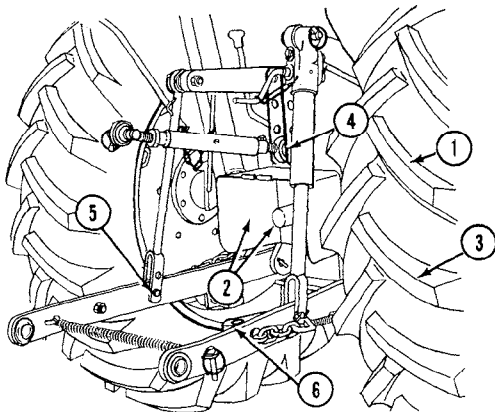

N34588

1. Set the tractor wheels for the desired row spacing. A wider setting provides more stability. See your tractor operator's manual.
2. Make sure the master shield and PTO guard are installed.
3. Make sure tractor tires have correct air pressure, see tractor operator's manual.

NOTE: Tractor ballasting is not required.

4. Position the center link in either one of the two lower holes for maximum sensitivity. Move the link to the upper two holes for the least sensitivity.
5. Use the bottom hole in the left-hand lift link.
6. Place drawbar in short center position or remove it.

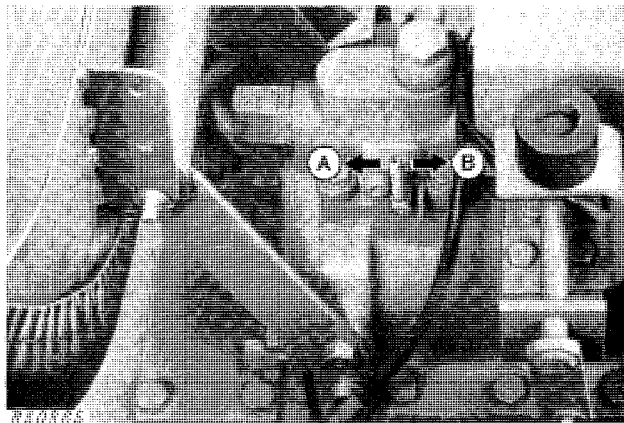

1800004

7. Adjust speed of drop.



CAUTION: Excessive speed of drop can cause damage or injury. Fully lowering toolbar should require at least two seconds.

A—Faster
B—Slower

830, 1530, 2030, 2040, 2440, 2520, 2630, 2640, 2840, 3020 4000, 4020, 4030, 4040, 4230 AND 4240 TRACTORS

1. Set the tractor wheels for desired row spacing. A wider spacing provides more stability. See your tractor operator's manual.
2. Make sure the master shield and PTO guard are installed.
3. Make sure tractor tires have correct air pressure. See tractor operator's manual.

NOTE: Tractor ballasting is not required.

4. Place drawbar in short centered position or remove it.
5. Adjust lift links to minimum length. See tractor operator's manual.

IMPORTANT: Quik-Coupler CANNOT be used.

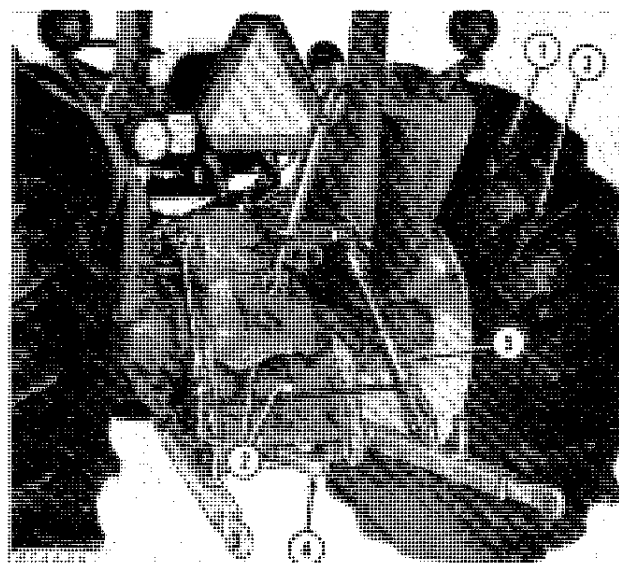

6. Lock out lateral float (A).

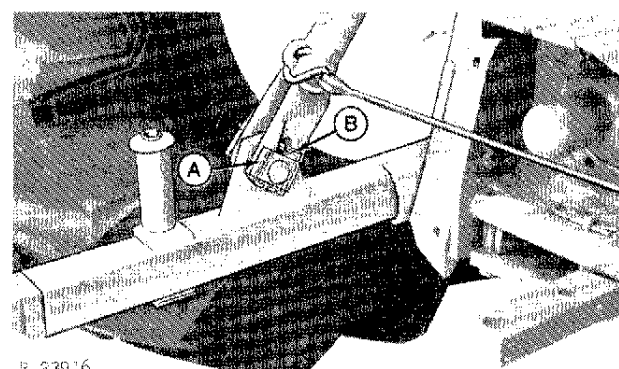

A—Float Prevented
B—Float Permitted

7. Position sway blocks in upper setting to prevent side sway during transport.

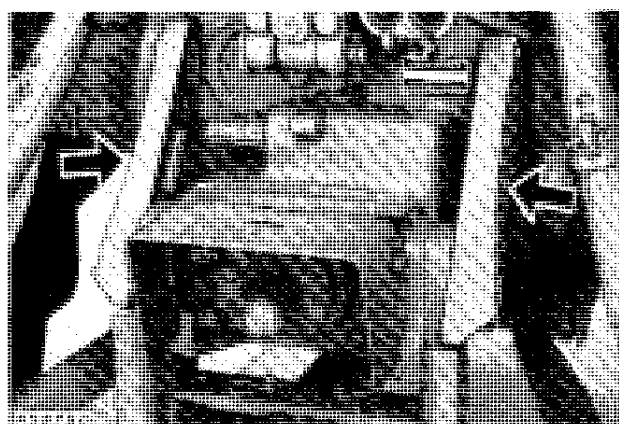

Thank you so much for reading.
Please click the “Buy Now!”
button below to download the
complete manual.



After you pay.

You can download the most
perfect and complete manual in
the world immediately.

Our support email:

ebooklibonline@outlook.com