

80 Rear-Mounted Toolbar with Row-Crop Cultivator Attachments



OPERATORS MANUAL

**80 Rear-Mounted Toolbar with
Row-Crop Cultivator Attachments**

OMN159528 Issue A4 English

**John Deere Des Moines Works
OMN159528 Issue A4**

LITHO IN U.S.A.
ENGLISH





Introduction



This safety alert symbol indicates important safety messages in this manual. When you see this symbol, be alert to the possibility of personal injury and carefully read the message that follows.

This operator's manual contains SI Metric equivalents which follows immediately after the US customary units of measure.

"Right-hand" and "Left-hand" sides are determined by facing in the direction the tractor will travel in use.

Your warranty appears on your copy of the purchase order which you should have received from your dealer.

Record your toolbar serial number on page 20.

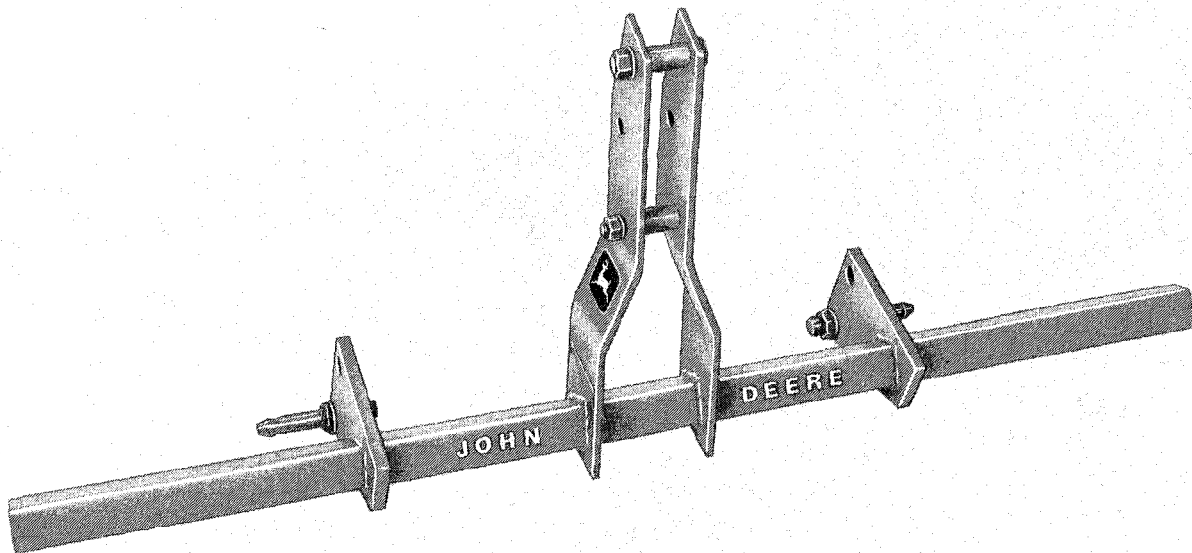

N7713111

John Deere 80 Rear-Mounted Toolbar

JOHN DEERE 80 TOOLBAR WITH ROW-CROP CULTIVATOR ATTACHMENTS

PREDELIVERY CHECK LIST

- ☐ Make sure all customer-ordered attachments are installed on toolbar.
- ☐ Make sure row-spacing is correct for customer.
- ☐ Any parts scratched in shipment have been touched-up with paint.
- ☐ Toolbar is ready for delivery to customer for immediate use.

Signed _____

Date _____

DELIVERY CHECK LIST

At the time of delivery, important information should be conveyed to the customer. Check off each item below as it is fully explained to the customer.

- ☐ Give the operator's manual to the customer and explain all operating adjustments to him.
- ☐ Review with the customer the safety instructions in the operator's manual which he must observe when using the machine.

OWNER REGISTER

Toolbar Model _____

Name _____

R.R. or Street _____

City _____

State _____ Zip _____

When the cultivator is transported on a road or highway at night or during the day, accessory lights and devices should be used for adequate warning to operators of other vehicles. In this regard, tell customer to check local governmental regulations.

Signed _____

Date _____

AFTER-SALE CHECK LIST

The following is a suggested list of items to be checked at a dealer-customer mutually agreeable time during the first operating season.

- ☐ Check with the customer as to the performance of the cultivator.
- ☐ If possible, operate the cultivator to see that it is functioning properly.
- ☐ Acquaint the customer with any special attachment which will help him to do a better job.
- ☐ Go over entire cultivator for loose or missing bolts.
- ☐ Check for broken or damaged parts.
- ☐ Review the operator's manual with the customer and stress the importance of safety precautions.

Signed _____

Date _____



Contents

	Page
Safety	2-3
Preparing the Tractor	4-6
650, 750, 850, 950, 1050, 1250 and 1450 Tractors	4
830, 2040, 2150, 1640, 2240, and 2350 tractors	5-6
Preparing Cultivator	7
Attaching and Detaching	8-10
Storage	10
Transporting	11
Operating Cultivator	12-16
Depth control	12-13
650, 750, 850, 950, 1050, 1250 and 1450 Tractors	12
830, 2040, 2150, 1640, 2240, and 2350 tractors	13
Rig Mounted Shields Attachments	14-15
Row Spacing Diagrams	16
Assembly	17-19
Specifications	20
Serial number	20



Safety

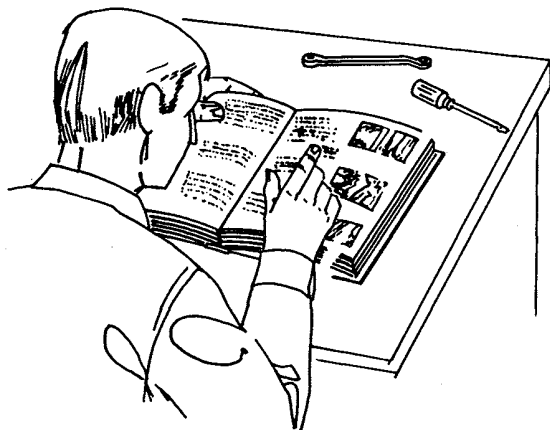

N35538

Operate Safely

DO NOT operate cultivator without reading the operator's manual.

DO NOT allow anyone to ride on cultivator when it is in motion. Observe operation only from tractor platform.

Always shut off tractor engine and shift to "Park" when leaving tractor unattended.

DO NOT operate close to a ditch or creek.

Slow down when turning.

Drive slowly over rough ground.

Apply both tractor brakes evenly when making emergency stops. Plan ahead.

Wear relatively tight and belted clothing to prevent being caught on some part of the machine.

If your tractor is equipped with ROLL-GARD® Safety Canopy and seat belt, be sure to keep your seat belt fastened.

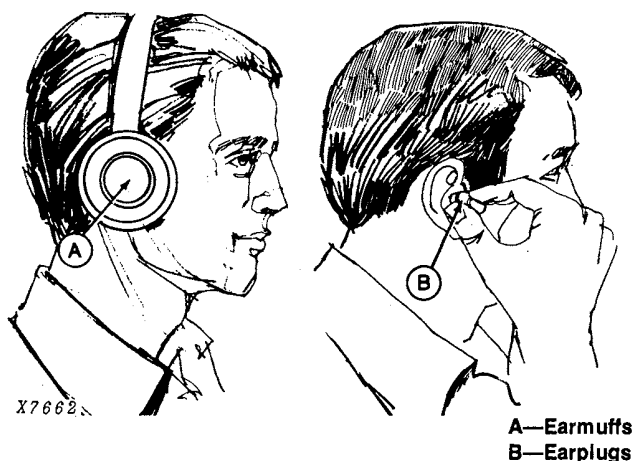

A—Earmuffs
B—Earplugs

Protect Against Noise

Prolonged exposure to loud noise can cause impairment or loss of hearing.

Wear a suitable hearing protective device such as earmuffs (A) or earplugs (B) to protect against objectionable or uncomfortable loud noises.

Avoid Fires

DO NOT refuel with the tractor engine running.

DO NOT smoke or use a lantern when refueling.

Transport Safely

Always raise the cultivator before transporting.

DO NOT fail to latch the tractor brakes together.

Shift the tractor into a lower gear when transporting down steep slopes or hills.

Keep SMV emblem and reflectors clean and visible.

Stop slowly.

When transporting the cultivator on a road or highway at night or during the day, use accessory lights and devices. Check local governmental regulations for proper use. Various safety lights and devices are available from your John Deere dealer.

KNOW the width and clearance of your cultivator.

Service Tires Safely

Failure to follow proper procedures when mounting a tire on a wheel or rim can produce an explosion which may result in serious injury or death. Do not attempt to mount a tire unless you have the proper equipment and experience to perform the job. Have it done by your John Deere dealer or a qualified tire repair service.

When seating tire beads on rims, never exceed 35 psi (240 kPa) (2.4 bar) or maximum inflation pressures specified by tire manufacturers for mounting tires. Inflation beyond this maximum pressure may break the bead, or even the rim, with dangerous explosive force. If both beads are not seated when the maximum recommended pressure is reached, deflate, reposition tire, re-lubricate bead, and reinflate.

Detailed agricultural tire mounting instructions, including necessary safety precautions, are contained in John Deere Fundamentals of Service (FOS) Manual 55, Tires and Tracks, available through your John Deere dealer. Such information is also available from the Rubber Manufacturers Association and from tire manufacturers.

A—Use a safety cage if available.

B—Do not stand over tire. Use a clip-on chuck and extension hose.

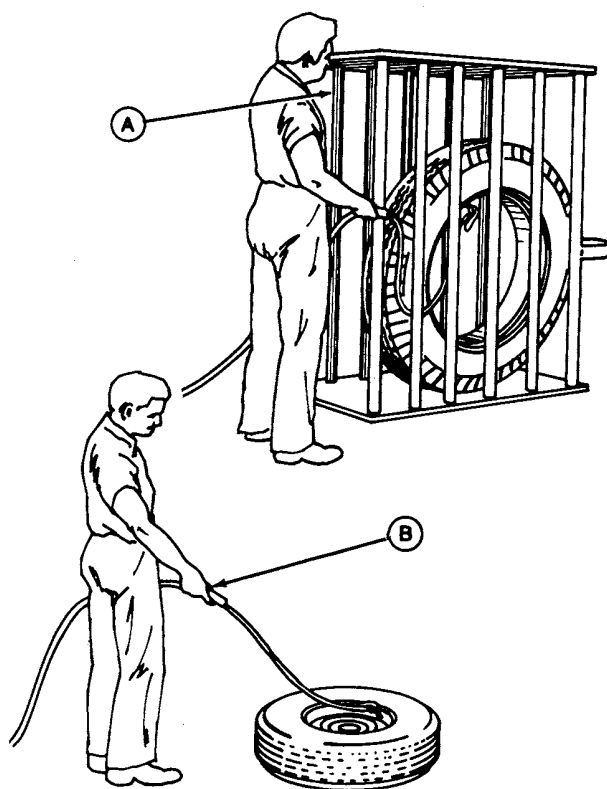

TS0123

Practice Safe Maintenance

DO NOT lubricate, adjust, or clean the cultivator while it is in motion.

Always use a safety support cultivator when working on, under, or around the cultivator.

Shut off engine and remove key when working on cultivator.

After removal or repair of cylinders, support cylinders on blocks and cycle several times to bleed trapped air from lines.

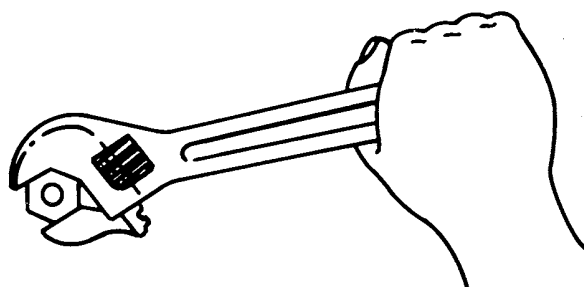

N37033



Preparing Tractor

650, 750, 850, 950, 1050, 1250, AND 1450 TRACTORS

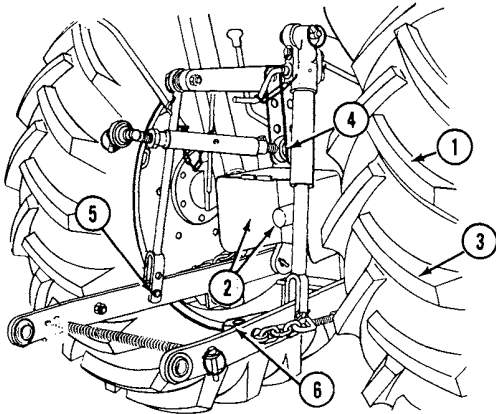

N34588

N34588

1. Set the tractor wheels for the desired row spacing. A wider setting provides more stability. See your tractor operator's manual.

RECOMMENDED TWO-ROW CULTIVATOR TREAD WIDTH	
ROW SPACING	TREAD WIDTH
28 in. (710 mm)	59 in. (1500 mm)
30 in. (760 mm)	63 in. (1600 mm)
32 in. (810 mm)	67 in. (1700 mm)

IMPORTANT: The tractor tires **MUST BE** set at their widest setting when using the 950 tractor equipped with the optional 12.4-28-inch (427-710 mm) tires with the two-row cultivator.

IMPORTANT: Turf tires **NOT RECOMMENDED** with two-row cultivator on 950 or 1050 tractor.

2. Make sure the master shield and PTO guard are installed.
3. Make sure tractor tires have correct air pressure, see tractor operator's manual.

NOTE: Tractor ballasting is not required.

4. Position the center link in either one of the two lower holes.
5. Use the bottom hole in the left-hand lift link.
6. Place drawbar in short centered position or remove it.
7. Adjust speed of drop (see tractor operator's manual).



CAUTION: Excessive speed of drop can cause damage or injury. Fully lowering toolbar should require at least two seconds.

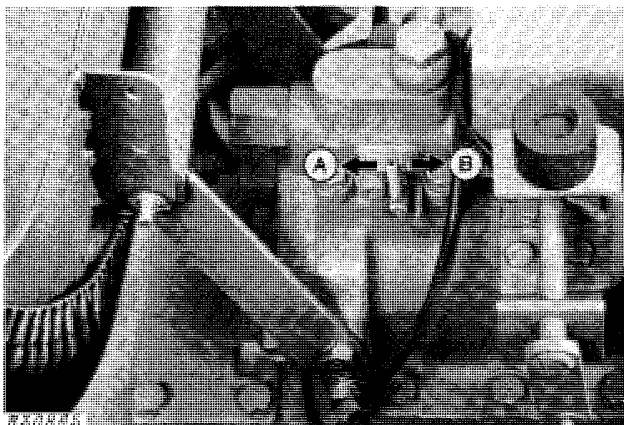

R30865

R30865

A—Faster
B—Slower

830, 2040, 2150, 1640, 2240, AND 2350 TRACTORS

1. Set the tractor wheels for desired row spacing. A wider spacing provides more stability. See your tractor operator's manual.

RECOMMENDED TWO-ROW CULTIVATOR TREAD WIDTH	
ROW SPACING	TREAD WIDTH
28 in. (710 mm)	59 in. (1500 mm)
30 in. (760 mm)	63 in. (1600 mm)
32 in. (810 mm)	67 in. (1700 mm)

2. Make sure the master shield and PTO guard are installed.
3. Make sure tractor tires have correct air pressure. See tractor operator's manual.

NOTE: Tractor ballasting is not required.

4. Place drawbar in short centered position or remove it.
5. Adjust lift links to minimum length. See tractor operator's manual.

IMPORTANT: Quick-coupler **CANNOT** be used.

6. If frame gauge wheels are used, adjust lift links to allow lateral float. If frame gauge wheels are not used, adjust lift links to lock out lateral float.

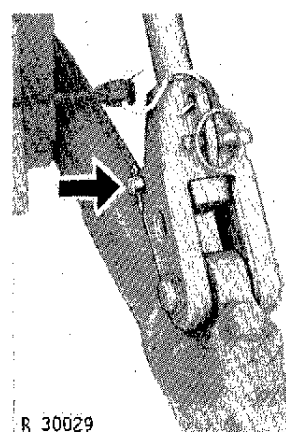
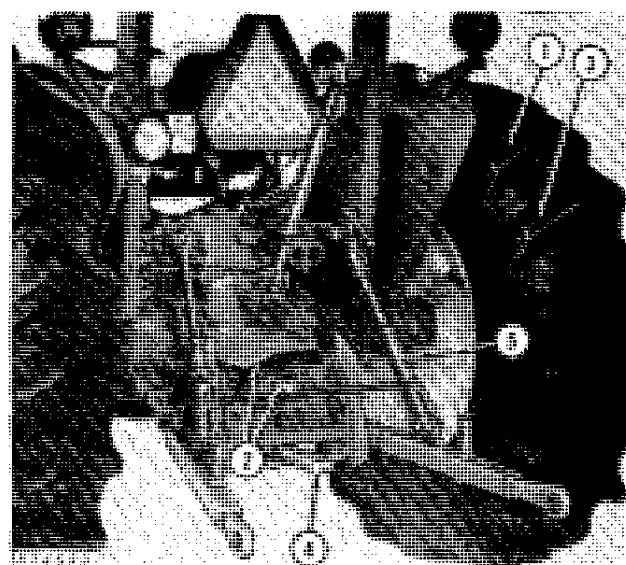

With Gauge Wheels

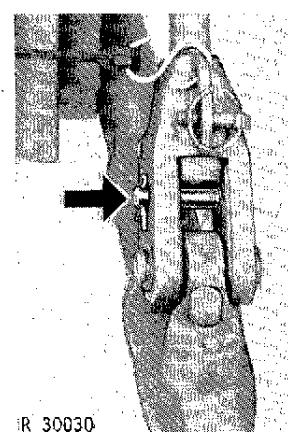

Without Gauge Wheels

7. Position sway blocks in upper setting to prevent side sway during transport.



Thank you so much for reading.
Please click the “Buy Now!”
button below to download the
complete manual.



After you pay.

You can download the most
perfect and complete manual in
the world immediately.

Our support email:

ebooklibonline@outlook.com