

JOHN DEERE
WORLDWIDE COMMERCIAL & CONSUMER
EQUIPMENT DIVISION

Brushcutter
XT250B LE - UT15230

OMPS05086 K3
OPERATOR'S MANUAL



JOHN DEERE

All information, illustrations and specifications in this manual are based on the latest information at the time of publication. The right is reserved to make changes at any time without notice.

COPYRIGHT© 2004
Deere & Co.

John Deere Worldwide Commercial and Consumer Equipment Division
All rights reserved
Previous Editions
COPYRIGHT©

North American Version
Litho in U.S.A.

PRODUCT IDENTIFICATION

Product Identification

Record Identification Numbers

XT250B LE Brushcutter

If you need to contact an Authorized Service Center for information on servicing, always provide the product model and serial number.

You will need to locate the serial number for the machine and record the information in the spaces provided below.

DATE OF PURCHASE:

DEALER NAME:

DEALER PHONE:

UT NUMBER:

UT15230

PRODUCT SERIAL NUMBER:

TCXB25Lxxxxxx

Safety

Read the general safety operating precautions in your machine operator's manual for additional safety information.

Understanding The Safety-Alert Symbol

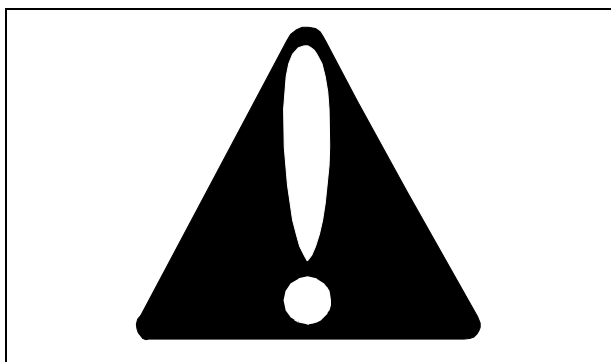

MIF

The machine safety labels shown in this section are placed in important areas on your machine to draw attention to potential safety hazards.

On your machine safety labels, the words DANGER, WARNING, and CAUTION are used with this safety-alert symbol. DANGER identifies the most serious hazards.

The operator's manual also explains any potential safety hazards whenever necessary in special safety messages that are identified with the word, CAUTION, and the safety-alert symbol.

Safety Symbols

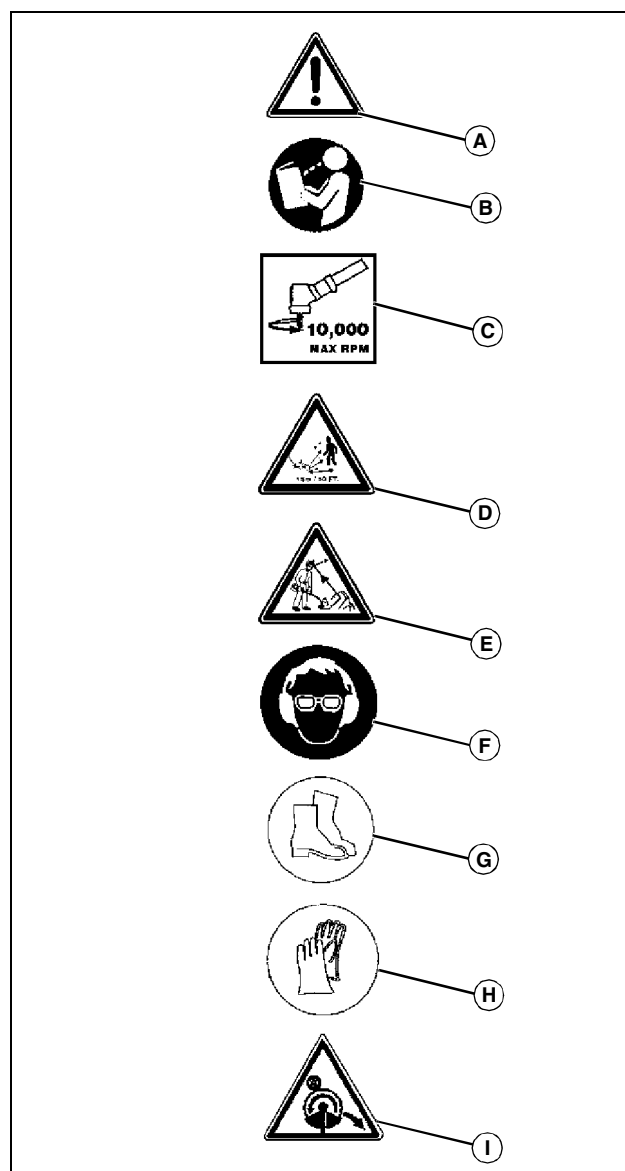

MX30191

- A- Indicates Warning, Danger, and Caution.
- B- Read all Safety, Operating and Maintenance Instructions.
- C- Maximum output spindle revolutions per minute (RPM). Do not use cutting attachment with a lower maximum rating.
- D- Keep all bystanders at least 50 feet (15 m) away.
- E- Danger of ricochet.
- F- Wear eye and hearing protection when operating this equipment.
- G- Wear appropriate footwear when operating this equipment.
- H- Wear heavy gloves when operating this equipment. Wear heavy gloves when installing or removing blades.
- I - Danger! Beware of blade thrust.

SAFETY

Operating Safely



CAUTION: Avoid injury! For safe operation, read these instructions before using your trimmer/brushcutter. Follow all instructions for safety.

NOTE: Do not allow children or untrained individuals to use this unit.

Follow these instructions to reduce the risk of injury.

Always stop engine and remove spark plug wire before making any adjustments or repairs except carburetor adjustments.

- Use this trimmer for cutting weeds and grass only. Do not use for any other purpose.
- Never start or run the engine inside a closed area; breathing exhaust fumes can kill.
- Clear the work area before each use. Remove all objects such as rocks, broken glass, nails, wire, or string which can be thrown or become entangled in the string head.
- Wear full eye and hearing protection while operating this trimmer.
- Wear heavy long pants, shoes, and gloves.
- Keep all bystanders, children, and pets at least 50 feet away.
- Do not wear loose clothing, or jewelry.
- Secure long hair so it is above the shoulder.
- Do not operate this trimmer when you are tired, ill, or under the influence of alcohol, drugs, or medication.
- Do not operate in poor lighting. Keep firm footing and balance. Do not overreach.
- Keep all parts of your body away from the stringhead or blade and hot surfaces. Keep string head or blade below waist level.
- Do not touch areas around the muffler and cylinder; these parts get hot from operation.
- If you are approached, stop the engine and cutting attachment.

Maintenance Safety Procedures



CAUTION: Avoid injury! Use only John Deere replacement parts. Failure to do so may cause poor performance, possible injury and may void your warranty.

PRODUCT USERS ON UNITED STATES FOREST SERVICE LAND, AND IN SOME STATES, MUST COMPLY WITH FIRE PREVENTION REGULATIONS. THIS PRODUCT IS EQUIPPED WITH A SPARK ARRESTOR; HOWEVER, OTHER USER REQUIREMENTS MAY APPLY. CHECK WITH YOUR FEDERAL, STATE, OR LOCAL AUTHORITIES.

- Inspect unit before each use for loose fasteners, fuel leaks, etc. Replace damaged parts. Replace string head if cracked, chipped, or damaged in any way. Be sure the string head is properly installed and securely fastened. Failure to do so can cause serious injury.
- Make sure all deflectors and handles are properly and securely attached.
- Use only flexible, non-metallic monofilament string in the cutting head. Never use wire or wire rope.
- The string head will spin during carburetor adjustments. Wear protective equipment and observe all safety instructions.

- Before storing, allow the engine to cool.
- Empty the fuel tank and restrain the trimmer from moving before transporting in a vehicle.

Handling Fuel Safely



CAUTION: Avoid injury! Do not smoke!

- Mix and store fuel in a container approved for gasoline.
- Mix fuel outdoors where there are no sparks or flames.
- Select bare ground, stop engine and allow to cool before refueling.
- Loosen fuel cap slowly to release pressure and to keep fuel from escaping around the cap.
- Wipe spilled fuel from the unit. Move 3 m (10 feet) away from refueling site before starting engine.

Operate Safely Using Blade

- After engine stops, keep rotating blade in heavy grass or brush until it stops.
- Always hold unit firmly with both hands.
- Do not operate the brushcutter unless the blade guard is in place and in good condition.
- Always stop the engine before attempting to remove any obstruction caught or jammed in the blade.
- Do not attempt to touch or stop the blade when it is rotating.
- A coasting blade can cause injury while it continues to spin after the engine is stopped or throttle trigger released. Maintain proper control until the blade has completely stopped rotating.
- Always make sure blade is installed correctly and securely fastened before each use.
- Use sharp blades - replace any blade that has been damaged or is no longer sharp.
- Use only JOHN DEERE® blades intended for use on this brushcutter. DO NOT USE ANY OTHER BLADE.
- Use blades to cut materials described in "Using Blade" in the OPERATING section below. Do not use for any other purpose.
- There is a risk of injury to bystanders from being struck with the working blade in the event of a blade thrust.

ASSEMBLY



CAUTION: Avoid injury! Exercise extreme caution when using the blade with this unit. **BLADE THRUST** is the reaction that may occur when the spinning blade contacts anything it cannot cut. This contact may cause the blade to stop for an instant, and suddenly “thrust” the unit away from the object that was hit. This reaction can be violent enough to cause the operator to lose control of the unit. **BLADE THRUST** can occur without warning if the blade snags, stalls, or binds. This is more likely to occur in areas where it is difficult to see the material being cut.

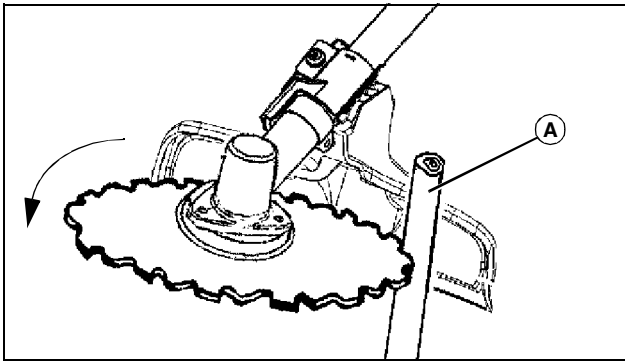

MX30166

- Use blade guard as rear stop as shown (A) to minimize this reaction.

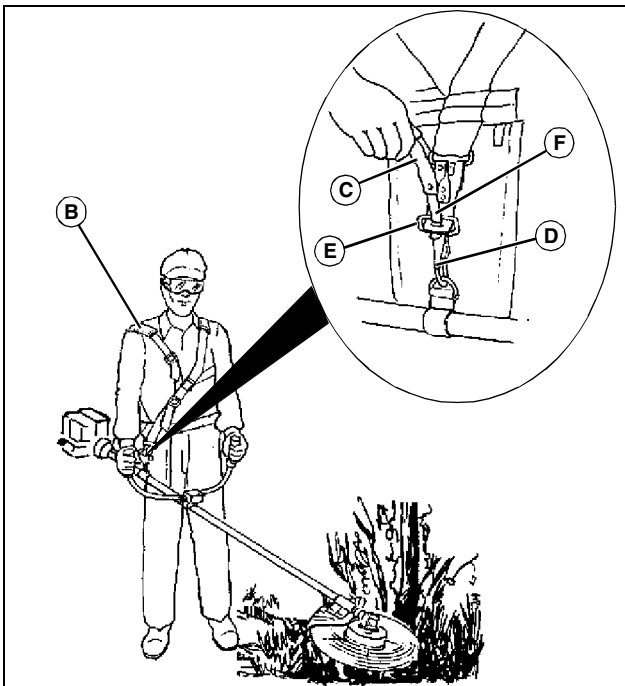

MX30210

- Always wear strap (B) and adjust as shown. Maintain a firm grip on both handles while cutting with a blade. Keep blade away from body and below waist.
- Use heavy gloves while installing or removing blades.
- Inspect unit to be sure that blade is firmly attached.

NOTE: Strap Quick Release:

- *The shoulder strap has a quick release latch, so that if necessary to disengage quickly, operator can pull the red strap (C) to immediately disconnect from the unit.*

- *To reassemble, remove spring clip (D) from unit, place open end over strap buckle (E), and re-insert quick release blade (F).*

Assembly

Assemble Front Handle

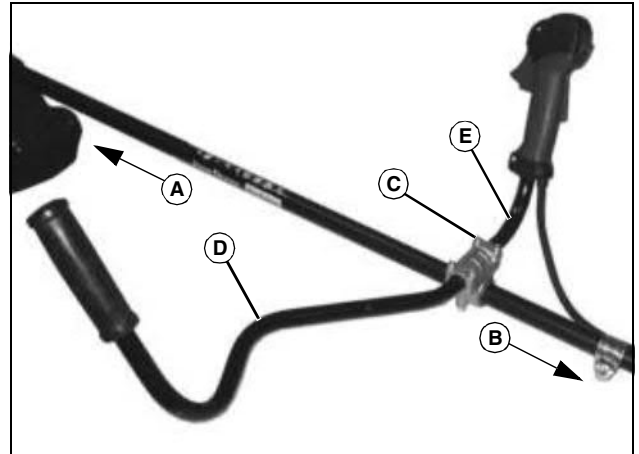

MX30211

Picture Note: Orientation Shown; Cutting attachment end (A) and power head end (B).

1. Loosen the four (4) bolts (C) on the handle clamp and slip handle ends into clamp so the ends meet in the middle. (Right side handle has throttle and stop switch assembly mounted on it.)

NOTE: Handle clamp position is pre-set at the factory. It may be repositioned for best balance and comfort. Left handle (D) should angle forward. Right handle (E) should be straight up.

2. Adjust handles for operator control and comfort, and tighten the four (4) clamp bolts evenly and securely.

Install and Adjust Throttle Cable

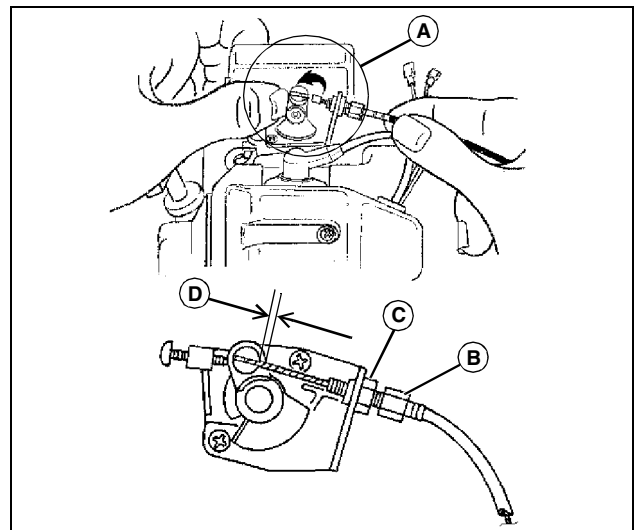

MX30209

1. Open throttle as shown (A), and hook the end of the throttle cable to the carburetor. Carburetor lever swivel has a round hole to accept and capture cable end.

ASSEMBLY

NOTE: If the play is too large, the starting performance with trigger at starting position will be poor.

If the play is non-existent, the carburetor lever may not return to idle position when trigger is released.

2. Adjust the cable by turning the turnbuckle (B) in or out and locking with the locking nut (C). The proper cable play is 0.5 - 1 mm (0.02 - 0.04 in.) (D).

Connect Ignition Switch Wires

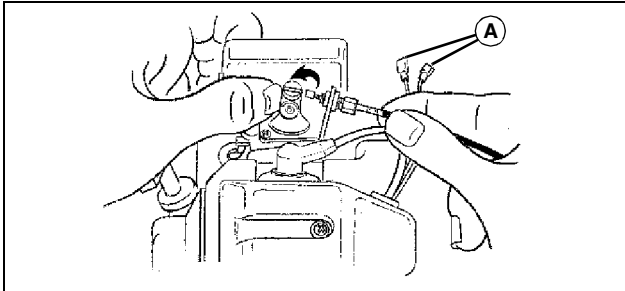

MX30209

1. Connect two wires on throttle control to two wires (A) from trimmer engine. (Black and black w/white stripe wires from throttle control match colors of engine wiring. Connectors will only allow correct wires to be connected.)

Install Grass Deflector

NOTE: When converting from brushcutter to string trimmer, or string trimmer to brushcutter, make sure the correct guard/deflector is being used.

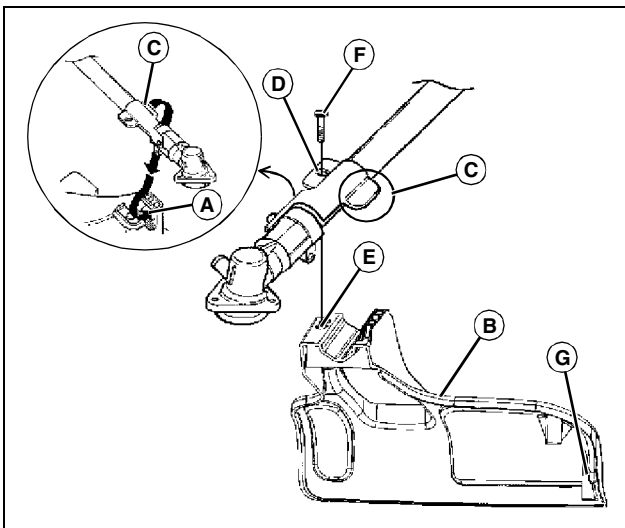

MX30192

1. Place slot (A) in grass deflector (B) over the square tab (C) of mounting bracket.

2. Rotate the grass deflector around the driveshaft housing. Align the screw hole (D) in the mounting bracket with the screw hole (E) in the grass deflector.

3. Insert screw (F) through the mounting bracket and into the grass deflector and tighten securely.

NOTE: When assembling grass deflector (B), be sure to remove cover from cut-off blade (G) on deflector before using string trimmer.

Install Blade Guard

NOTE: When converting from brushcutter to string trimmer, or string trimmer to brushcutter, make sure the correct guard/deflector is being used.

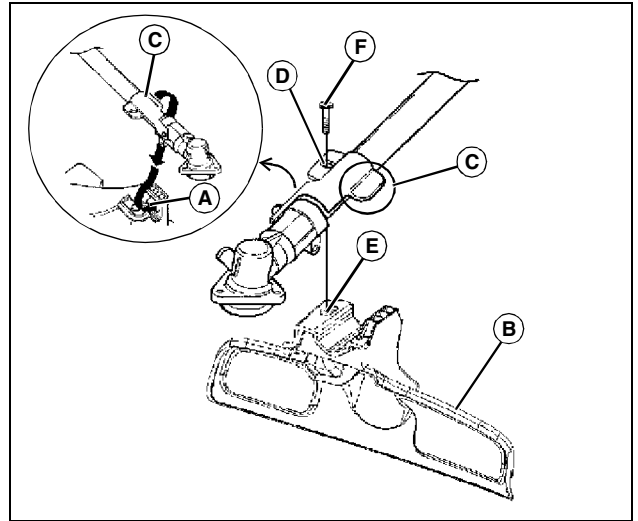

MX30193

1. Place slot (A) in blade guard (B) over the square tab (C) of mounting bracket.

2. Rotate the blade guard around the driveshaft housing. Align the screw hole (D) in the mounting bracket with the screw hole (E) in the blade guard.

3. Insert screw (F) through the mounting bracket and into the blade guard and tighten securely.

Install Stringhead

NOTE: Installing the stringhead is easier if you place the unit upside down, or stand the unit up with the engine on a clean, flat surface.

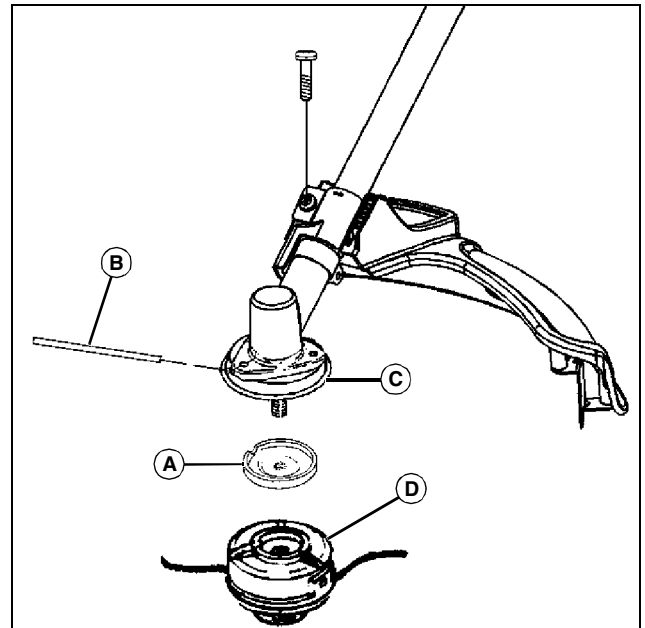

MX30194

1. Install upper flange washer (A) onto gear shaft with hollow side toward gear head.

Thank you so much for reading.
Please click the “Buy Now!”
button below to download the
complete manual.



After you pay.

You can download the most
perfect and complete manual in
the world immediately.

Our support email:

ebooklibonline@outlook.com