

CX235C SR
Tier 4
Crawler Excavator

SERVICE MANUAL

Part number 84577150
1st edition English
February 2012



Removal and Installation of Engine Assembly

⚠ WARNING

- Keep away from fire.
- Be sure to release hydraulic pressure before beginning work.
- The air conditioner circuit is filled with high-pressure gas, so beware of the gas released when loosening lines.
- Do not use open flames and do not allow sparks near the battery.

⚠ CAUTION

- Be sure to stop the engine before beginning work.
- Be sure to inspect the wire rope and other lifting equipment before beginning work.
- Do not stand or pass under the suspended load.

Items to prepare

- Wrenches [7 mm (0.276 in), 8 mm (0.315 in), 13 mm (0.512 in), 14 mm (0.551 in), 17 mm (0.669 in), 36 mm (1.417 in)]
- Box wrench [24 mm (0.915 in)]
- Shackle (with the required lifting capacity) x 2
- Wire rope (with the required breaking load)
- Crane (with the required lifting capacity)
- Marking pen
- Caps
- Plugs
- Waste oil can
- Rag
- Cleaning fluid
- Wood plank

Removal of Engine Assembly

1. Remove the counterweight. (For details, see "Removal and Installation of Counterweight".)
2. Remove the pump. (For details, see "Removal and Installation of Hydraulic Pump".)
3. Use a wrench [14 mm (0.551 in)] to remove the bolts (1) and (2), and then remove the fan shroud (3).

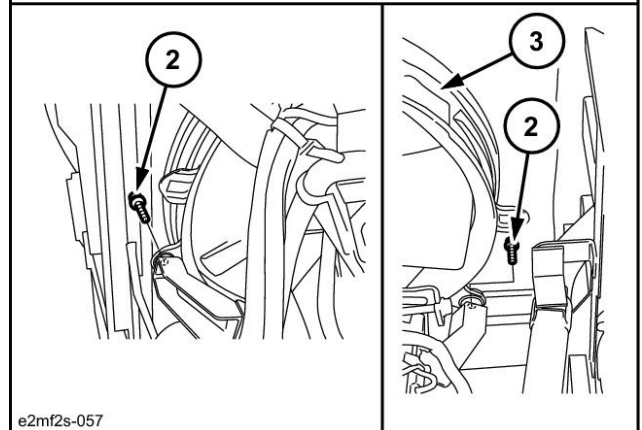
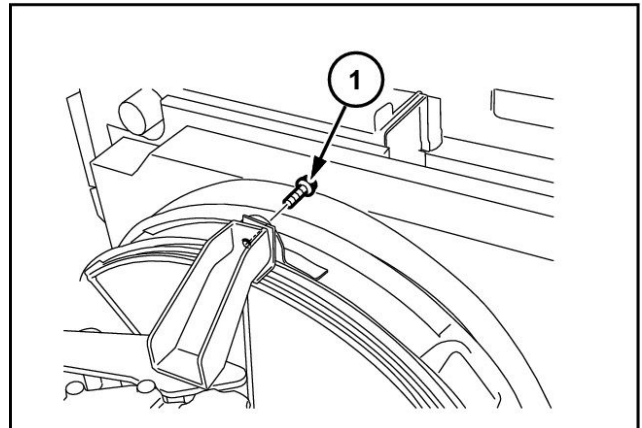

4. Use a wrench [14 mm (0.551 in)] to remove the bolts (1), and then remove the fan guard (2).

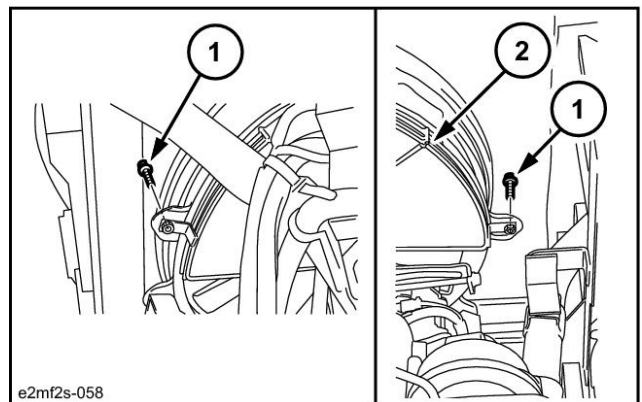

Removal and Installation of Engine Assembly

5. Use a wrench [7 mm (0.276 in)] to loosen the hose band (1) on the radiator, and then remove the upper hose (2).

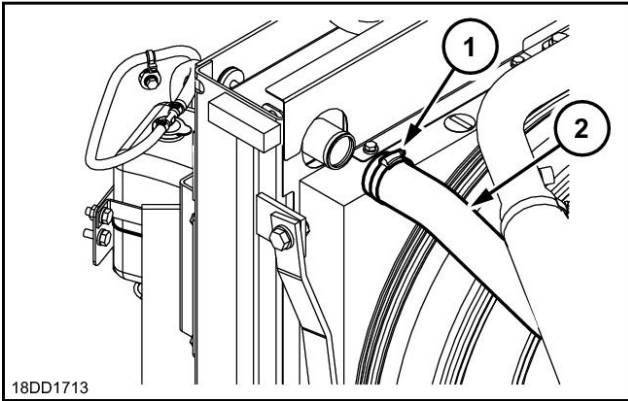

6. Use a wrench [7 mm (0.276 in)] to loosen the hose band (1) on the radiator, and then remove the lower hose (2).

- Use caps to cover the radiator and hoses to prevent the entry of water, dust or dirt.
- Before removing the radiator hoses, completely drain the coolant.

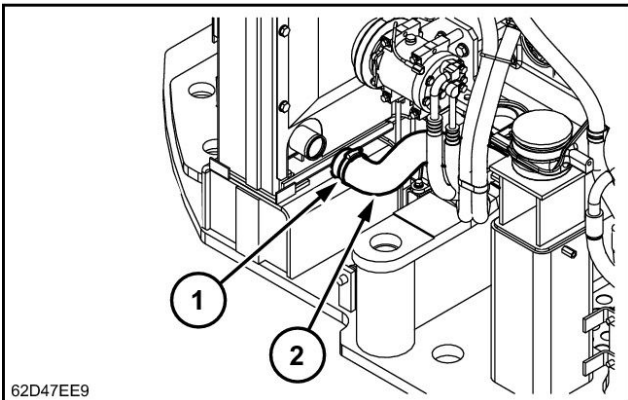

7. Use a wrench [13 mm (0.512 in)] to loosen the line bolts (1) in 2 locations, and then remove the 2 lines (2) and (3) from the compressor.

- Always remove the low-pressure (suction side) line (2) first.
- Attach caps or plugs to the compressor and lines to prevent any entry of water, dust or dirt.

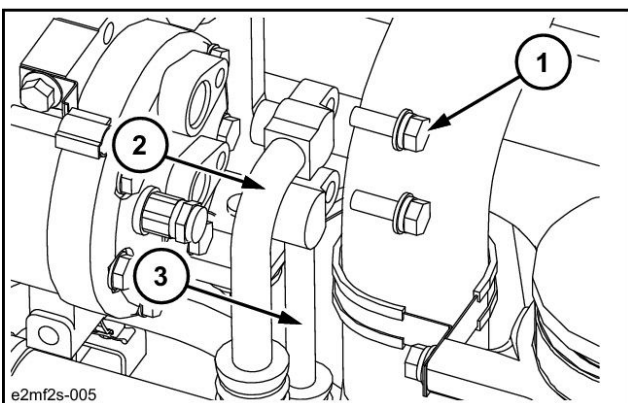

3 Line (discharge side)

8. Use a wrench [8 mm (0.315 in)] to loosen the hose band (1) on the inter cooler, and then remove the hose (2).

- Use caps to cover the line and hose to prevent the entry of water, dust or dirt.

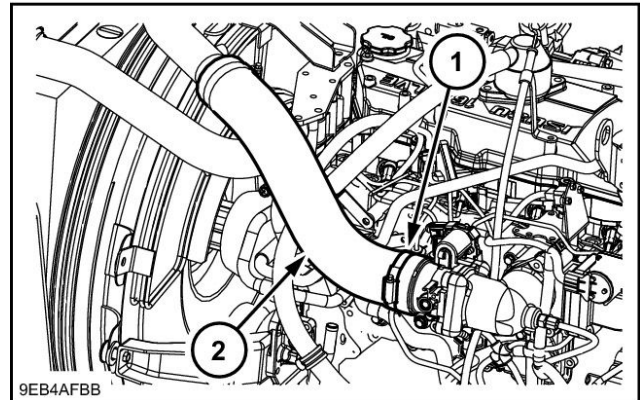

9. Remove the hose bands (1) in the 3 locations.

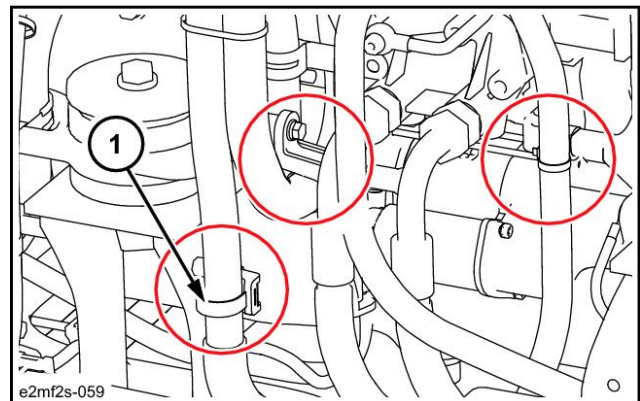

10. Prepare a waste oil can (1).

- Drain the engine oil before removing the engine oil hose.

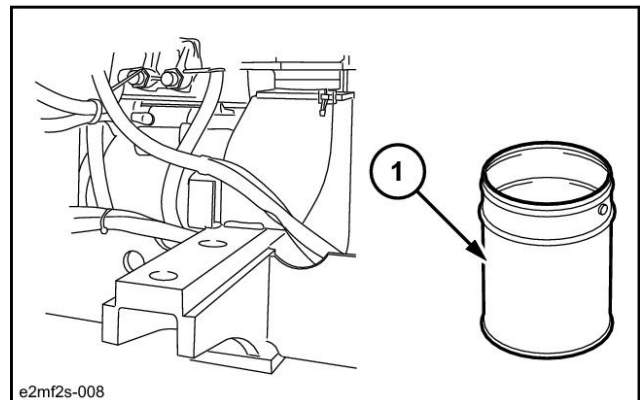

11. Use a wrench [36 mm (1.417 in)] to remove the 2 engine oil remote hoses (1).

- Mark the engine and hoses so that the connectors match at the time of assembly.
- Attach caps or plugs to the engine and hoses to prevent any entry of water, dust or dirt.
- Clean the engine and hoses by spraying them with a parts cleaner to prevent scratches and prevent dirt from accumulating on the connectors.

Thank you so much for reading.
Please click the “Buy Now!”
button below to download the
complete manual.



After you pay.

You can download the most
perfect and complete manual in
the world immediately.

Our support email:

ebooklibonline@outlook.com