

Product: MINI HYD EXCAVATOR
Model: 301.7D MINI HYD EXCAVATOR LJH
Configuration: 301.7D Mini Hydraulic Excavator LJH00001-UP (MACHINE)

Disassembly and Assembly 301.7D, 302.2D and 302.4D Mini Hydraulic Excavators Machine Systems

Media Number -UENR3254-01

Publication Date -01/05/2015

Date Updated -12/05/2015

i05221254

Final Drive and Travel Motor - Disassemble

SMCS - 4050-015; 4351-015

Disassembly Procedure

Start By:

- A. Remove the final drive.



Illustration 1

g03337634

1. Remove sprocket (1).
-

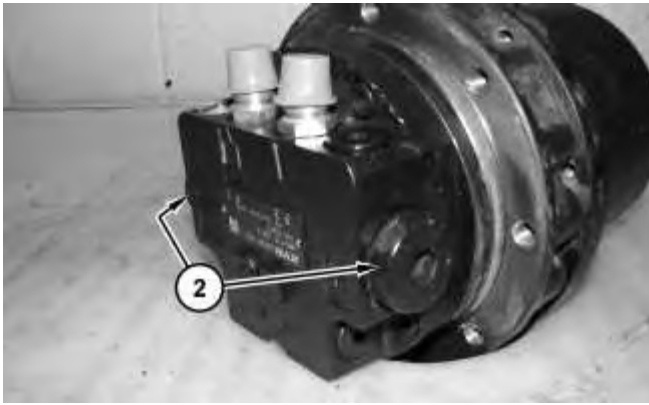

Illustration 2

g03337638

WARNING

Personal injury can result from being struck by parts propelled by a released spring force.

Make sure to wear all necessary protective equipment.

Follow the recommended procedure and use all recommended tooling to release the spring force.

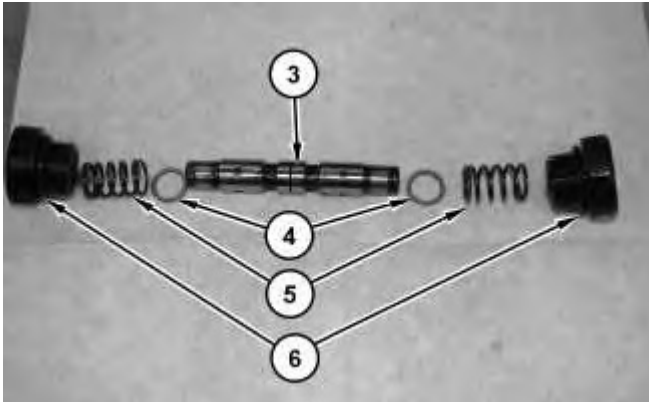

Illustration 3

g03337661

2. Remove plugs (2) and O-ring seals (6). Remove springs (5). Remove washers (4) and valve spool (3).

Product: MINI HYD EXCAVATOR
 Model: 301.7D MINI HYD EXCAVATOR LJH
 Configuration: 301.7D Mini Hydraulic Excavator LJH00001-UP (MACHINE)

Disassembly and Assembly 301.7D, 302.2D and 302.4D Mini Hydraulic Excavators Machine Systems

Media Number -UENR3254-01

Publication Date -01/05/2015

Date Updated -12/05/2015

i05221337

Final Drive and Travel Motor - Assemble

SMCS - 4050-016; 4351-016

Specifications

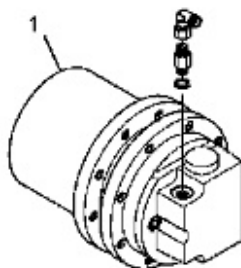

Illustration 1

g03176957

Table 1

Specification for 399-3043 Travel Motor Gp			
Item	Qty	Part	Specification Description
1	-	-	Maximum displacement per revolution is 20.7 cc (1.3 cubic inch).
			Maximum motor speed is 1250 rpm.

Assembly Procedure

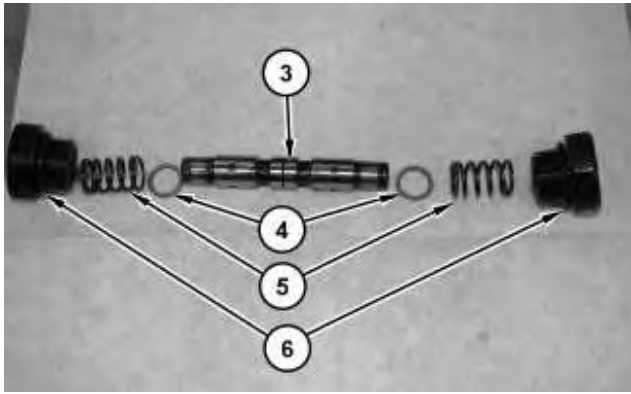

Illustration 2

g03337703

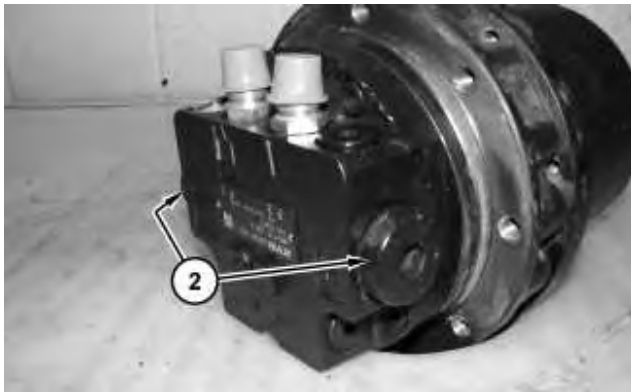

Illustration 3

g03337715

WARNING

Personal injury can result from being struck by parts propelled by a released spring force.

Make sure to wear all necessary protective equipment.

Follow the recommended procedure and use all recommended tooling to release the spring force.

1. Install valve spool (3) and washers (4). Install springs (5). Install O-ring seals (6) onto plugs (2) .
2. Install plugs (2) into the final drive motor.

Thank you so much for reading.
Please click the “Buy Now!”
button below to download the
complete manual.



After you pay.

You can download the most
perfect and complete manual in
the world immediately.

Our support email:

ebooklibonline@outlook.com