

Product: MINI HYD EXCAVATOR

Model: 308E2 CR MINI HYD EXCAVATOR MY2

Configuration: 308E 2CR Mini Hydraulic Excavator MY200001-UP (MACHINE)

Disassembly and Assembly

C3.3B Tier 4 Final and EU Stage 3B Engines for Caterpillar Built Machines

Media Number -UENR3278-07

Publication Date -01/09/2014

Date Updated -11/07/2016

i05305930

Exhaust Gas Recirculation Valve - Remove and Install

SMCS - 108N-010

Removal Procedure



Personal injury can result from hot coolant, steam and alkali.

At operating temperature, engine coolant is hot and under pressure. The radiator and all lines to heaters or the engine contain hot coolant or steam. Any contact can cause severe burns.

Remove cooling system pressure cap slowly to relieve pressure only when engine is stopped and cooling system pressure cap is cool enough to touch with your bare hand.

Do not attempt to tighten hose connections when the coolant is hot, the hose can come off causing burns.

Cooling System Coolant Additive contains alkali. Avoid contact with skin and eyes.

NOTICE

Care must be taken to ensure that fluids are contained during performance of inspection, maintenance, testing, adjusting, and repair of the product. Be prepared to collect the fluid with suitable containers before opening any compartment or disassembling any component containing fluids.

Refer to Special Publication, NENG2500, "Dealer Service Tool Catalog" for tools and supplies suitable to collect and contain fluids on Cat products.

Dispose of all fluids according to local regulations and mandates.

Note: Refer to Specifications, "Engine Design" for non-specified engine torque values.

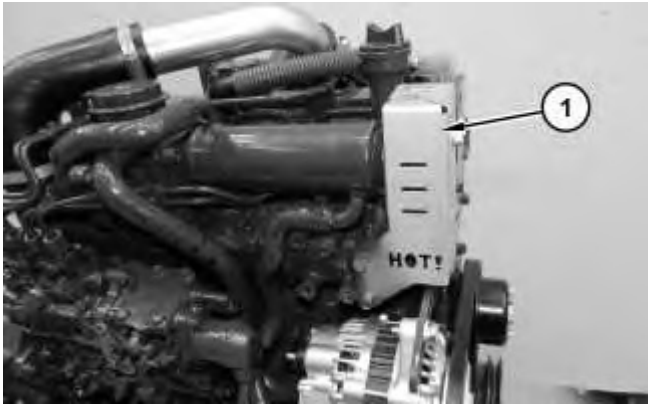

Illustration 1

g02824663

1. Drain coolant below exhaust gas recirculation valve level. Remove heat shield (1).

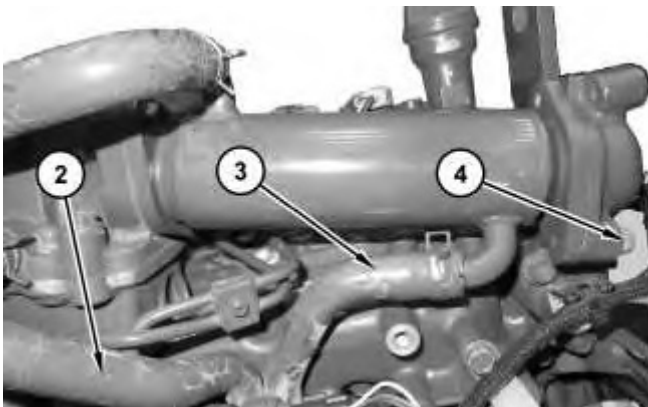

Illustration 2

g03337068

2. Disconnect hoses (2) and (3). Remove bolts (4).
-

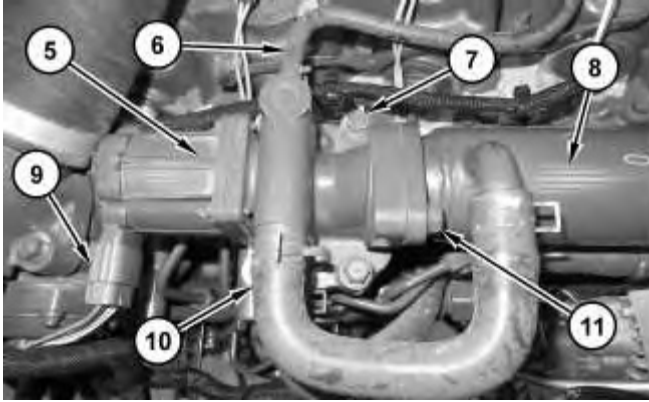

Illustration 3

g03366811

3. Disconnect harness assembly (9), hose (6) and (10). Remove bolts (11) and bolts (7). Remove exhaust gas recirculation valve (5) and cooler assembly (8).

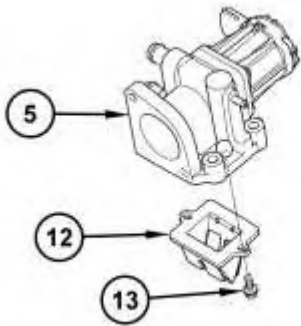

Illustration 4

g03366813

4. Remove screws (13) and reed valve (12) from exhaust gas recirculation valve (5).

Installation Procedure

1. Install exhaust gas recirculation valve (5) in the reverse order of removal.
 - a. Tighten bolts (4) and (11) to a torque of 24 to 27 N·m (212 to 239 lb in).
 - b. Tighten screws (13) to a torque of 10 to 11 N·m (89 to 97 lb in).
-

Thank you so much for reading.
Please click the “Buy Now!”
button below to download the
complete manual.



After you pay.

You can download the most
perfect and complete manual in
the world immediately.

Our support email:

ebooklibonline@outlook.com