

Product: MINI HYD EXCAVATOR

Model: 308E CR MINI HYD EXCAVATOR HEL

Configuration: 308E CR Mini Hydraulic Excavator HEL00001-UP (MACHINE) POWERED BY C3.3B Engine

Disassembly and Assembly 308ECR and 308ESR Mini Hydraulic Excavators Machine Systems

Media Number -UENR3284-03

Publication Date -01/12/2017

Date Updated -05/12/2017

i04988550

Final Drive and Travel Motor - Disassemble

SMCS - 4050-015; 4351-015

Disassembly Procedure

Table 1

Required Tools			
Tool	Part Number	Part Description	Qty
A	FT3209	Retainer Nut Wrench As.	1

Start By:

- A. Remove final drive and travel motor assembly.

NOTICE

Care must be taken to ensure that fluids are contained during performance of inspection, maintenance, testing, adjusting, and repair of the product. Be prepared to collect the fluid with suitable containers before opening any compartment or disassembling any component containing fluids.

Refer to Special Publication, NENG2500, "Dealer Service Tool Catalog" for tools and supplies suitable to collect and contain fluids on Cat products.

Dispose of all fluids according to local regulations and mandates.

NOTICE

Keep all parts clean from contaminants.

Contaminants may cause rapid wear and shortened component life.

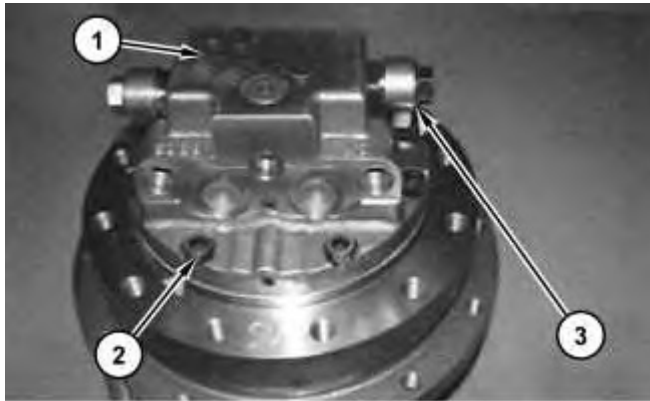

Illustration 1

g02992200

1. Remove relief valves (3) . Remove bolts (2) and remove motor cover (1) .

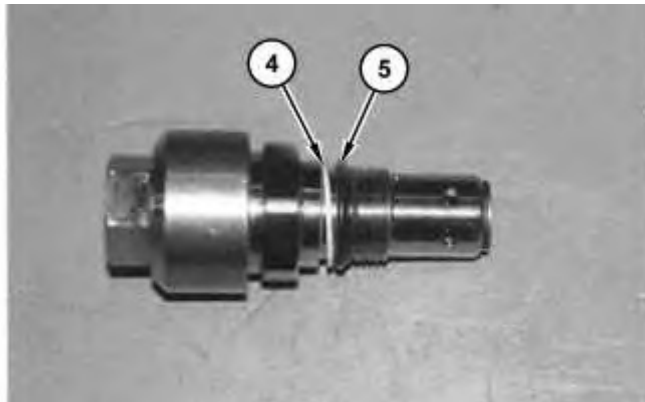

Illustration 2

g02992403

2. Remove backup ring (4) and O-ring seal (5) from relief valves (3) .
-

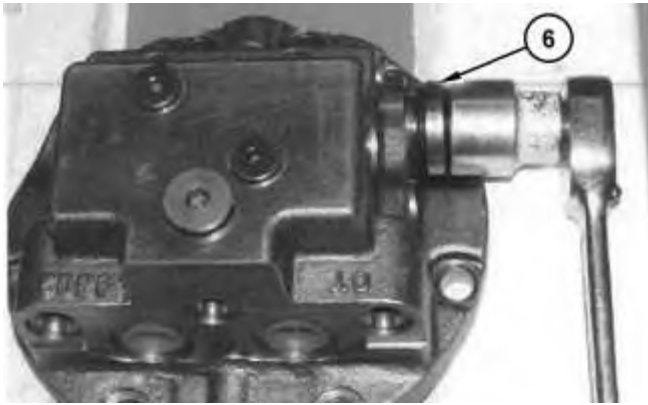

Illustration 3

g02992479

WARNING

Personal injury can result from being struck by parts propelled by a released spring force.

Make sure to wear all necessary protective equipment.

Follow the recommended procedure and use all recommended tooling to release the spring force.

3. Remove cover (6) . Repeat step on the opposite side of the motor cover.

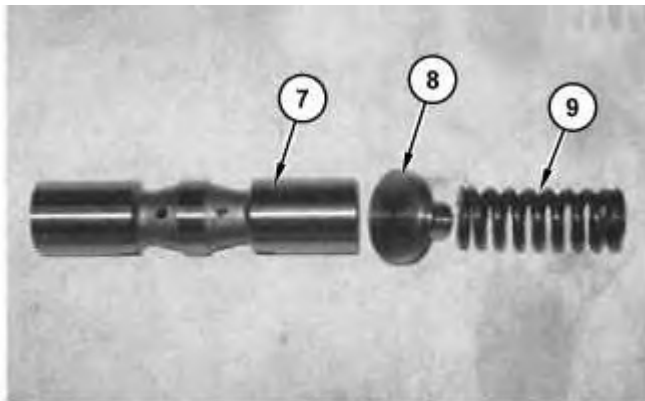

Illustration 4

g02992484

4. Remove spring (9) , pusher (8) and spool (7) from behind cover (6) .

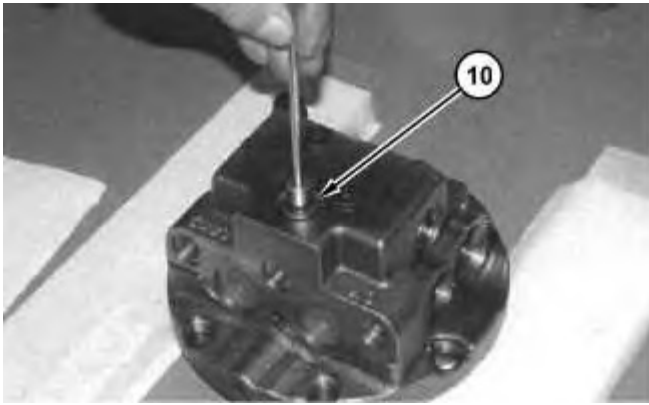

Illustration 5

g02992486

5. Remove plug (10) .

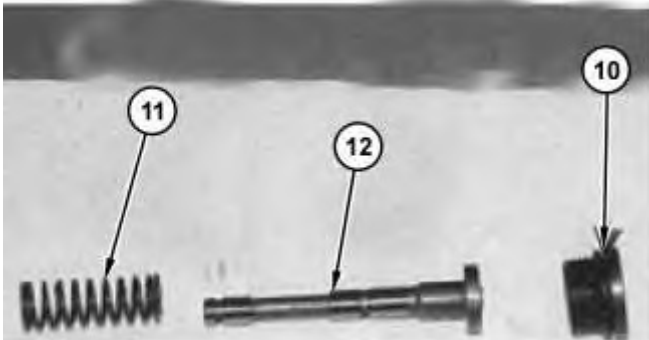

Illustration 6

g02993276

WARNING

Personal injury can result from being struck by parts propelled by a released spring force.

Make sure to wear all necessary protective equipment.

Follow the recommended procedure and use all recommended tooling to release the spring force.

6. Remove spring (11) , spool (12) from under plug (10) .



Suggest:

If the above button click is invalid.

Please download this document

first, and then click the above link

to download the complete manual.

Thank you so much for reading