

SERVICE MANUAL

L230

Tier 4B (final)

200 Series Skid Steer Loader

PIN NFM483191 and above

C238

Tier 4B (final)

200 Series Compact Track Loader

PIN NFM470756 and above

ENGINE - 10

POWER COUPLING - 19

FRONT AXLE SYSTEM - 25

REAR AXLE SYSTEM - 27

HYDROSTATIC DRIVE - 29

BRAKES AND CONTROLS - 33

Part number 47899776

1st edition English

June 2015



Engine - Drain fluid

C238 TIER 4B (FINAL) [NFM470756 -]	NA
L230 TIER 4B (FINAL) [NFM483191 -]	NA

1. Remove the access cover (2) by removing the mounting bolts (1).

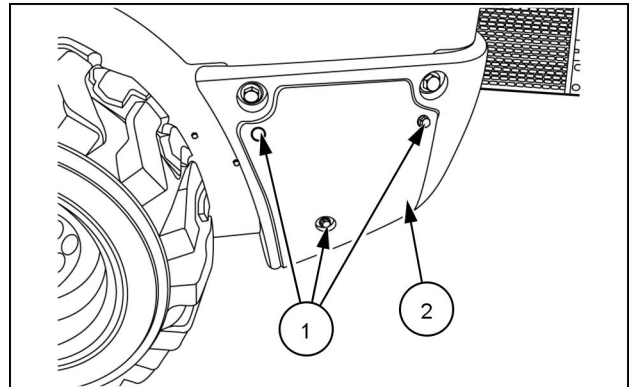

931001637 1

2. Remove the drain plug (1).
3. When the oil has drained from the engine, install the drain plug (1). Torque the drain plug (1) to **68 - 82 N·m (50 - 60 lb ft)**.

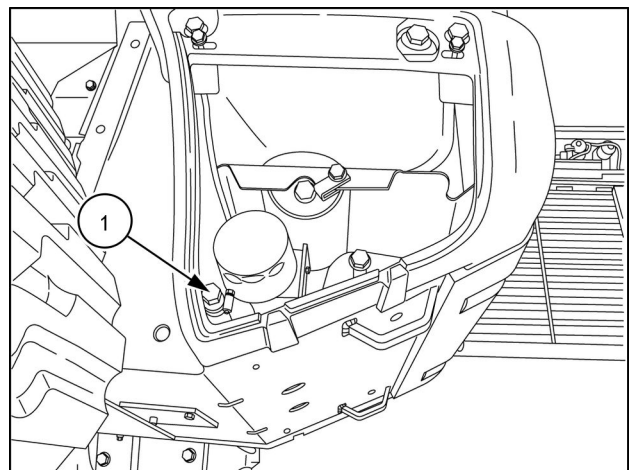

RAIL14SSL0709AA 2

4. Install the access cover (1).

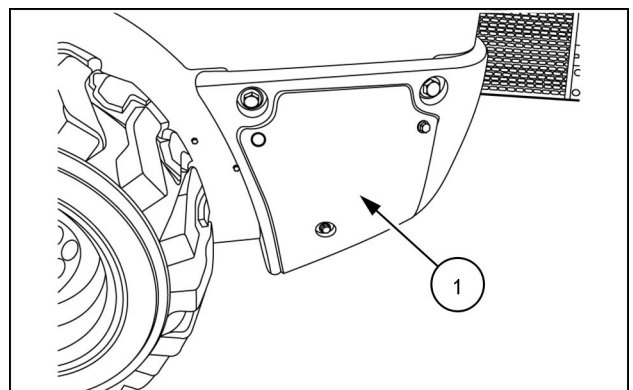

931001637 3

Engine - Remove

C238 TIER 4B (FINAL) [NFM470756 -]	NA
L230 TIER 4B (FINAL) [NFM483191 -]	NA

⚠ WARNING

Avoid injury! Always do the following before lubricating, maintaining, or servicing the machine.

1. Disengage all drives.
2. Engage parking brake.
3. Lower all attachments to the ground, or raise and engage all safety locks.
4. Shut off engine.
5. Remove key from key switch.
6. Switch off battery key, if installed.
7. Wait for all machine movement to stop.

Failure to comply could result in death or serious injury.

W0047A

⚠ WARNING

Fire hazard!

When handling diesel fuel, observe the following precautions:

1. Do not smoke.
2. Never fill the tank when the engine is running.
3. Wipe up spilled fuel immediately.

Failure to comply could result in death or serious injury.

W0099A

⚠ WARNING

Escaping fluid!

Hydraulic fluid or diesel fuel leaking under pressure can penetrate the skin and cause infection or other injury. To prevent personal injury: Relieve all pressure before disconnecting fluid lines or performing work on the hydraulic system. Before applying pressure, make sure all connections are tight and all components are in good condition. Never use your hand to check for suspected leaks under pressure. Use a piece of cardboard or wood for this purpose. If injured by leaking fluid, see your doctor immediately.

Failure to comply could result in death or serious injury.

W0178A

⚠ WARNING

Heavy objects!

Lift and handle all heavy components using lifting equipment with adequate capacity. Always support units or parts with suitable slings or hooks. Make sure the work area is clear of all bystanders.

Failure to comply could result in death or serious injury.

W0398A

Prior operation:

Tilt the ROPS.

Prior operation:

Disconnect the battery.

Prior operation:

Drain the coolant.

Prior operation:

Drain the engine oil.

Prior operation:

Evacuate the A/C system (if equipped).

1. Remove the access plate **(1)** for the engine oil pan from the rear of the chassis.

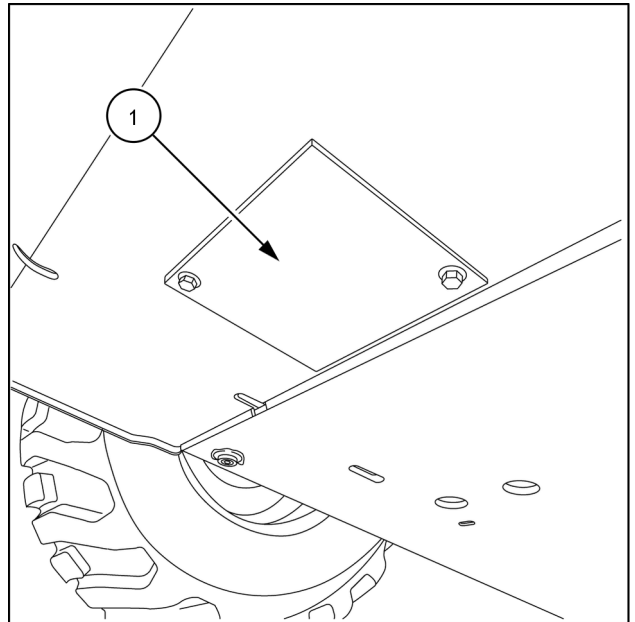

RAPH12SSL0233AA 1

2. Disconnect the hose **(1)** for the oil drain plug from the engine oil pan.

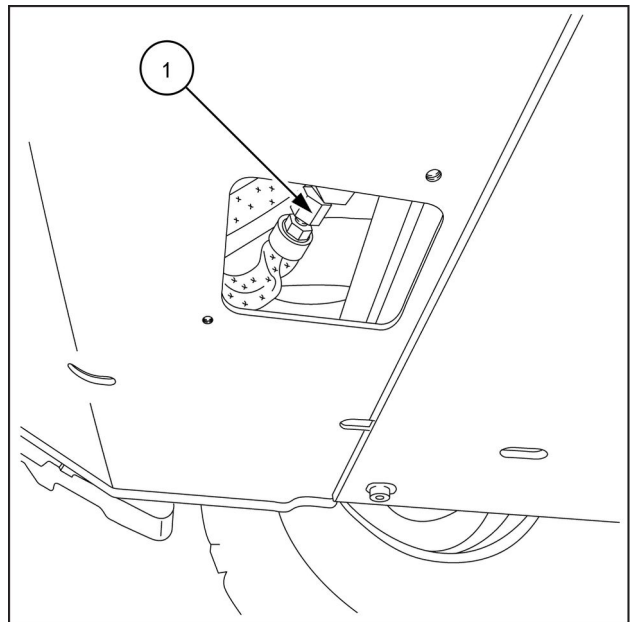

RAPH12SSL0232AA 2

3. Lift the tilting hood.
4. Disconnect the restriction sensor **(1)** for the air filter from the air cleaner assembly.
5. Detach the air cleaner assembly **(2)** from the rear deck.

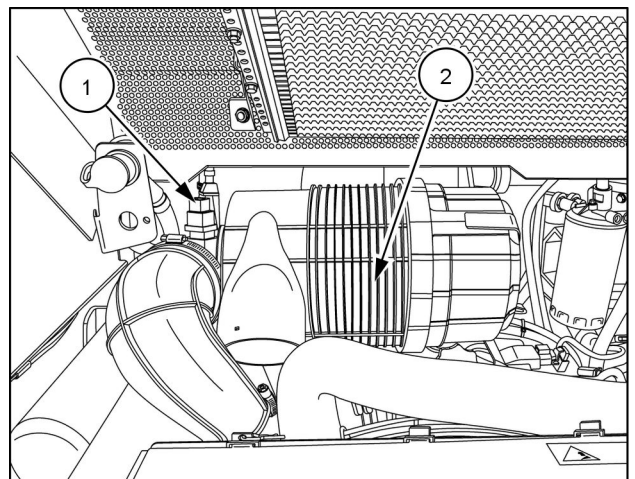

RAIL14SSL0803BA 3

6. If your machine is equipped with A/C, disconnect the lines **(1)** from the A/C condenser.
7. Disconnect the condenser fan **(2)**.

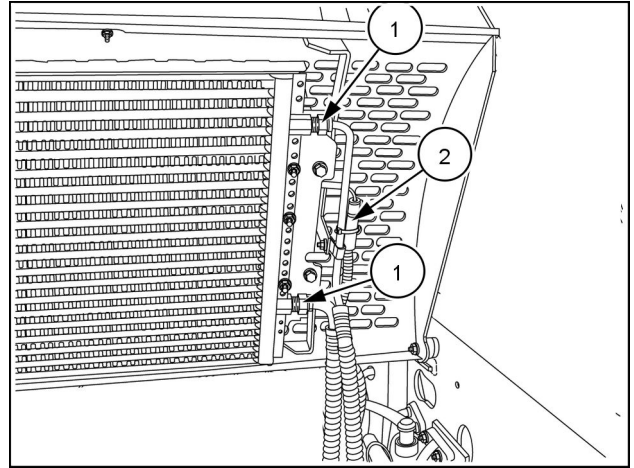

RAPH12SSL0075AA 4

8. Detach the hood strut **(2)** from the tilting hood **(1)**.
9. Remove the tilting hood **(1)** from the rear deck.

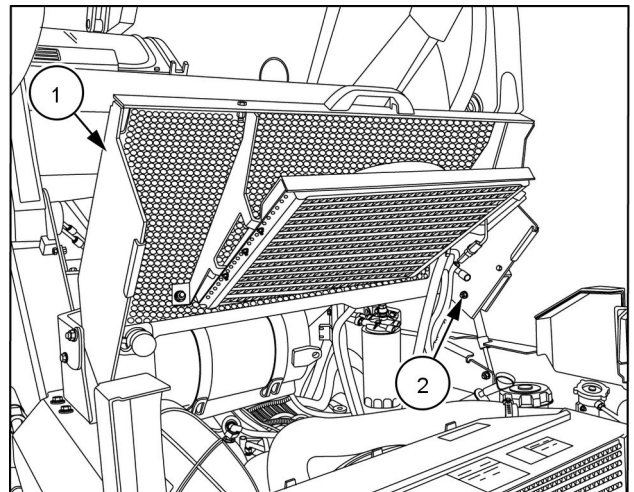

RAIL14SSL0802BA 5

10. Remove the left-hand panel **(1)** from the chassis.
11. Repeat step 10 on the right-hand panel.

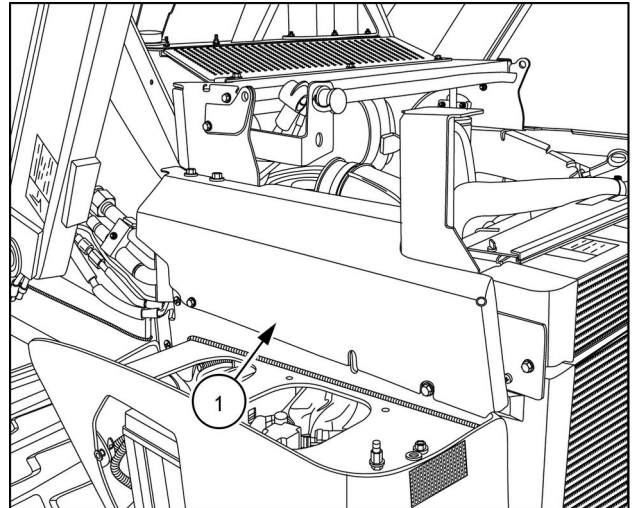

RAIL14SSL0801BA 6

12. Remove the rear deck (1) from the chassis.

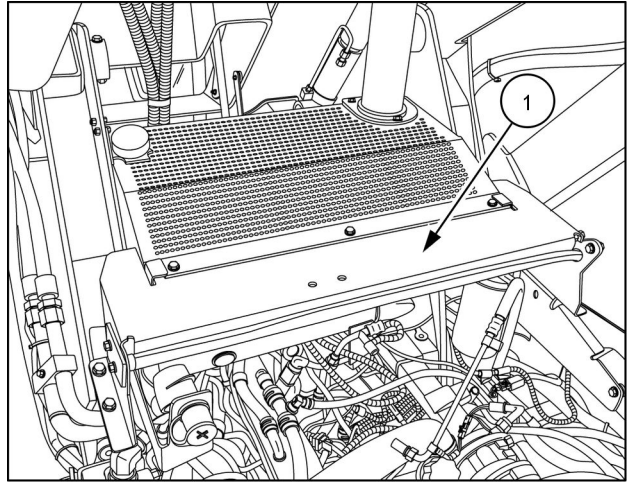

RAIL14SSL0800BA 7

13. Unbolt the retainer, and remove the overflow container.

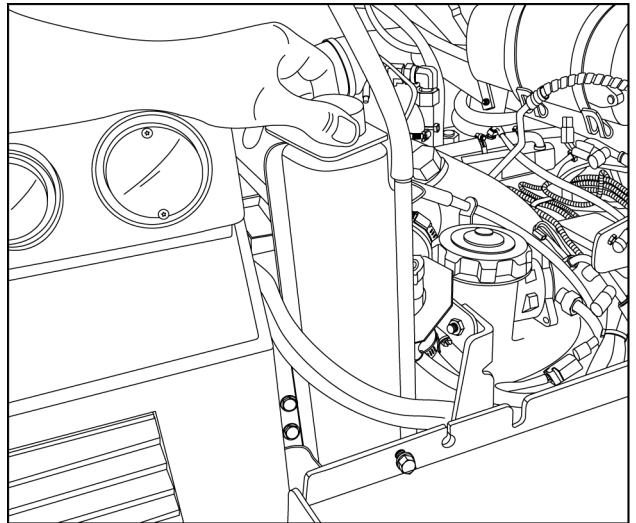

RAIL14SSL0799BA 8

14. Detach the mount (1) for the oil dipstick tube from the shroud.
15. Remove the hose (3) from the filler neck (2).
16. Remove the filler neck (2).

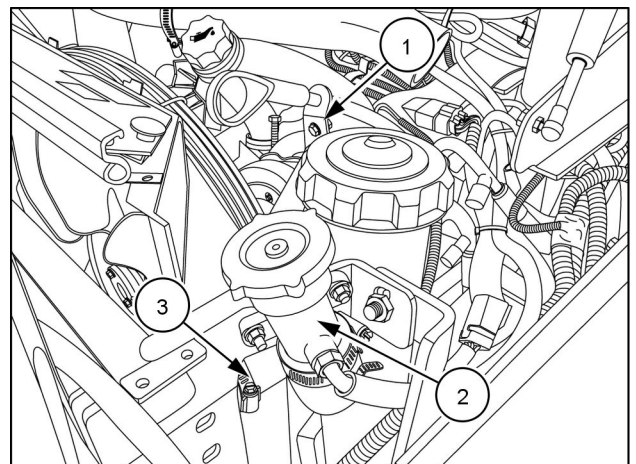

RAIL14SSL0796BA 9

Thank you so much for reading.
Please click the “Buy Now!”
button below to download the
complete manual.



After you pay.

You can download the most
perfect and complete manual in
the world immediately.

Our support email:

ebooklibonline@outlook.com